

**MARKHAM GATEWAY INC. ("MG") RESPONSES TO ENBRIDGE GAS
DISTRIBUTION INC. ("EGD") INTERROGATORIES OF JULY 5, 2013**

MG SUPPLEMENTARY RESPONSE TO EGD INTERROGATORY #1

Request:

b. Provide a detailed map identifying the areas referenced in Markham Gateway's evidence, including the "Richmond Hill/Langstaff Gateway Urban Growth Centre", the "company's lands" as well as the "Markham portion".

Response:

The requested map depicting the "company's lands" is attached.

TOWN OF MARKHAM
THE REGIONAL MUNICIPALITY OF YORK

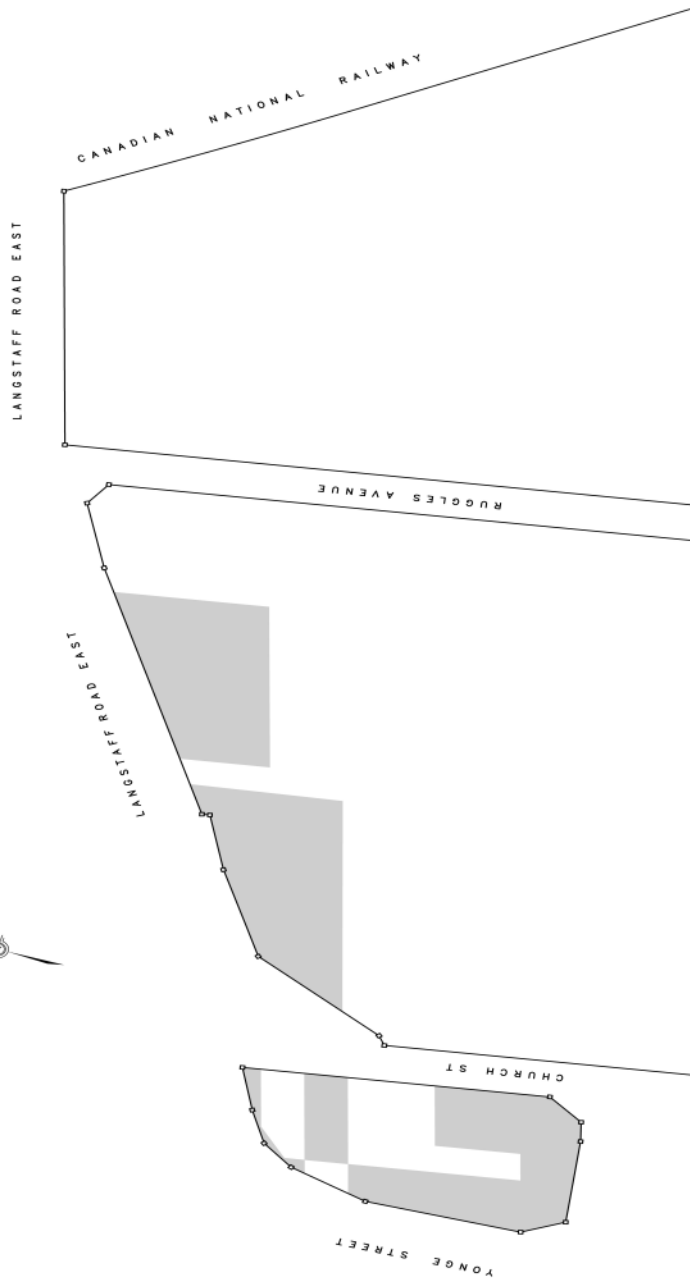

■ DENOTES GOVERNMENT OWNED LOTS, BALANCE OF LANDS OWNED BY CONDOR