



EB-2006-0305

**NOTICE OF APPLICATION
ENBRIDGE GAS DISTRIBUTION INC.**

**LEAVE TO CONSTRUCT FOR THE SUPPLY TO THE PORTLANDS
ENERGY CENTRE CONSISTING OF 6.5 KILOMETRES (NORTH
SECTION) AND 2.9 KILOMETRES (SOUTH SECTION)
OF NATURAL GAS PIPELINES AND ANCILLARY FACILITIES
IN THE CITY OF TORONTO**

Enbridge Gas Distribution Inc. (the "Applicant" or "Enbridge") has filed an application with the Ontario Energy Board, (the "Board") dated December 7, 2006, under section 90 of the *Ontario Energy Board Act, 1998*, S.O. 1998, c.15, Schedule B. The Applicant has applied for an order of the Board for leave to construct natural gas pipelines for the purpose of supplying gas to the already approved Portlands Energy Centre generating station ("PEC") in the City of Toronto.

The Applicant proposes to construct two sections of pipeline. The north section of pipeline consists of approximately 6.5 kilometers of 36 inch Nominal Size Pipe ("NPS") extra high pressure ("XHP") steel pipeline to parallel a portion of Enbridge's existing NPS 30 XHP Don Valley Line. The south section of pipeline consists of approximately 2.9 kilometers of NPS 20 XHP steel pipeline that would interconnect the Don Valley Line at Enbridge's Station B regulator station and would terminate at the PEC.

The Board has assigned File No. EB-2006-0305 to this application.

The north section of pipeline is proposed to originate north of Sheppard Avenue, between Warden Avenue to the west and Pharmacy Avenue to the east, proceed south for approximately 5.2 kilometers to just south of Wexford Park, cross to the east of the existing Enbridge NPS 30 pipeline and proceed southwest for approximately 1.3 kilometers to terminate in the vicinity of the existing Enbridge Jonesville Regulating Station. The north section route consists primarily of land in the former Hydro One

corridor currently owned by Enbridge (north of Sheppard Avenue to the north limit of Highway 401) and the Hydro One corridor presently owned by the Ontario Realty Corporation (from the south limit of Highway 401 to Eglinton Avenue).

The south section of pipeline is proposed to originate at Enbridge Regulator Station B located at 405 Eastern Avenue. The proposed route would proceed east along Eastern Avenue for 300 meters to Booth Avenue, turn south for 430 meters, proceed east along Lake Shore Boulevard for 80 meters to Logan Avenue, proceed along west side of Logan for about 350 meters, cross beneath Lake Shore Boulevard, run west for 210 meters at Commissioners Street to Bouchette Street and run south to Basin Street, continue south at Basin Street for 650 metres, run beneath Shipping Channel to Unwin Avenue, proceed east along Unwin Avenue for 530 metres, turn north for 160 metres and terminate at the future Enbridge meter station to be connected to the PEC. The majority of the south section route is on land located within road allowances with the exception of several locations owned by the City of Toronto Economic Development Corporation, the Toronto Port Authority and Ontario Power Generation Inc.

A map showing the location of the proposed pipelines is included with this Notice.

The construction of the proposed pipelines will allow the Applicant to meet the natural gas requirements of the PEC.

The Applicant proposes to start construction in the summer of 2007 and the planned in-service date for the project is February 2008 in time for the commissioning of the PEC.

How to see the Applicant's Pre-filed Evidence

Copies of the application and the pre-filed evidence in support of the application will be available for public inspection at the Board's offices, at the Enbridge Gas Distribution Inc. head office and at the offices of the affected municipality (addresses below).

How to Participate

You may participate in this proceeding in one of three ways:

You may send the Board a letter of comment. Your letter may include a request to make an oral presentation to the Board, and must be received by the Board no later than **30 days** from the publication date of this notice.

You may request observer status in order to receive documents issued by the Board in the proceeding. Your request must be made by letter received by the Board no later than **10 days** from the publication date of this notice.

You may request intervenor status if you wish to actively participate in the proceeding. Your request must be made by letter of intervention received no later than **10 days** from the publication date of this notice, or, if you have been served this notice personally, no later than **10 days** from the date of service. Your letter of intervention must include a description of how you are, or may be, affected by the proceeding; and if you represent a group, a description of the group and its membership. The Board may choose to hold either a written or an oral hearing. Your letter of intervention should indicate your preference for a written or oral hearing, and the reasons for that preference. The Board may order costs in this proceeding. You must indicate in your letter of intervention whether you expect to seek costs from the applicant and the grounds for your eligibility for costs. You must provide a copy of your letter of intervention to the applicant.

Need More Information?

Further information on how to participate may be obtained by visiting the Board's Web site at www.oeb.gov.on.ca or by calling our Consumer Relations Centre at 1-877-632-2727.

How to Contact Us

In responding to this notice please reference Board file number EB-2006-0305. It is also important that you provide your name, postal address, telephone number and, if available, an e-mail addresses and fax number. All communications should be directed to the attention of the Board Secretary at the address below, and be received no later than **4:45 p.m. on the required date**.

For your convenience, the Board accepts letters of comment by either post or e-mail. Our e-mail address is Boardsec@oeb.gov.on.ca. Please include the application file reference number in the subject line of your e-mail.

Letters of intervention must be sent to the Board by regular mail to the address below. Please remember that you must send a copy of your request for intervention to the Applicant at the address listed below.

IMPORTANT

IF YOU DO NOT REQUEST TO PARTICIPATE IN ACCORDANCE WITH THIS NOTICE, THE BOARD MAY PROCEED IN YOUR ABSENCE AND YOU WILL NOT BE ENTITLED TO ANY FURTHER NOTICE OF THESE PROCEEDINGS.

FURTHER, IF THE APPLICATION FOR LEAVE TO CONSTRUCT IS GRANTED, THE APPLICANT MAY SUBSEQUENTLY APPLY TO EXPROPRIATE LANDS FOR THE CONSTRUCTION OF THE PIPELINE IF NECESSARY.

Addresses

Ontario Energy Board
P.O. Box 2319
2300 Yonge Street, 27th Floor
Toronto ON M4P 1E4

Attention: Ms. Kirsten Walli
Board Secretary

Tel: 1-888-632-6273 (toll free)
Fax: 416 440-7656

The City of Toronto City Hall
100 Queen Street W, 2nd floor
Toronto ON M5H 2N2

Attention: Ms. Ulli Watkiss
City Clerk

Tel: 416 338-0338
Fax: 416 338-0685

Enbridge Gas Distribution Inc.
500 Consumers Road
Toronto ON M2J 1P8

Attention: Mr. Patrick Hoey
Director, Regulatory Affairs

Tel: 416 495-5555
Fax: 416 495-6072

Aird & Berlis
BCE Place, 181 Bay St.
Suite 1800, Box 754
Toronto ON M5J 2T9

Attention: Mr. Scott Stoll
Legal Counsel

Tel: 416 865-4703
Fax: 416 865-1515

DATED at Toronto, January 10, 2007

ONTARIO ENERGY BOARD

Original signed by

Peter H. O'Dell
Assistant Board Secretary

PROPOSED PIPELINE PROJECT TO SUPPLY GAS TO
PORTLANDS ENERGY CENTRE, CITY OF TORONTO

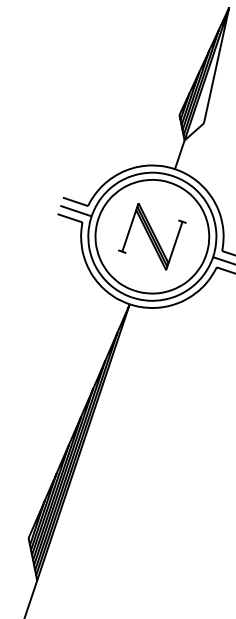

NORTH SECTION

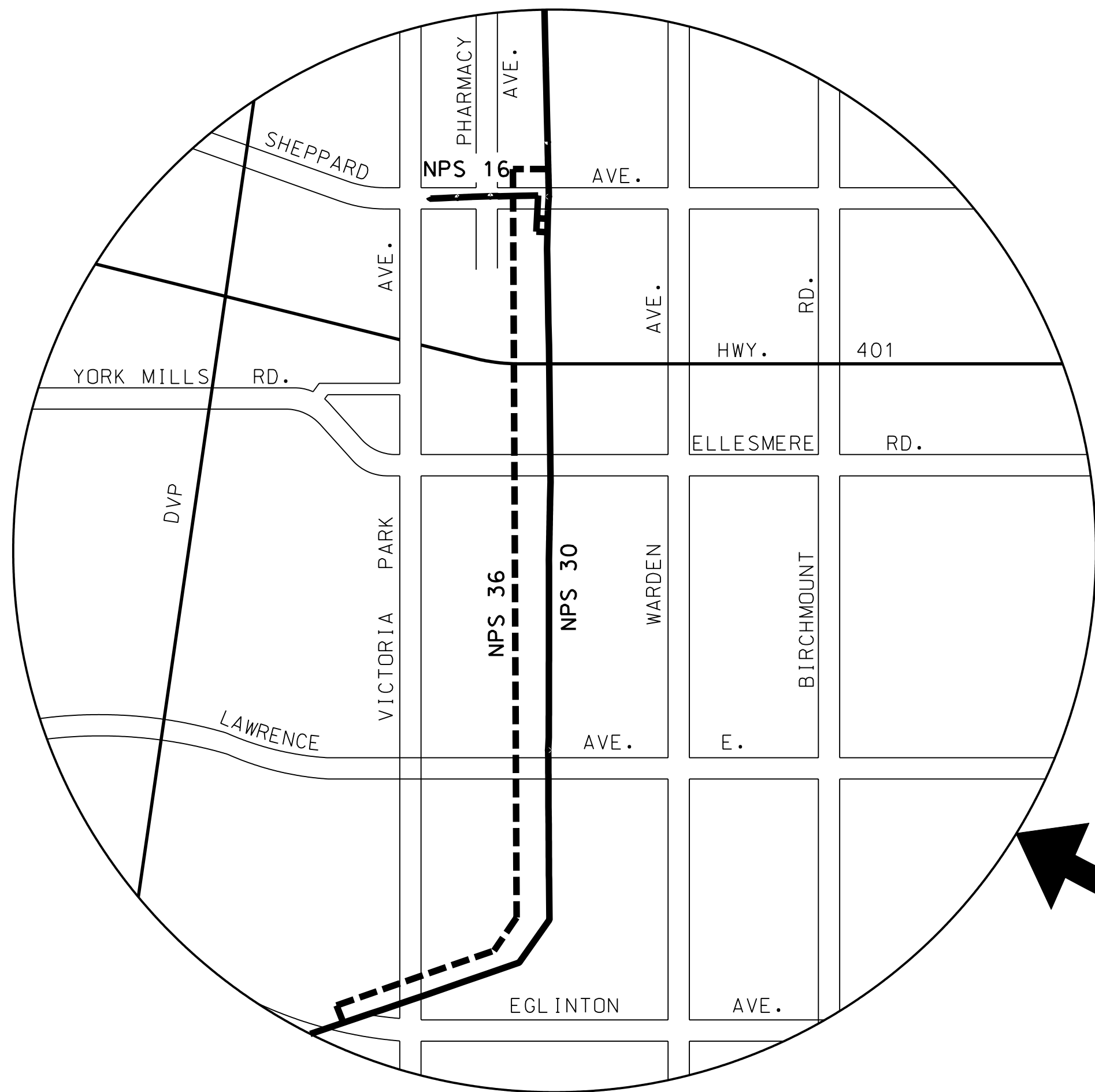

SOUTH SECTION

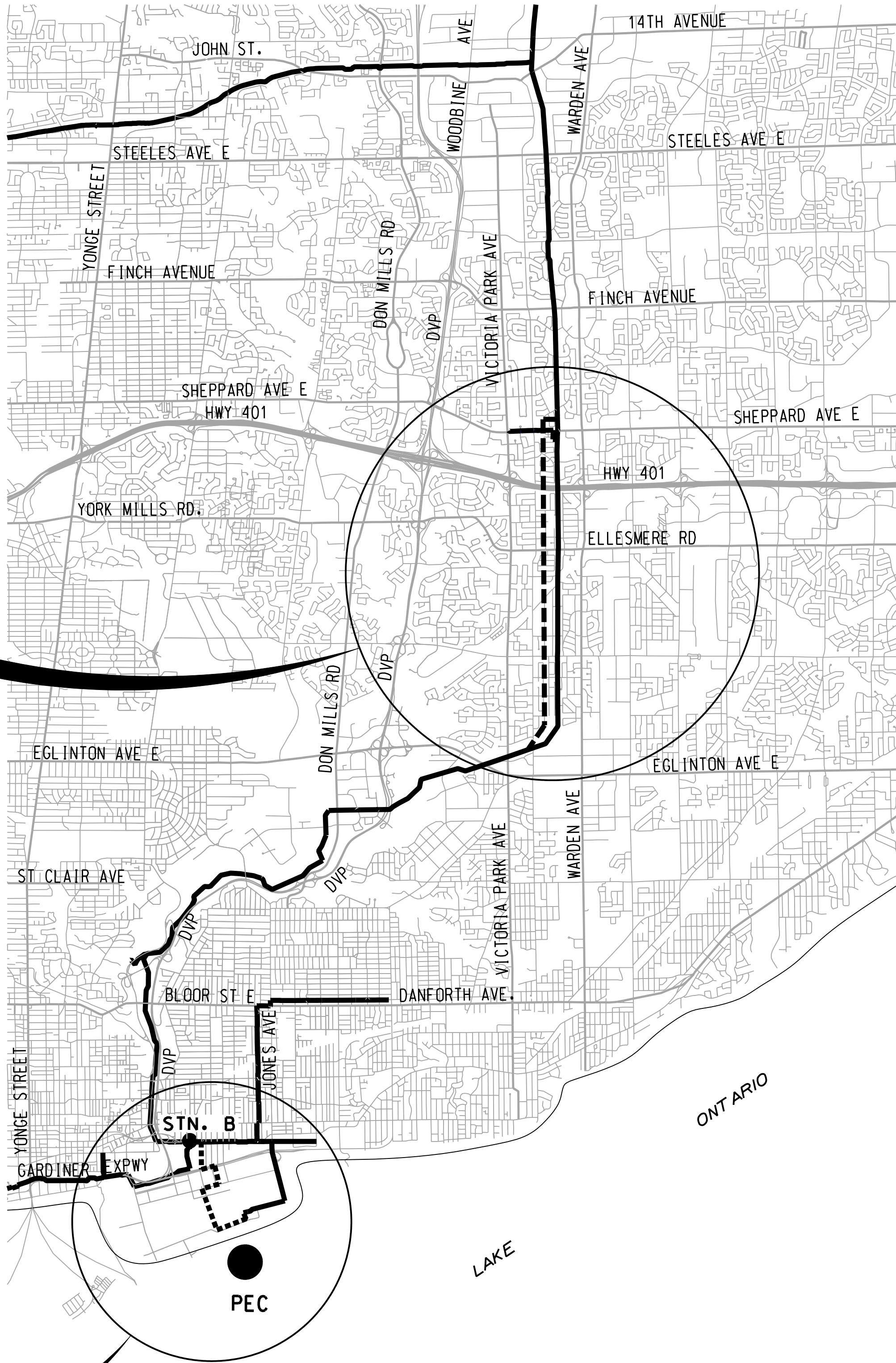
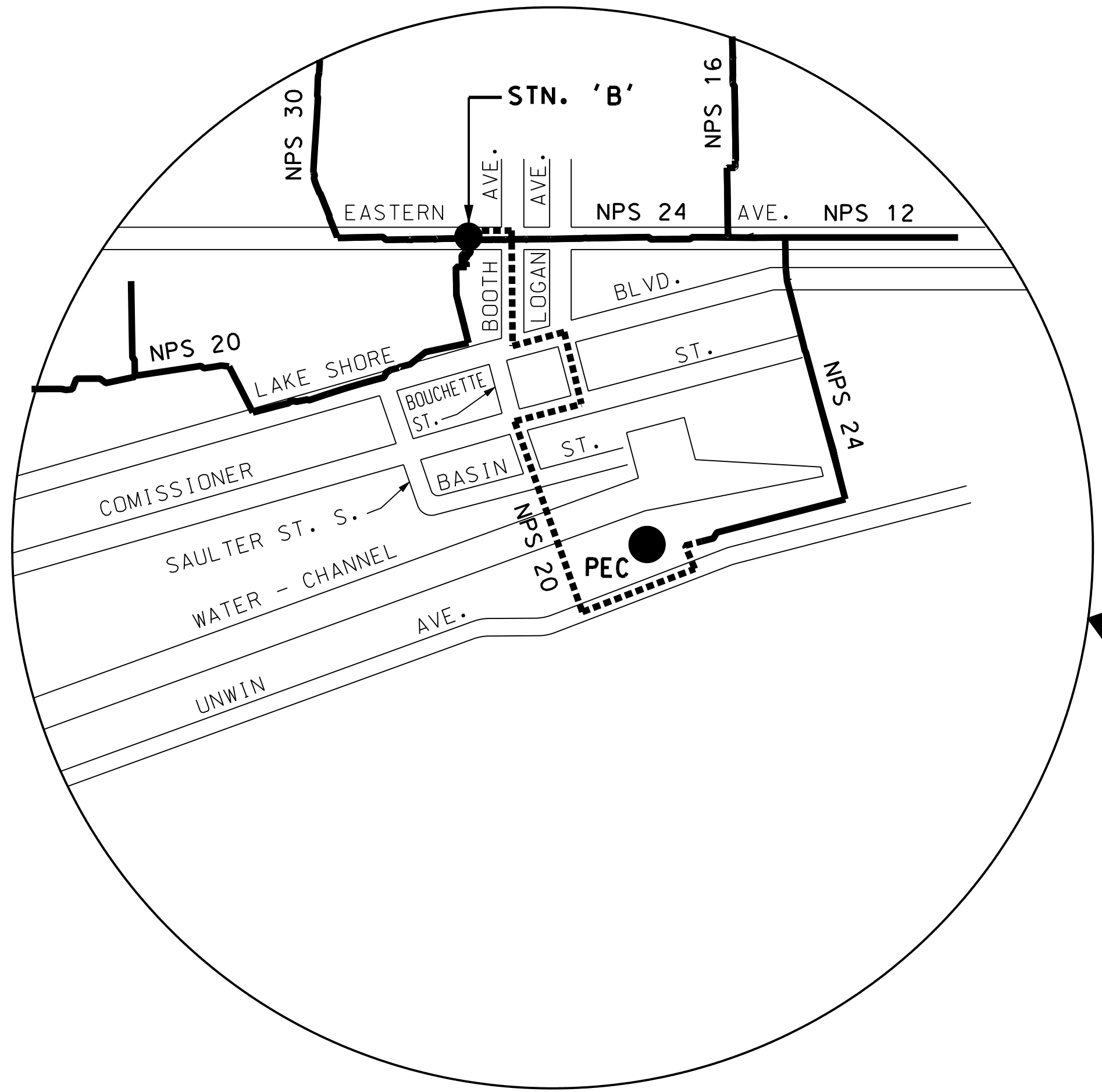

- LEGEND
- EXISTING GAS MAIN
 - PROP NPS 36
 - PROP NPS 20

