

**Hydro One Networks Inc.**

7<sup>th</sup> Floor, South Tower  
483 Bay Street  
Toronto, Ontario M5G 2P5  
www.HydroOne.com

Tel: (416) 345-5393  
Fax: (416) 345-5866  
Joanne.Richardson@HydroOne.com

**Joanne Richardson**

Director – Major Projects and Partnerships  
Regulatory Affairs



BY COURIER

August 11, 2016

Ms. Kirsten Walli  
Board Secretary  
Ontario Energy Board  
Suite 27, 2300 Yonge Street  
P.O. Box 2319  
Toronto, ON  
M4P 1E4

Dear Ms. Walli:

**Load Transfer Elimination Application – A Service Area Amendment & Asset Sale Application  
Between Hydro One Networks Inc. and Sioux Lookout Hydro Inc.**

In accordance with the Distribution System Code amendments of December 21, 2015, Hydro One Networks Inc. and Sioux Lookout Hydro Inc. are jointly applying to the Ontario Energy Board (“Board”) for approval to amend the service areas of both distributors such that all existing load transfer arrangements between the two LDCs are eliminated.

Should you have any questions on this application, please contact Pasquale Catalano at (416) 345-5405 or via email at [Pasquale.Catalano@HydroOne.com](mailto:Pasquale.Catalano@HydroOne.com).

Sincerely,

ORIGINAL SIGNED BY JOANNE RICHARDSON

Joanne Richardson

Attachment  
cc. Deanne Kulchyski



# **Ontario Energy Board**

**Elimination of Load Transfer Arrangements  
Between  
Hydro One Networks Inc. and Sioux Lookout  
Hydro Inc.**

**Combined Service Area Amendment and Asset  
Transfer Application**

**August 11, 2016**

## **PART I: SERVICE AREA AMENDMENT**

### **1.1 Basic Facts**

*As a result of the Distribution System Code amendments of December 21, 2015, EB-2015-0006, Hydro One Networks Inc. (“Hydro One”) and Sioux Lookout Hydro Inc. (“Sioux”) are jointly applying to the Ontario Energy Board (“OEB”) for approval to amend the service areas of Sioux such that all existing load transfer arrangements between the two LDCs are eliminated.*

### **1.2 Identification of the Parties**

#### **1.2.1 Applicant**

(Identify whether the applicant is a geographic and/or physical distributor)

Name of Applicant Hydro One Networks Inc.	Licence Number ED-2003-0043
Address 483 Bay Street, 7 <sup>th</sup> Floor, South Tower Toronto, ON M5G 2P5	Telephone Number 416-345-5405
	Facsimile Number 416-345-5866
	E-mail Address Regulatory@HydroOne.com
Contact Person Pasquale Catalano Regulatory Analyst	Telephone Number As listed above.
	Facsimile Number As listed above.
	E-mail Address Pasquale.Catalano@HydroOne.com

#### **1.2.2 Co-Applicant or Other Distributor to the Service Area Amendment Application**

Name of Co-Applicant or Other Distributor Sioux Lookout Hydro Inc.	Licence Number ED-2002-0514
Address: 25 Fifth Ave., PO Box 908 Sioux Lookout, ON P8T 1B3	Telephone Number 807-737-3800
	Facsimile Number 807-737-2832
	E-mail Address: slhydro@tbaytel.net
Contact Person: Deanne Kulchyski President/CEO	Telephone Number 807-737-3800
	Facsimile Number 807-737-2832
	E-mail Address dkulchyski@tbaytel.net

### 1.3 Description of Proposed Service Area

1.3.1	<p><b>Provide a detailed service area description of the area(s) that is subject to the SAA and how the amendments should be reflected in Schedule 1 of the licence(s) of the distributor(s).</b></p> <p>The proposed amendments are premise specific. Once the application is approved, all of the premises listed in Attachment 1 will be included in Sioux's licence, and removed from Hydro One's licence.</p>
1.3.2	<p><b>Provide maps or diagrams of the area(s) that is the subject of the SAA application.</b></p> <p>Please see Attachment 3.</p>
1.3.3	<p><b>Provide a description of the type of physical connection(s); i.e., individual customer; residential subdivision, commercial or industrial customer.</b></p> <p>38 Hydro One customers are proposed to be transferred to Sioux:</p> <ul style="list-style-type: none"><li>• 14 Residential Customers</li><li>• 9 General Service Customers</li><li>• 12 Seasonal Customers</li><li>• 3 Sentinel Light Accounts</li></ul>

### 1.4 Information on Affected Load Transfer Customers

1.4.1	<p><b>Provide a total number of load transfer arrangements between distributors.</b></p> <p>Please see 1.3.3.</p>
1.4.2	<p><b>Provide a number of load transfers eliminated in this application.</b></p> <p>Please see 1.3.3.</p>
1.4.3	<p><b>Provide a number of customers to be transferred from Hydro One to Sioux.</b></p> <p>Please see 1.3.3.</p>
1.4.4	<p><b>Provide a number of customers to be transferred from Sioux to Hydro One.</b></p> <p>There are no customers being transferred from Sioux to Hydro One</p>
1.4.5	<p><b>Provide a list of affected load transfer customers.</b> <b>(Customer listing must include customer address, name, billing address, rate class and meter number)</b></p> <p>Please see Attachment 1.</p>
1.4.6	<p><b>Provide written confirmation that all affected persons have been provided with specific and factual information about the service area amendment(s).</b></p> <p>Letter informing customers of the proposed amendments will be sent by Hydro One to their respective customers by August 12, 2016.</p>

## 1.5 Impacts Arising from the Amendment(s)

1.5.1	<p><b>Use the table below to describe the impact on the average residential customers' total bill that arises as a result of the service area amendment(s) before and after rate mitigation is applied. Use delivery charge on consumer's bill (including cost of losses and excluding all rate riders). Use 750 kWh / month for the average residential consumer. Provide any additional information as required.</b></p> <p>As part of this LTLT application, customers will be transferred from Hydro One to Sioux. There will be no transfer of customers from Sioux to Hydro One.</p> <p><b>1.5.1 Customers moving from Hydro One to Sioux</b></p> <p>As shown in Table 1, customers moving from Hydro One to Sioux will see a reduction in their monthly delivery charges. As such, no credits are required for these customers.</p> <p><b>Table 1: Bill Impacts at Typical Consumption Levels for Customers Moving from Hydro One Networks to Sioux Lookout Hydro (Rates effective May 1, 2016)</b></p> <table border="1"> <thead> <tr> <th rowspan="2">Monthly Consumption (kWh)</th><th colspan="4">Hydro One Networks</th><th colspan="4">Sioux Lookout Distribution</th><th rowspan="2">Average Monthly Delivery Impact on Total Bill (\$)</th></tr> <tr> <th>Rate Class</th><th>Fixed Charge (\$)</th><th>Variable Charge (\$/kWh or \$/kW)</th><th>Delivery Charge (\$)**</th><th>Rate Class</th><th>Fixed Charge (\$)</th><th>Variable Charge (\$/kWh or \$/kW)*</th><th>Delivery Charge (\$)**</th></tr> </thead> <tbody> <tr> <td>750</td><td>R2</td><td>41.36</td><td>0.0426</td><td>92.07</td><td>Res</td><td>31.23</td><td>0.0126</td><td>55.91</td><td>(36.16)</td></tr> <tr> <td>400</td><td>Seasonal</td><td>32.47</td><td>0.0748</td><td>72.14</td><td>Res</td><td>31.23</td><td>0.0126</td><td>44.76</td><td>(27.38)</td></tr> <tr> <td>2,000</td><td>GSe</td><td>27.94</td><td>0.0563</td><td>183.10</td><td>GS&lt;50</td><td>42.86</td><td>0.0112</td><td>101.94</td><td>(81.16)</td></tr> </tbody> </table> <p>* Includes low voltage charge  ** Includes RTSR charges and cost of losses.</p>	Monthly Consumption (kWh)	Hydro One Networks				Sioux Lookout Distribution				Average Monthly Delivery Impact on Total Bill (\$)	Rate Class	Fixed Charge (\$)	Variable Charge (\$/kWh or \$/kW)	Delivery Charge (\$)**	Rate Class	Fixed Charge (\$)	Variable Charge (\$/kWh or \$/kW)*	Delivery Charge (\$)**	750	R2	41.36	0.0426	92.07	Res	31.23	0.0126	55.91	(36.16)	400	Seasonal	32.47	0.0748	72.14	Res	31.23	0.0126	44.76	(27.38)	2,000	GSe	27.94	0.0563	183.10	GS<50	42.86	0.0112	101.94	(81.16)
Monthly Consumption (kWh)	Hydro One Networks				Sioux Lookout Distribution				Average Monthly Delivery Impact on Total Bill (\$)																																								
	Rate Class	Fixed Charge (\$)	Variable Charge (\$/kWh or \$/kW)	Delivery Charge (\$)**	Rate Class	Fixed Charge (\$)	Variable Charge (\$/kWh or \$/kW)*	Delivery Charge (\$)**																																									
750	R2	41.36	0.0426	92.07	Res	31.23	0.0126	55.91	(36.16)																																								
400	Seasonal	32.47	0.0748	72.14	Res	31.23	0.0126	44.76	(27.38)																																								
2,000	GSe	27.94	0.0563	183.10	GS<50	42.86	0.0112	101.94	(81.16)																																								
1.5.2	<p><b>Provide a description of any assets which may be stranded or become redundant after completion of the service area amendment(s). Please explain why these assets could not be transferred to the physical distributor.</b></p> <p>No assets will be stranded as a result of this amendment.</p>																																																
1.5.3	<p><b>Identify costs for stranded equipment that would need to be de-energized or removed.</b></p> <p>N/A – please see 1.5.2</p>																																																
1.5.4	<p><b>Identify any assets that will be transferred to and/or from the applicant(s). If an asset transfer is required, please complete Part II of the application form.</b></p> <p>Please see Part 2</p>																																																
1.5.5	<p><b>Include an estimate of the credit required for each customer to ensure there is not a negative impact on the total bill.</b></p> <p>There are no customers being transferred to Hydro One.</p>																																																

## **PART II:       TRANSFER OF ASSETS (S. 86(1)(b))**

### **2.1       Description of the Assets to Be Transferred**

2.1.1	<b>Provide a description of the assets that are the subject of the transaction. (Attach a detailed list of assets to be sold including value of assets)</b> See Attachment 1.
2.1.2	<b>Indicate where the assets are located – whether in the applicant’s service territory or in the recipient’s service territory (if applicable). Please include a map of the location.</b> The assets are located within the territory that will be transferred from the geographical distributor to the physical distributor, if the application is approved. Please see Attachment 3 for maps indicating the location of the assets.
2.1.3	<b>Indicate which distributor’s customers are currently served by the assets.</b> Currently the assets are being used to service the geographical distributor’s customers. Once the application is approved, the assets will continue to service the same customers they currently service. The customers will be transferred from the geographical distributor to the physical distributor.

### **2.2       Description of the Sale Transaction**

2.2.1	<b>The value of the assets to be transferred shall be determined based on net book value (NBV). Attach the details of the associated cash consideration to be given and received by each of the parties to the transaction.</b> Hydro One will sell the assets servicing the subject Geographical Customers to Sioux for \$147,841.98 plus applicable taxes. Please note that asset valuation was determined using the Load Transfer Asset Valuation Scenarios and Residual Value Tables provided by the OEB on March 30, 2016.  A detailed breakdown of the assets is included in Attachment 1.  There are no Customers or Assets to be transferred or sold to Hydro One.
2.2.2	<b>Will the transfer impact any other parties (e.g. joint users of poles) including any agreements with third parties? If yes, please specify how.</b>  Bell Canada is the only joint use partner on the poles subject to this sale. Bell Canada has granted Hydro One approval to sell the poles subject to this sale to Sioux, as required by the First Right of Refusal clause in the Hydro One-Bell Joint Use Agreement. The signed letter by Bell is included as Attachment 5.  Bell also owns some of the poles where Hydro One has wire, and these are being sold to Sioux. Sioux will have to work with Bell to establish permits in these areas.

### **PART III: CERTIFICATION AND ACNOWLEDGEMENT**

#### **Applicant**

I certify that the information contained in this application and in the documents provided are true and accurate.

Signature of Key Individual	Name and Title of Key Individual	Date
ORIGINAL SIGNED BY JOANNE RICHARDSON	Joanne Richardson Director - Major Projects and Partnerships, Regulatory Affairs	August 11, 2016

(Must be signed by a key individual. A key individual is one that is responsible for executing the following functions for the applicant: matters related to regulatory requirements and conduct, financial matters and technical matters. These key individuals may include the chief executive officer, the chief financial officer, other officers, directors or proprietors.)

#### **Co-Applicant (if applicable)**

I certify that the information contained in this application and in the documents provided are true and accurate.

Signature of Key Individual	Name and Title of Key Individual	Date
ORIGINAL SIGNED BY DEANNE KULCHYSKI	Deanne Kulchyski President/CEO Sioux Lookout Hydro Inc.	July 15, 2016

(Must be signed by a key individual. A key individual is one that is responsible for executing the following functions for the applicant: matters related to regulatory requirements and conduct, financial matters and technical matters. These key individuals may include the chief executive officer, the chief financial officer, other officers, directors or proprietors.)

**Geographical Distributor LTLT Customer and Asset Transfer Information**

Map #	Primary Customer Name	Service Address							Meter ID	Classificatio	Geographical
		Number	Street	City	Postal Code	Lot	Concession	Township			
2		#	MINNITAKI LDG RD	PICKEREL		LOT 3	CONCESSION 5		J2073250	Special #2	R2_2TR_RPP
3		28504	PICKEREL ST	PICKEREL					J2232283	Fig.14	GSE_2TRRPP
1		81	BALSAM RD	PICKEREL					J2480448	Special #1	S_2TR_RPP
1		77	BALSAM RD	PICKEREL					J2480449	Special #1	R2_TOU_RPP
1		61	BALSAM RD	PICKEREL					J2480450	Special #1	S_2TR_RPP
2		82	MINNITAKI RD	PICKEREL					J2480451	Special #2	S_2TR_RPP
1		188	MONIA RD	PICKEREL		LOT 4			J2480452	Special #1	S_2TR_RPP
1		200	MONIA RD	PICKEREL		LOT 5			J2480453	Special #1	S_2TR_RPP
1		184	MONIA RD	PICKEREL		LOT 3			J2480454	Special #1	S_2TR_RPP
2		#	MINNITAKI LDG RD	PICKEREL		LOT PT 3	CONCESSION 5		J2480457	Special #2	S_2TR_RPP
1		162	MONIA RD	PICKEREL		LOT 2			J2480501	Special #1	S_2TR_RPP
1		168	MONIA RD	PICKEREL					J2480503	Special #1	S_2TR_RPP
1		160	MONIA RD	PICKEREL		LOT 1			J2480512	Special #1	S_2TR_RPP
2		#	MINNITAKI LDG RD	PICKEREL		LOT 3	CONCESSION 5		J2480513	Special #2	S_2TR_RPP
1		120	MONIA RD	PICKEREL		LOT 1	CONC. 5		J2480514	Special #1	S_TOU_RPP
3		28504	PICKEREL ST	PICKEREL					J2480515	Fig.14	GSE_2TRRPP
2		#	MINNITAKI LDG RD	PICKEREL		LOT 3	CONCESSION 5		J2480630	Special #2	GSE_2TRRPP
2		#	MINNITAKI LDG RD	PICKEREL		LOT 3	CONCESSION 5		J2480631	Special #2	GSE_2TRRPP
5		3824	HWY 642	BENEDICKSON					J2789604	Special #4	R2_2TR_RPP
5		3816	HWY 642	BENEDICKSON					J2789607	Special #4	R2_2TR_RPP
2		#	MINNITAKI LDG RD	PICKEREL		LOT 3	CONCESSION 5		J2838129	Special #2	R2_2TR_RPP
1		120	MONIA RD	PICKEREL		LOT 1	CONC. 5		J2838130	Special #1	R2_2TR_RPP
4		#	ALCONA RD	BENEDICKSON		LOT	CONCESSION		J2838131	Special #3	R2_2TR_RPP
4		3760	KIRK LAKE RD	BENEDICKSON					J3011910	Special #3	GSE_2TRRPP
		140	MINNITAKI LDG RD						J3012086	Special #2	GSE_2TRRPP
5		3820	HWY 642	BENEDICKSON					J3012087	Special #4	R2_2TR_RPP
		#	MINNITAKI LDG RD	PICKEREL		LOT 2	CONCESSION 5		J3012088	Special #2	GSE_2TRRPP
2		#	MINNITAKI LDG RD	PICKEREL		LOT 3	CONCESSION 5		J3140820	Special #2	R2_2TR_RPP
5		3822	HWY 642	BENEDICKSON					J3235830	Special #4	R2_2TR_RPP
2		#	MINNITAKI LDG RD	PICKEREL		LOT 2	CONCESSION 5		J3246828	Special #2	R2_TOU_RPP
4		3760	ALCONA/KIRK LAKE RD	BENEDICKSON					J3517591	Special #3	R2_2TR_RPP
2		4804	HWY 72	PICKEREL					J3542123	Special #2	R2_2TR_RPP
2		5105	HWY 72	PICKEREL					J3552593	Special #2	GSE_TOURPP
2		5105	HWY 72	PICKEREL					J3552594	Special #2	GSE_TOURPP
4		0	ALCONA RD (KIRK)	BENEDICKSON		LOT	CONCESSION		J3601519	Special #3	R2_2TR_RPP



## MONIA RD & BALSAM RD

Summary of Assets to be Sold

Poles					
Quantity	Height	Age	Set	Residual Value	Total Asset Value
2	35	20	Earth Plus	\$649.00	\$1,298.00
			Earth Plus		\$0.00
<b>2</b>					<b>\$1,298.00</b>

Primary and Neutral - Wire					
Location	Line Length (m)	# of Phases	Total Length (m)	Price/metre	Total Asset Value
Monia Rd O/H	931	1	2048	\$3.00	\$6,144.60
				\$3.00	\$0.00
<b>Totals</b>	<b>931</b>		<b>2048</b>		<b>\$6,144.60</b>

Buss - Wire			
Location	# of Spans	Price/span	Total Asset Value
160 & 162	2	\$180.00	\$360.00
		\$180.00	\$0.00
		\$180.00	\$0.00
<b>Totals</b>	<b>2</b>		<b>\$360.00</b>

Secondary Services to Premise			
Figure #	Number of Premises	Price/Premise	Total Asset Value
6	7	\$150.00	\$1,050.00
14	4	\$0.00	\$0.00
			\$0.00
			\$0.00
			\$0.00
<b>Totals</b>			<b>\$1,050.00</b>

Transformers				
Quantity	Age	Size (KVA)	Residual Value	Total Asset Value
4	25	25	\$1,519.00	\$6,076.00
1	10	25	\$3,038.00	\$3,038.00
2	25	10	\$1,519.00	\$3,038.00
<b>7</b>				<b>\$12,152.00</b>

## HWY 72 & MINNITAKI RD

### Summary of Assets to be Sold

Poles					
Quantity	Height	Age	Set	Residual Value	Total Asset Value
1	50	1	Earth Plus	\$1,637.00	\$1,637.00
1	50	20	Earth Plus	\$1,002.00	\$1,002.00
1	45	16	Earth Plus	\$1,026.00	\$1,026.00
3	45	26	Earth Plus	\$725.00	\$2,175.00
2	45	33	Earth Plus	\$514.00	\$1,028.00
1	40	10	Earth Plus	\$1,046.00	\$1,046.00
1	40	21	Earth Plus	\$758.00	\$758.00
3	40	28	Earth Plus	\$574.00	\$1,722.00
1	40	29	Earth Plus	\$551.00	\$551.00
2	40	30	Earth Plus	\$523.00	\$1,046.00
3	40	35	Earth Plus	\$392.00	\$1,176.00
1	40	47	Earth Plus	\$78.00	\$78.00
1	35	47	Earth Plus	\$65.00	\$65.00
1	30	47	Earth Plus	\$64.00	\$64.00
<b>22</b>					<b>\$13,374.00</b>

Primary and Neutral - Wire					
Location	Line Length (m)	# of Phases	Total Length (m)	Price/metre	Total Asset Value
Pickeral Arms Camp	250	1	500	\$3.00	\$1,500.00
Primary line heading south from Hwy 72 just east of Pickeral Arms Camp	706	1	1,412	\$3.00	\$4,236.00
Hwy 72 - House 4804	706	1	1,412	\$3.00	\$4,236.00
Minnitaki Rd (Main Road)	3,767	1	7,534	\$3.00	\$22,602.00
Hwy 72	1,113	1	2,226	\$3.00	\$6,679.20
House 82 U/G primary	296	1	326	\$1.25	\$407.18
PIN 420640033 (Dennis Dumphy)	379	1	758	\$3.00	\$2,274.00
<b>Totals</b>	<b>5,586</b>		<b>11,172</b>		<b>\$41,934.38</b>

Buss - Wire			
Location (PIN)	# of Spans	Price/span	Total Asset Value
420640040	1	\$180.00	\$180.00
		\$180.00	\$0.00
		\$180.00	\$0.00
<b>Totals</b>	<b>1</b>		<b>\$180.00</b>

Secondary Services to Premise			
Figure #	Number of Premises	Price/Premise	Total Asset Value
5	3	\$80.00	\$240.00
6	8	\$150.00	\$1,200.00
14	2	\$0.00	\$0.00
16	1	\$0.00	\$0.00
<b>Totals</b>	<b>14</b>		<b>\$1,440.00</b>

Transformers				
Quantity	Age	Size (KVA)	Residual Value	Total Asset Value
2	25	50	\$1,819.00	\$3,638.00
1	20	50	\$2,425.00	\$2,425.00
3	30	25	\$1,013.00	\$3,039.00
1	15	25	\$2,531.00	\$2,531.00
1	30	15	\$1,013.00	\$1,013.00
1	25	15	\$1,519.00	\$1,519.00
1	10	10	\$3,038.00	\$3,038.00
1	15	25 U/G	\$3,844.00	\$3,844.00
				\$0.00
<b>11</b>				<b>\$21,047.00</b>

## KIRK LAKE RD & ALCONA RD

Summary of Assets to be Sold

Poles					
Quantity	Height	Age	Set	Residual Value	Total Asset Value
4	50	25	Earth Plus	\$1,637.00	\$6,548.00
3	45	25	Earth Plus	\$654.00	\$1,962.00
10	40	30	Earth Plus	\$523.00	\$5,230.00
8	40	25	Earth Plus	\$654.00	\$5,232.00
<b>25</b>					<b>\$18,972.00</b>

Primary and Neutral - Wire					
Location	Line Length (m)	# of Phases	Total Length (m)	Price/metre	Total Asset Value
Kirk Lake Rd/ Alcona Road	1,705	1	3,751	\$3.00	\$11,253.00
		1	0	\$3.00	\$0.00
		1	0	\$3.00	\$0.00
<b>Totals</b>	<b>1,705</b>		<b>3,751</b>		<b>\$11,253.00</b>

Buss - Wire			
Location (PIN)	# of Spans	Price/span	Total Asset Value
		\$180.00	\$0.00
		\$180.00	\$0.00
		\$180.00	\$0.00
<b>Totals</b>	<b>0</b>		<b>\$0.00</b>

Secondary Services to Premise			
Figure #	Number of Premises	Price/Premise	Total Asset Value
5	3	\$80.00	\$240.00
6	1	\$150.00	\$150.00
			\$0.00
			\$0.00
			\$0.00
<b>Totals</b>			<b>\$390.00</b>

Transformers				
Quantity	Age	Size (KVA)	Residual Value	Total Asset Value
2	25	25	\$1,519.00	\$3,038.00
1	30	25	\$1,013.00	\$1,013.00
				\$0.00
<b>3</b>				<b>\$4,051.00</b>

## HIGHWAY 624 - EAST OF KIRK LAKE ROAD

Summary of Assets to be Sold

Poles					
Quantity	Height	Age	Set	Residual Value	Total Asset Value
2	45	30	Earth Plus	\$605.00	\$1,210.00
1	45	29	Earth Plus	\$633.00	\$633.00
1	40	30	Earth Plus	\$523.00	\$523.00
1	40	29	Earth Plus	\$551.00	\$551.00
2	40	28	Earth Plus	\$574.00	\$1,148.00
<b>7</b>					<b>\$4,065.00</b>

Primary and Neutral - Wire					
Location	Line Length (m)	# of Phases	Total Length (m)	Price/metre	Total Asset Value
NEAR 3820 HIGHWAY 624	360	1	792	\$3.00	\$2,376.00
		1	0	\$3.00	\$0.00
		1	0	\$3.00	\$0.00
<b>Totals</b>	<b>360</b>		<b>792</b>		<b>\$2,376.00</b>

Buss - Wire			
Location (PIN)	# of Spans	Price/span	Total Asset Value
		\$180.00	\$0.00
		\$180.00	\$0.00
		\$180.00	\$0.00
<b>Totals</b>	<b>0</b>		<b>\$0.00</b>

Secondary Services to Premise			
Figure #	Number of Premises	Price/Premise	Total Asset Value
5	2	\$80.00	\$160.00
6	2	\$150.00	\$300.00
			\$0.00
			\$0.00
			\$0.00
<b>Totals</b>			<b>\$460.00</b>

Transformers				
Quantity	Age	Size (KVA)	Residual Value	Total Asset Value
4	30	25	\$1,013.00	\$4,052.00
				\$0.00
				\$0.00
<b>4</b>				<b>\$4,052.00</b>

	Figure #1	Figure #2	Figure #3	Figure #4	Figure #5	Figure #6	Figure #7	Figure #8	Figure #9	Figure #10	Figure #11	Figure #12	Figure #13	Figure #14	Figure #15	Figure #16	Primary Wire Line
Main Page	0	0	0	0	0	0	0	0	0	0	0	0	0	0	0	0	
Special Case #1						7								4			2048
Special Case #2					3	8								2		1	11,172
Special Case #3					3	1											3,751
Special Case #4					2	2											792
O/H	20	70	20	70		50		50		63		63					
U/G	63		63		63		63		63		63						
Primary								20	20				20		20		
Neutral								20	20				20		20		
Subtotal	0	0	0	0	8	18	0	0	0	0	0	0	0	8	0	1	17763.6
Total O/H	0	0	0	0	0	900	0	0	0	0	0	0	0	0	0	0	Total Secondary O/H (m) 1080
Total U/G	0	0	0	0	504	0	0	0	0	0	0	0	0	0	0	0	Total Secondary U/G (m) 504
Total Primary	0	0	0	0	0	0	0	0	0	0	0	0	0	0	0	0	Total Primary (m) 17763.6
Total Buss (m)	180																

<b>POLES</b>	30	35	40	45	50	55	Total
Main Page	0	0	0	0	0	0	0
Special Case #1		2					2
Special Case #2	1	1	12	6	2		22
Special Case #3			18	3	4		25
Special Case #4			4	3			7
<b>TOTAL</b>	<b>1</b>	<b>3</b>	<b>34</b>	<b>12</b>	<b>6</b>	<b>0</b>	<b>56</b>

<b>Transformers</b>	5	10	15	25	50	75	100	167	Total
Main Page		1							1
Special Case #1		2		5					7
Special Case #2		1	2	5	3				11
Special Case #3				3					3
Special Case #4				4					4
<b>TOTAL</b>	<b>0</b>	<b>4</b>	<b>2</b>	<b>17</b>	<b>3</b>	<b>0</b>	<b>0</b>	<b>0</b>	<b>26</b>
Sentinel Lights (Total)	3								

### ASSET SUMMARY

Poles	30	35	40	45	50	55	Total		
	1	3	34	12	6	0	56		
Transformers	5	10	15	25	50	75	100	167	Total
	0	4	2	17	3	0	0	0	26
Primary Wire (Metres)	17763.6								
Secondary O/H Wire (Metres)	1080								
Secondary U/G Wire (Metres)	504								
Current Transformers	29								
Sentinel Lights	3								
Easements	0								

## **Attachment 2**

### **Geographical Distributor (Sioux) LTLT Customer and Asset Transfer Information**

There are no customers being transferred to Hydro One. Page left blank.

# Hydro One Geographical LDC Maps for LTLT Elimination with

## Sioux Lookout Hydro as Physical LDC

### Maps Legend

#### Map Legend

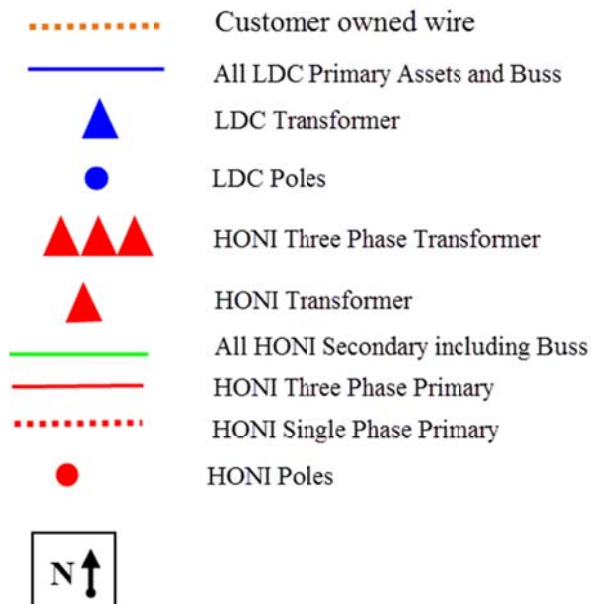

## MAPS

### Overview #1

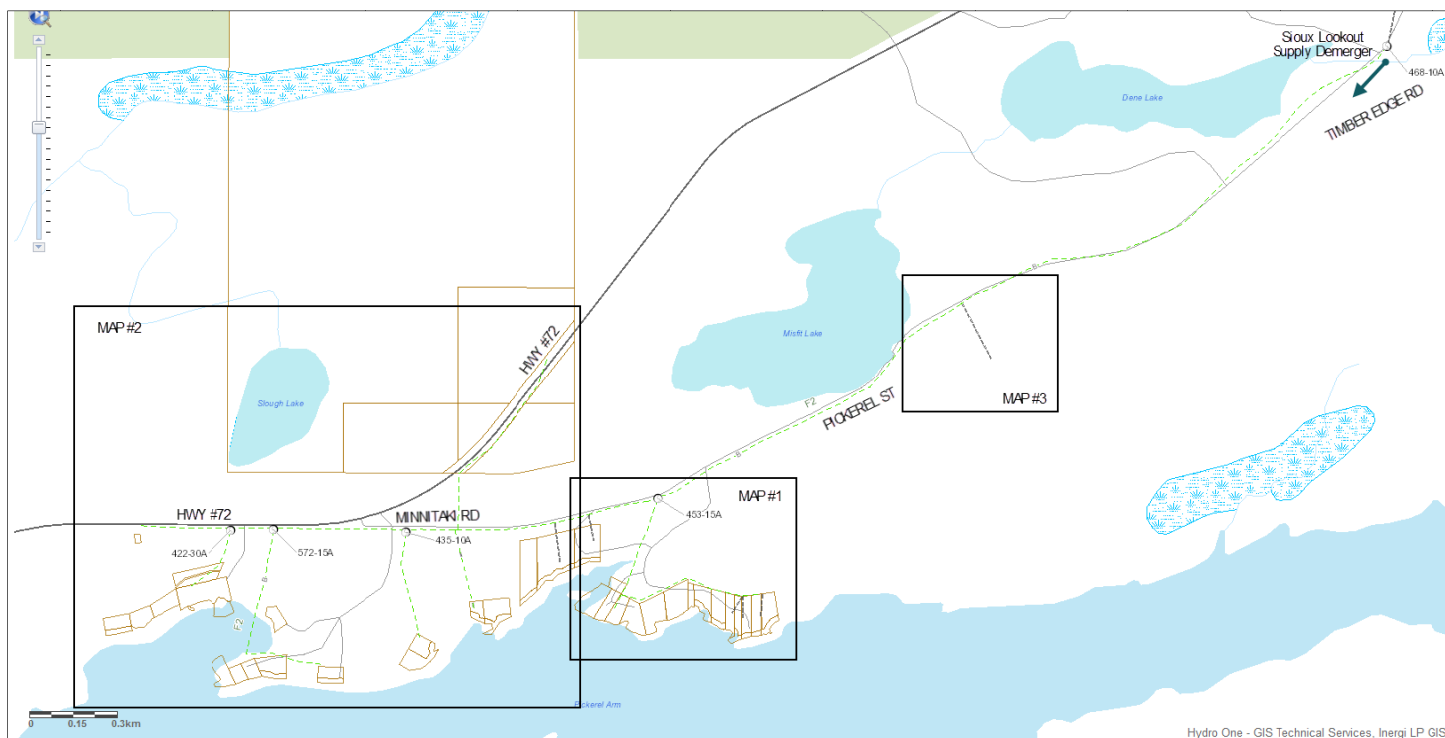

Map #1 - Special Case #1

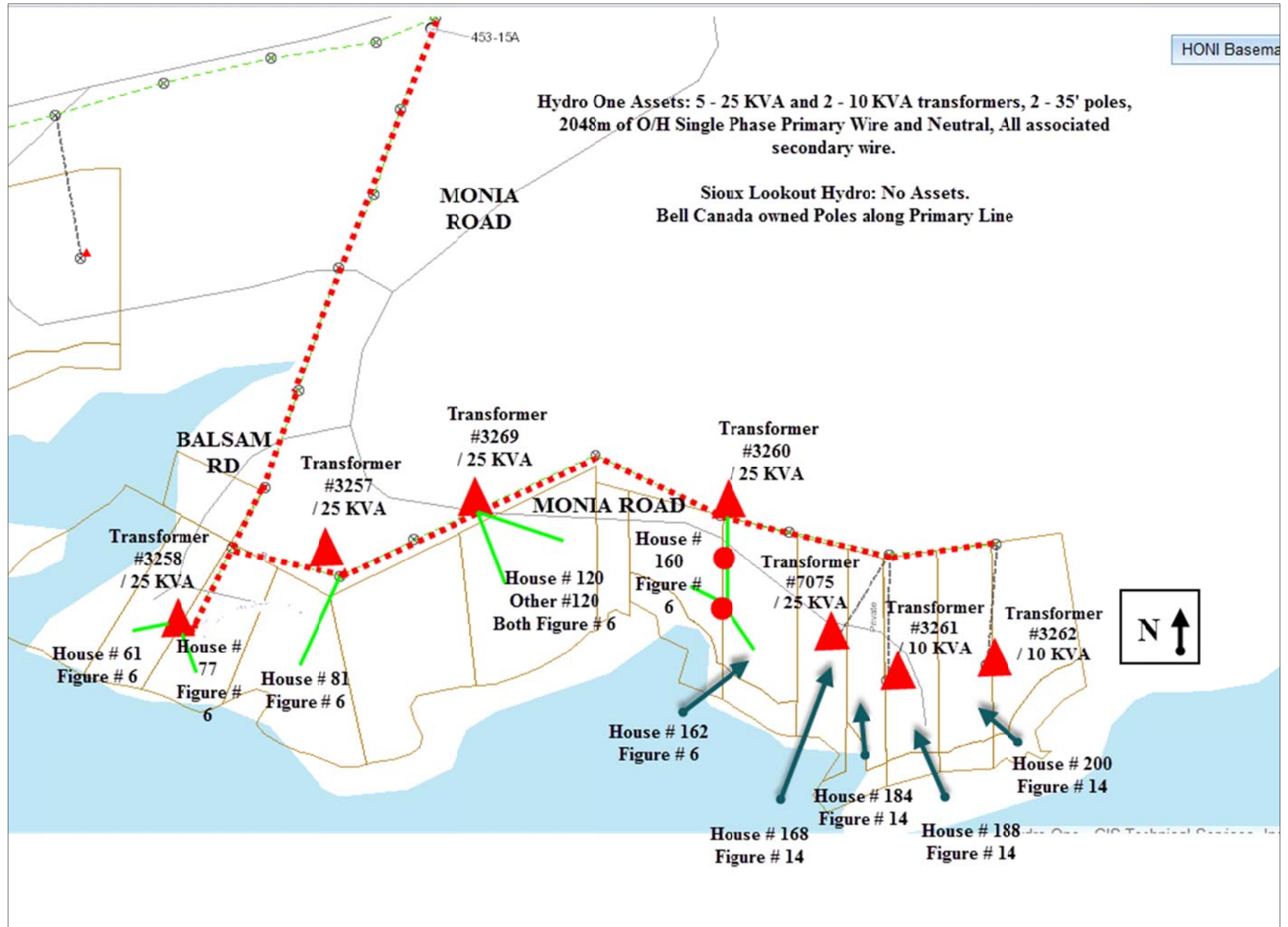



Map #2 - Special Case #2

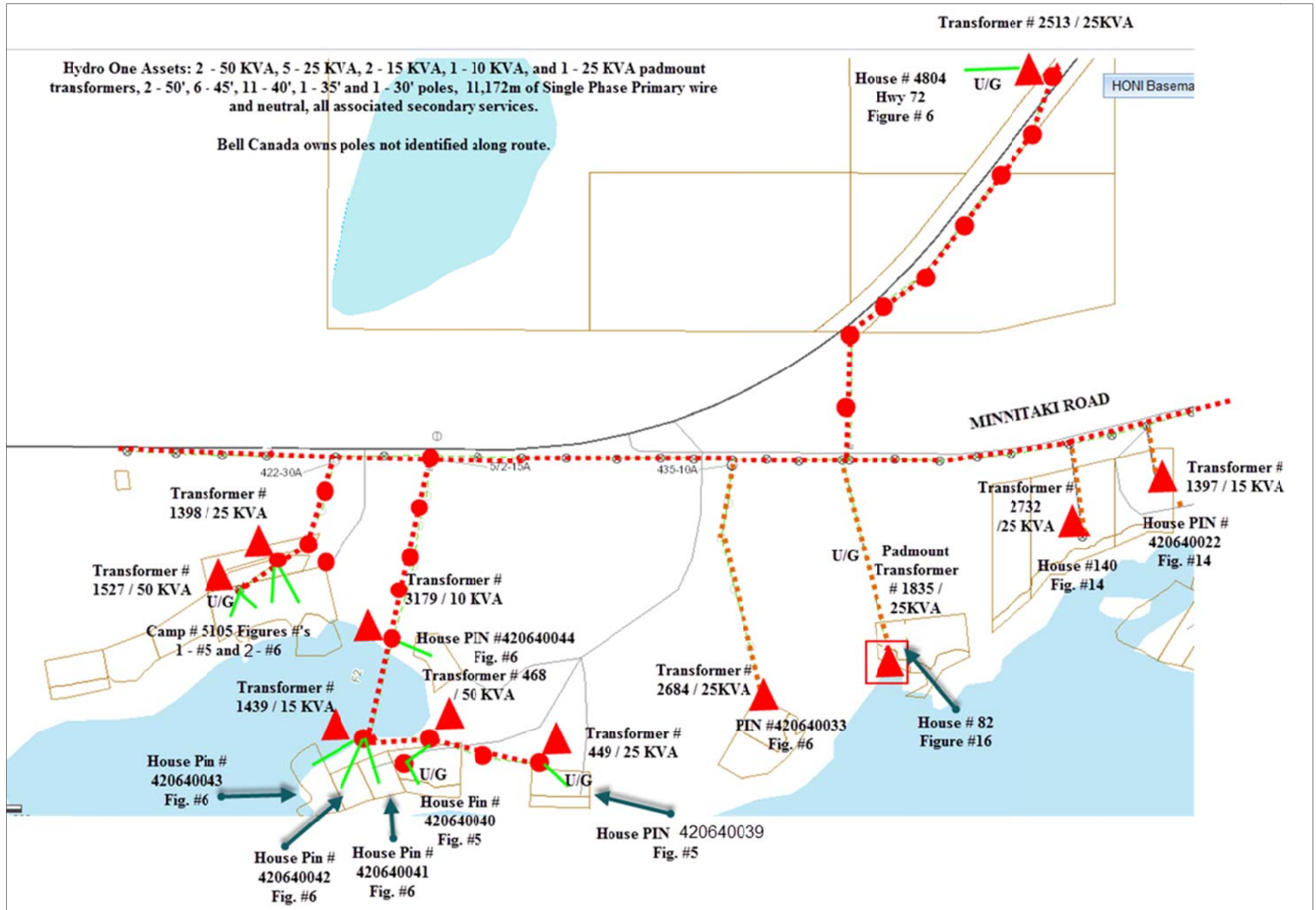

Map #3

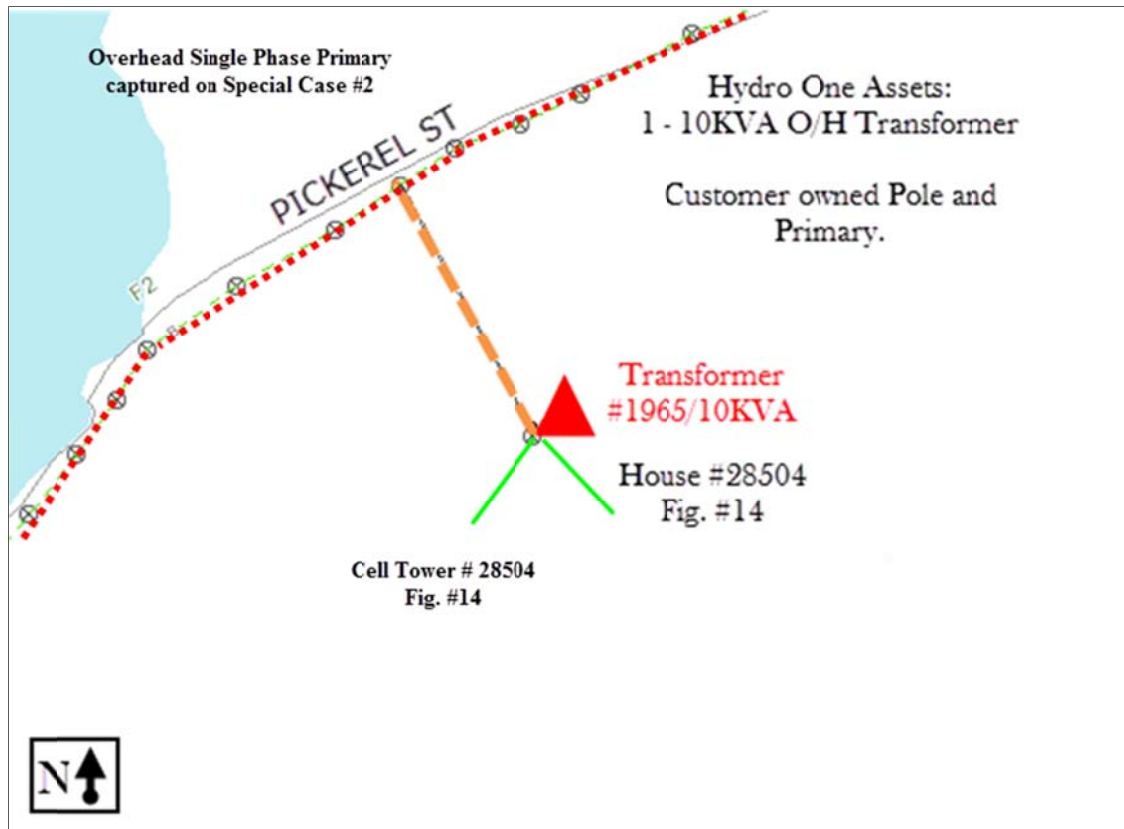

Overview #2

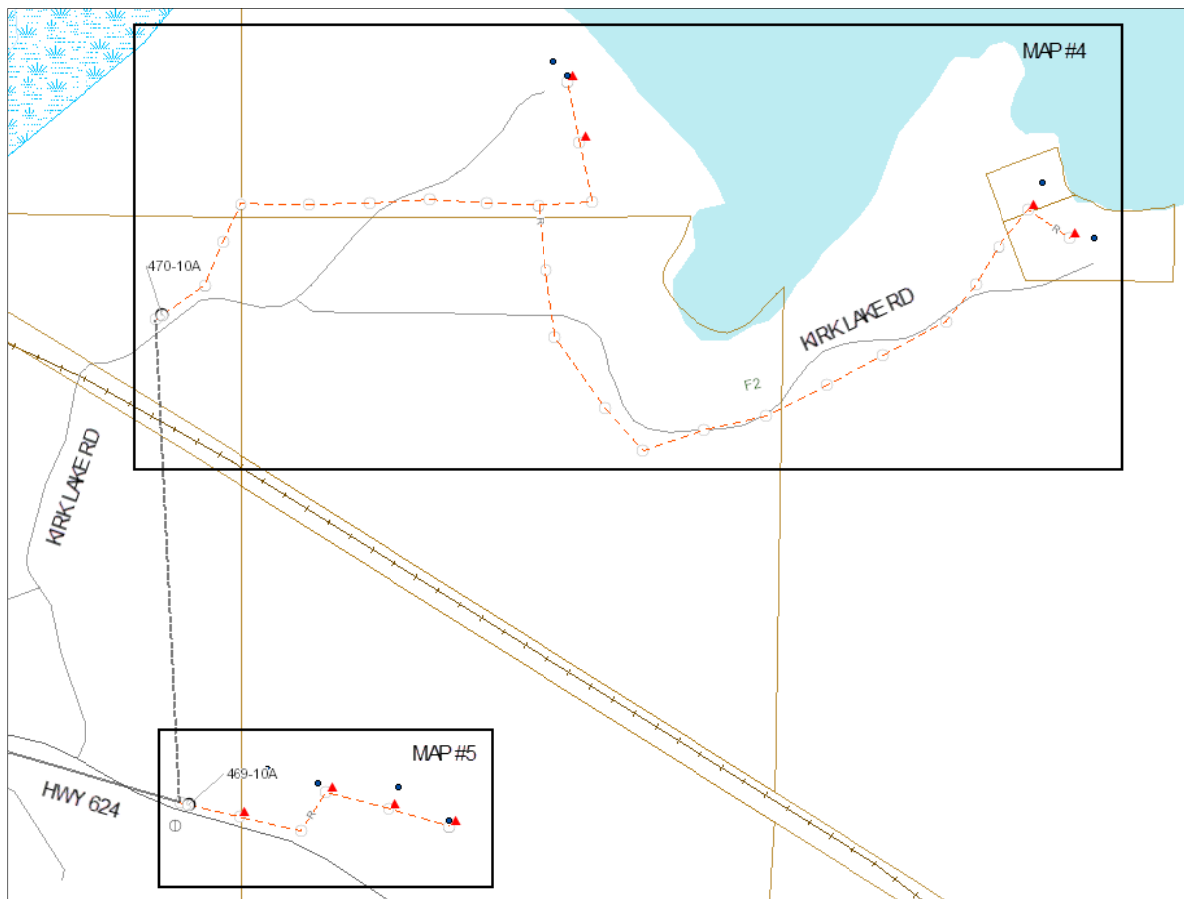

Map #4 - Special Case #3

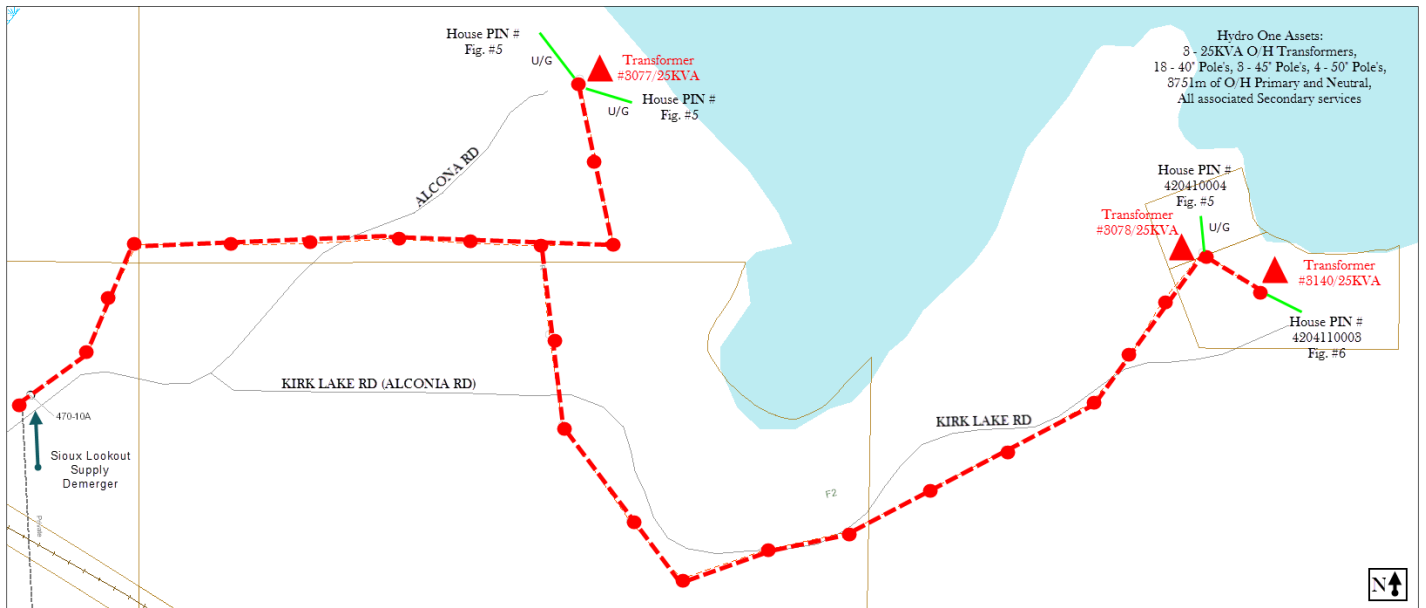

Map #5 - Special Case #4

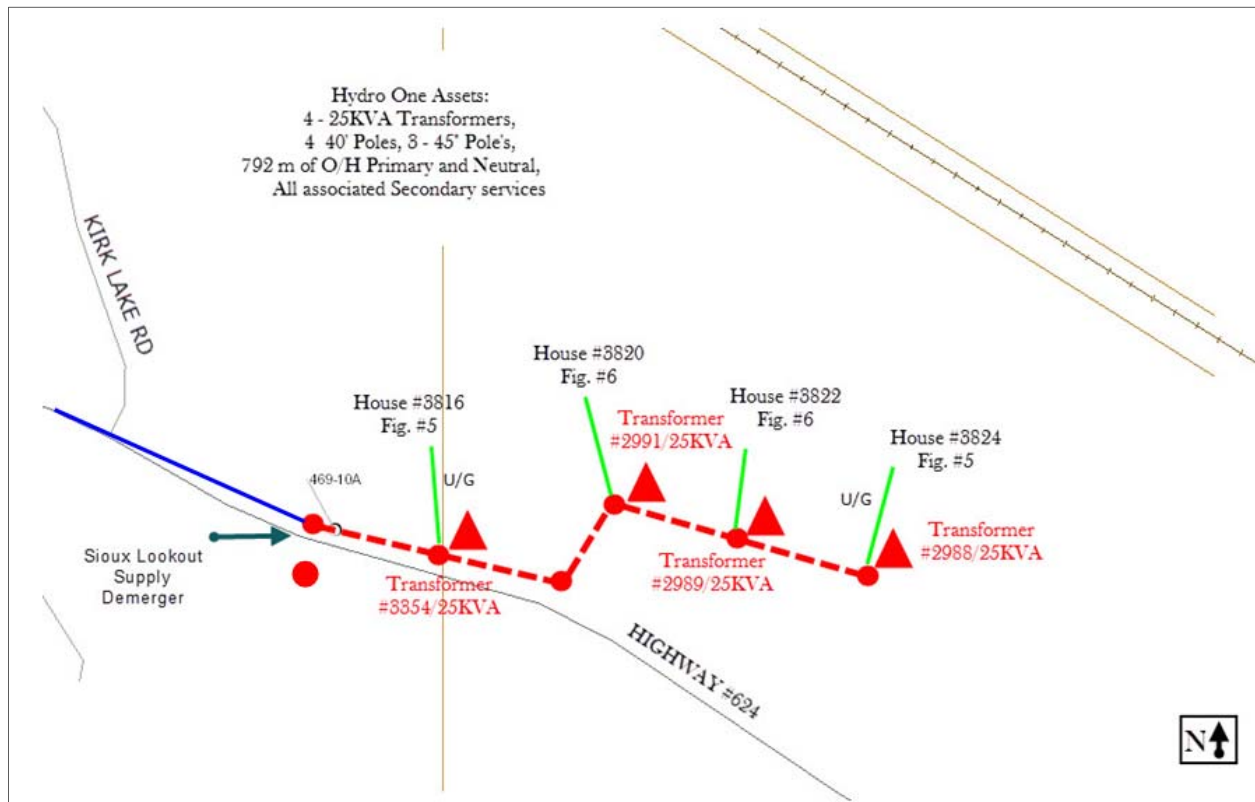

## **Attachment 4**

### **Geographical Distributor (Sioux) LDC Maps**

There are no customers being transferred to Hydro One. Page left blank.

**Hydro One Networks Inc.**  
185 Clegg Road  
Markham, ON L6G 1B7  
www.HydroOne.com

Tel: (888) 332-2249 x3214  
Fax: (905) 946-6215  
John.Boldt@hydroone.com



**John Boldt**  
Manager, Program Integration  
Distribution Development

**July 11, 2016**

**Bell Canada**  
**Floor 3 West Tower**  
**5115 Creekbank Road**  
**Mississauga, ON**  
**L4W 5R1**

**Attention: Tony Pereira – External Liaison**

**RE: SALE OF HYDRO ONE NETWORKS INC. JOINT USE POLES – SIOUX LOOKOUT – LTLT ELIMINATION**

This letter has been developed in respect to Hydro One Networks Inc. ("HONI") Joint Use Poles located in the area near Sioux Lookout, which are servicing HONI's Long Term Load Transfer (LTLT) customers and have Bell Canada attachments on them. HONI would like to sell these Joint Use Poles to a third party – Sioux Lookout Hydro Inc. within 3 months and as such, would like to receive Bell Canada's consent to the proposed sale pursuant to the provisions of the existing Agreement for the Joint Use Poles dated January 1, 2006 (the "Joint Use Agreement"). Please note that HONI intends to include as part of the transfer to the purchaser a condition that the purchaser agrees to continue to allow Bell Canada's attachments thereon for the remainder of the Initial Term (as this term is defined in the Joint Use Agreement).

The poles subject to this sale are associated with the elimination of long term load transfers ("LTLTs") in areas surrounding Sioux Lookout.

Please document your consent to the above-referenced proposed sale by no later than **July 22<sup>nd</sup>, 2016** by signing the form of acceptance at the end of this letter.

Should there be any further concerns, do not hesitate to contact me.

Sincerely;

ORIGINAL SIGNED BY JOHN BOLDT

John Boldt  
Manager Program Integration  
Hydro One Networks

The undersigned hereby consents to the sale by Hydro One Networks Inc. of Hydro One Networks Inc.'s Joint Use Poles identified above in this letter to a purchaser this 11<sup>th</sup> day of July, 2016.

Bell Canada

ORIGINAL SIGNED BY STUART MILLER

Name: STUART MILLER  
Title: A.W. Implementation mgr.  
I have authority to bind the corporation