

Hydro One Networks Inc.

7th Floor, South Tower
483 Bay Street
Toronto, Ontario M5G 2P5
www.HydroOne.com

Tel: (416) 345-5393
Fax: (416) 345-5866
Joanne.Richardson@HydroOne.com

Joanne Richardson

Director – Major Projects and Partnerships
Regulatory Affairs



BY COURIER

April 18, 2017

Ms. Kirsten Walli
Board Secretary
Ontario Energy Board
Suite 27, 2300 Yonge Street
P.O. Box 2319
Toronto, ON
M4P 1E4

Dear Ms. Walli:

**Load Transfer Elimination Application – A Service Area Amendment & Asset Sale Application
Between Hydro One Networks Inc. and Erie Thames Powerlines Corp.**

In accordance with the Distribution System Code amendments of December 21, 2015, Hydro One Networks Inc. and Erie Thames Powerlines Corp. are jointly applying to the Ontario Energy Board (“Board”) for approval to amend the service areas of both distributors such that existing load transfer arrangements between the two LDCs are eliminated.

Should you have any questions on this application, please contact Pasquale Catalano at (416) 345-5405 or via email at Pasquale.Catalano@HydroOne.com.

Sincerely,

ORIGINAL SIGNED BY JOANNE RICHARDSON

Joanne Richardson

Attachment
cc. Diane Taylor



Ontario Energy Board

Elimination of Load Transfer Arrangements Between Hydro One Networks Inc. and Erie Thames Powerlines Corporation

Combined Service Area Amendment and Asset Transfer Application

April 18, 2017

PART I: SERVICE AREA AMENDMENT

1.1 Basic Facts

As a result of the Distribution System Code amendments of December 21, 2015, EB-2015-0006, Hydro One Networks Inc. ("Hydro One") and Erie Thames Powerlines Corporation ("Erie Thames") are jointly applying to the Ontario Energy Board ("OEB") for approval to amend the service areas of both distributors such that existing load transfer arrangements between the two LDCs are eliminated.

1.2 Identification of the Parties

1.2.1 Applicant

(Identify whether the applicant is a geographic and/or physical distributor)

Name of Applicant Hydro One Networks Inc.	Licence Number ED-2003-0043
Address 483 Bay Street, 7 th Floor, South Tower Toronto, ON M5G 2P5	Telephone Number 416-345-5405
	Facsimile Number 416-345-5866
	E-mail Address: Regulatory@HydroOne.com
Contact Person Pasquale Catalano Regulatory Advisor	Telephone Number As listed above.
	Facsimile Number As listed above.
	E-mail Address: Pasquale.Catalano@HydroOne.com

1.2.2 Co-Applicant or Other Distributor to the Service Area Amendment Application

Name of Co-Applicant or Other Distributor Erie Thames Powerlines Corporation	Licence Number ED-2002-0516
Address: 143 Bell St. PO Box 157 Ingersoll, ON N5C 3K5	Telephone Number 519-485-1820
	Facsimile Number 519-485-4703
	E-mail Address: OEB@eriethamespower.com
Contact Person: Diane Taylor Regulatory and Accounting Analyst	Telephone Number 519-485-1820 ext 265
	Facsimile Number 519-485-4703
	E-mail Address OEB@eriethamespower.com

1.3 Description of Proposed Service Area

1.3.1	<p>Provide a detailed service area description of the area(s) that is subject to the SAA and how the amendments should be reflected in Schedule 1 of the licence(s) of the distributor(s).</p> <p>The proposed amendments are premise specific. Once this application is approved, Erie Thames' licence will include all of the premises in Attachment 1, and Hydro One's licence will include all of the premises in Attachment 2. The premises that are added to the distributor, will be removed from the other distributor's licence.</p> <p>Once the application is approved, the following changes to Hydro One's licence are required:</p> <p><u>To be amended in Schedule 1, Appendix B, Tab 4:</u></p> <p>Name of Municipality: Municipality of West Perth</p> <p>Formerly Known As: Township of Logan, Township of Fullarton, Township of Hibbert, Town of Mitchell, Police Village of Dublin, as at December 31, 1997.</p> <p>Area Not Served by Networks: The area served by Erie Thames Powerlines Corporation described as the former Town of Mitchell, the former Police Village of Dublin, and the Township of Logan as more particularly set out in Licence No. ED-2002-0516</p> <p>Networks assets within area not served by Networks: Yes</p> <p>Customer(s) within area not served by Networks: No</p> <p>Name of Municipality: Township of Zorra</p> <p>Formerly Known As: Township of West Zorra, Township of East Nissouri, Township of North Oxford, Village of Embro, Village of Thamesford, as at December 31, 1997.</p> <p>Area Not Served by Networks: The area served by Erie Thames Powerlines Corporation described as the former Village of Embro, the former Village of Thamesford, the former Township of West Zorra, and the former Township of North Oxford, as more particularly set out in Licence No. ED-2002-0516</p> <p>Networks assets within area not served by Networks: Yes</p> <p>Customer(s) within area not served by Networks: No</p> <p>Name of Municipality: Municipality of Central Elgin</p> <p>Formerly Known As: Township of Yarmouth, Village of Belmont, Village of Port Stanley, as at December 31, 1997.</p> <p>Area Not Served by Networks: The area served by Erie Thames Powerlines Corporation described as the former Villages of Belmont and Port Stanley, and the former Township of Yarmouth, as more particularly set out in Licence No. ED-2002-0516</p> <p>Networks assets within area not served by Networks: Yes</p> <p>Customer(s) within area not served by Networks: No</p> <p>Once the application is approved, Erie Thames' licence will be amended to state the following:</p> <p><u>To be amended in Schedule 1</u></p> <p>16. The Police Village of Dublin as of December 31, 1997, excluding 6959 Perth Line 34.</p> <p><u>To be added to Schedule 1</u></p> <p>The customers located at the following addresses in Zorra Township;</p> <ul style="list-style-type: none">a) 75, 83, 87, 91, 103, 109, 117, 125, 145, 147 North Town Line Eastb) 452, 454, 456, 458, 467 Haines Streetc) 603779, 603795 Cemetary Lane, Zorra Townshipd) 334490 Pemberton Street, Zorra Townshipe) 623788 Road 62, Zorra Townshipf) 11 Embro Street, Beachville, Zorra Townshipg) 78474 Road 78, Zorra Township <p>The customer located at 434696 West Hill Line, Beachville, Southwest Oxford Township</p>
-------	---

	<p>The customer located at the following premise address in the Municipality of Central Elgin:</p> <ul style="list-style-type: none"> a) 341 Borden Ave, Municipality of Central Elgin b) 45003 Taylor Line c) 591 Willsie Bourne Road <p>The customers located at the following premise address in the Municipality of West Perth:</p> <ul style="list-style-type: none"> a) 81 Frances Street, West Perth b) 7 Frances Street, West Perth
--	--

1.3.2	<p>Provide maps or diagrams of the area(s) that is the subject of the SAA application. Please see Attachments 3 and 4.</p>
1.3.3	<p>Provide a description of the type of physical connection(s); i.e., individual customer; residential subdivision, commercial or industrial customer. 61 Hydro One customers are proposed to be transferred to Erie Thames.</p> <ul style="list-style-type: none"> • 49 Residential Customers • 2 Seasonal Customers • 6 General Service Energy Customers • 2 General Service Demand Customers • 2 MicroFIT customers <p>7 Erie Thames Powerlines customers are proposed to be transferred to Hydro One.</p> <ul style="list-style-type: none"> • 4 Residential Customers • 3 General Service Energy Customers

1.4 Information on Affected Load Transfer Customers

1.4.1	<p>Provide a total number of load transfer arrangements between distributors. Section 1.3.3 addresses the majority of existing load transfer arrangements between the two distributors. Given that Erie Thames is an embedded LDC, there may be some load transfer arrangements that are not being addressed by this application.</p>
1.4.2	<p>Provide a number of load transfers eliminated in this application. Please see 1.3.3.</p>
1.4.3	<p>Provide a number of customers to be transferred from Hydro One to Erie Thames Please see 1.3.3.</p>
1.4.4	<p>Provide a number of customers to be transferred from Erie Thames to Hydro One. Please see 1.3.3.</p>
1.4.5	<p>Provide a list of affected load transfer customers. (Customer listing must include customer address, name, billing address, rate class and meter number) Please see Attachments 1 and 2.</p>
1.4.6	<p>Provide written confirmation that all affected persons have been provided with specific and factual information about the service area amendments. Letters informing the customers of the proposed amendment were sent by Erie Thames and Hydro One to their respective customers on April 13, 2017.</p>

1.5. Impacts Arising from the Amendment(s)

1.5.1

Use the table below to describe the impact on the average residential customers' total bill that arises as a result of the service area amendment(s) before and after rate mitigation is applied.
Use delivery charge on consumer's bill (including cost of losses and excluding all rate riders).
Use 750 kWh / month for the average residential consumer. Provide any additional information as required.

The delivery charges will increase for customers moving from Erie Thames to Hydro One. Table 1 shows the delivery and total bill impacts for these customers at typical consumption levels. Please note any change that may result from the Ontario government's Fair Hydro Plan is not included in the calculations below. Once the Fair Hydro Plan is finalized, the bill impacts will be recalculated accordingly.

Table 1: Bill Impacts at Typical Consumption Levels for Customers Moving from Erie Thames Powerlines Corporation (Rates effective May 1, 2017) to Hydro One Networks (Rates effective January 1, 2017)

Monthly Consumption (kWh)	Erie Thames Powerlines Corporation				Hydro One Networks				Average Monthly Delivery Impact on Total Bill (\$)
	Rate Class	Fixed Charge (\$)	Variable Charge (\$/kWh or \$/kW)*	Delivery Charge (\$) **	Rate Class	Fixed Charge (\$)	Variable Charge (\$/kWh or \$/kW)*	Delivery Charge (\$) **	
750	RES	23.22	0.0115	45.73	R2	19.83	0.0374	66.23	20.50
2,000	GS<50	22.29	0.0165	89.33	GSE	27.87	0.056	183.31	93.98

* Includes low voltage charge

** Includes RTSR charges and cost of losses.

As shown in Table 2, customers moving from Hydro One to Erie Thames will see a reduction in their monthly delivery charges. As such, no credits are required for these customers.

Table 2: Bill Impacts at Typical Consumption Levels for Customers Moving from Hydro One Networks (Rates effective January 1, 2017) to Erie Thames Powerlines Corporation (Rates effective May 1, 2017)

Monthly Consumption (kWh)	Hydro One Networks				Erie Thames Powerlines Corporation				Average Monthly Delivery Impact on Total Bill (\$)
	Rate Class	Fixed Charge (\$)	Variable Charge (\$/kWh or \$/kW)*	Delivery Charge (\$) **	Rate Class	Fixed Charge (\$)	Variable Charge (\$/kWh or \$/kW)*	Delivery Charge (\$) **	
750	R1	33.77	0.0230	67.12	RES	23.22	0.0115	45.73	(21.39)
750	R2	19.83	0.0374	66.23	RES	23.22	0.0115	45.73	(20.50)
2,000	GSE	27.87	0.0560	183.31	GS<50	22.29	0.0165	89.33	(93.98)
35,000	GSD	89.48	16.0236	2,304.49	GS 50 to 999	127.91	3.8123	1127.61	(1176.88)

* Includes low voltage charge

** Includes RTSR charges and cost of losses.

Unmetered customers

There is only one Sentinel Light account being transferred between Erie Thames and Hydro One for which no mitigation credit will be applied.

1.5.2	<p>Provide a description of any assets which may be stranded or become redundant after completion of the service area amendment(s). Please explain why these assets could not be transferred to the physical distributor.</p> <p>No assets will be stranded as a result of this application.</p>
1.5.3	<p>Identify costs for stranded equipment that would need to be de-energized or removed.</p> <p>N/A – please see 1.5.2.</p>
1.5.4	<p>Identify any assets that will be transferred to and/or from the applicant(s). If an asset transfer is required, please complete Part II of the application form.</p> <p>Please see Part 2.</p>

1.5.5

Include an estimate of the credit required for each customer to ensure there is not a negative impact on the total bill.

The customers moving from Erie Thames to Hydro One will receive a monthly bill credit to offset the increase in delivery charges¹. In accordance with the Ontario Energy Board's (OEB) direction provided in "Amendments to the Distribution System Code", the credit will be calculated using each customer's average monthly consumption over the most recent 12 months at the time the application is filed for the OEB's approval. The credit will be fixed at this calculated level and remain in place as long as the customer remains the account holder.

The OEB has confirmed that a deferral account will be provided for the purpose of tracking the rate mitigation costs for future recovery.

Table 3 provides the credit amounts for each specific residential and general service customer moving from Erie Thames to Hydro One.

Table 3: Credit Amounts to Eliminate the Increase in Delivery Charges for Customers Moving from Erie Thames Powerlines Corporation (Rates effective May 1, 2017) to Hydro One Networks (Rates effective January 1, 2017)

Index	Average Monthly Consumption (kWh)	Erie Thames Powerlines Corporation		Hydro One Networks		Monthly Credit (\$)
		Rate Class	Delivery Charges (\$)	Rate Class	Delivery Charges (\$)	
Cust1	915	RES	50.51	R2	76.26	25.75
Cust2	1403	RES	64.64	R2	105.93	41.29
Cust3	1194	GS<50	62.63	GSE	120.99	58.36
Cust4	211	GS<50	30.07	GSE	44.98	14.91
Cust5	1062	RES	54.77	R2	85.20	30.43
Cust6	856	RES	48.80	R2	72.67	23.87
Cust7	897	GS<50	52.79	GSE	98.02	45.23

¹ For the purpose of credit calculations, the delivery charge includes distribution charges, transmission charges and cost of losses, but excludes any rate riders as specified by the OEB in "[Amendments to the Distribution System Code, Section C \(File No.: EB-2015-0006\)](#)".

PART II: TRANSFER OF ASSETS (S. 86(1)(b))

2.1 Description of the Assets to Be Transferred

2.1.1	Provide a description of the assets that are the subject of the transaction. (Attach a detailed list of assets to be sold including value of assets) See Attachments 1 and 2.
2.1.2	Indicate where the assets are located – whether in the applicant’s service territory or in the recipient’s service territory (if applicable). Please include a map of the location. The assets are located within the territory that will be transferred from the geographical distributor to the physical distributor upon approval of the application. Please see Attachments 3 and 4 for maps indicating the location of the assets.
2.1.3	Indicate which distributor’s customers are currently served by the assets. Currently the assets are being used to service the geographical distributor’s customers. Once the application is approved, the assets will continue to service the same customers they currently service. The customers will be transferred from the geographical distributor to the physical distributor.

2.2 Description of the Sale Transaction

2.2.1	The value of the assets to be transferred shall be determined based on net book value (NBV). Attach the details of the associated cash consideration to be given and received by each of the parties to the transaction. Once approved, Hydro One will sell the assets servicing current Hydro One geographical customers to Erie Thames for \$60,804.00 plus applicable taxes. A detailed breakdown of the assets is included in Attachment 1. Erie Thames will sell the assets servicing current Erie Thames geographical customers to Hydro One for \$13,262.00 plus applicable taxes. A detailed breakdown of the assets is included in Attachment 2.
2.2.2	Will the transfer impact any other parties (e.g. joint users of poles) including any agreements with third parties? If yes, please specify how. There are no third parties that will be impacted by this sale.

PART III: CERTIFICATION AND ACNOWLEDGEMENT

Applicant

I certify that the information contained in this application and in the documents provided are true and accurate.

Signature of Key Individual	Name and Title of Key Individual	Date
ORIGINAL SIGNED BY JOANNE RICHARDSON	Joanne Richardson Director - Major Projects and Partnerships, Regulatory Affairs	April 18, 2017

(Must be signed by a key individual. A key individual is one that is responsible for executing the following functions for the applicant: matters related to regulatory requirements and conduct, financial matters and technical matters. These key individuals may include the chief executive officer, the chief financial officer, other officers, directors or proprietors.)

Co-Applicant (if applicable)

I certify that the information contained in this application and in the documents provided are true and accurate.

Signature of Key Individual	Name and Title of Key Individual	Date
	Chris White President	April 13, 2017

(Must be signed by a key individual. A key individual is one that is responsible for executing the following functions for the applicant: matters related to regulatory requirements and conduct, financial matters and technical matters. These key individuals may include the chief executive officer, the chief financial officer, other officers, directors or proprietors.)

Geographical Distributor LTLT Customer and Asset Transfer Information

Map #	Primary Customer Name	Number	Street	City	Postal Code	Lot	Concession	Township	Property Identification No. (PIN) Optional if available	Meter ID No.	Classification Figure #	Geographical Distributor Rate Class, include Tariff (Res, Scomm + RPP, DCB, etc.)
Premise Address									Meter Information		Customer care Billing Information	
1		6	HOLCROFT ST E	SOUTH-WEST OXFORD	N5C 1B4	20	1	SOUTH-WEST OXFORD	1630116	J3615104	Fig.7	R1 TOU_RPP
2		7	COMMISSIONER ST	WEST ZORRA	N0J 1J0	11	4	WEST ZORRA	2160014	J3619335	Fig.8	R2 TOU_RPP
7		7	FRANCES ST	LOGAN	N0K 1N0	16	1	LOGAN	531880016	J3042987	Fig.7	GSE TOURPP
1		8	HOLCROFT ST E	SOUTH-WEST OXFORD	N5C 1B4	20	1	SOUTH-WEST OXFORD	1630027	J2247199	Fig.8	R1 TOU_RPP
2		9	COMMISSIONER ST	WEST ZORRA	N0J 1J0	11	4	WEST ZORRA	2160268	J3674578	Fig.7	R2 TOU_RPP
1		10	HOLCROFT ST E	SOUTH-WEST OXFORD	N5C 1B4	20	1	SOUTH-WEST OXFORD	1630028	J2247531	Fig.8	R1 TOU_RPP
2		11	COMMISSIONER ST	WEST ZORRA	N0J 1J0	11	4	WEST ZORRA	2160269	J2481478	Fig.7	R2 TOU_RPP
11		11	EMBRO ST	OXFORD NORTH	N5A 6S4	20 21	1	OXFORD NORTH	1810092	J3560154	Fig.3	R2 DCB
1		12	HOLCROFT ST E	SOUTH-WEST OXFORD	N5C 1B4	20	1	SOUTH-WEST OXFORD	1630029	J2247529	Fig.7	R1 TOU_RPP
1		14	HOLCROFT ST E	SOUTH-WEST OXFORD	N5C 1B4	20	1	SOUTH-WEST OXFORD	1630030	J2247530	Fig.7	R1 TOU_RPP
2		15	COMMISSIONER ST	WEST ZORRA	N0J 1J0	0	0	WEST ZORRA	2160229	J2481468	Fig.7	R2 TOU_RPP
1		16	HOLCROFT ST E	SOUTH-WEST OXFORD	N5C 1B4	20	1	SOUTH-WEST OXFORD	1630031	J2247532	Fig.7	R1 TOU_RPP
1		18	HOLCROFT ST E	SOUTH-WEST OXFORD	N5C 1B4	20	1	SOUTH-WEST OXFORD	1630032	J2247375	Fig.8	R1 TOU_RPP
2		19	COMMISSIONER ST	WEST ZORRA	N0J 1J0	11	4	WEST ZORRA	2160269	J2481469	Fig.7	R2 DCB
1		20	HOLCROFT ST E	SOUTH-WEST OXFORD	N5C 1B4	20	1	SOUTH-WEST OXFORD	1630033	J2247374	Fig.8	R1 TOU_RPP
2		21	COMMISSIONER ST	WEST ZORRA	N0J 1J0	12	4	WEST ZORRA	2160228	J2481470	Fig.7	R2 TOU_RPP
1		22	HOLCROFT ST E	SOUTH-WEST OXFORD	N5C 1B4	20	1	SOUTH-WEST OXFORD	1630034	J2247373	Fig.8	R1 TOU_RPP
2		23	COMMISSIONER ST	WEST ZORRA	N0J 1J0	12	4	WEST ZORRA	2160237	J2481471	Fig.7	R2 TOU_RPP
1		24	HOLCROFT ST E	SOUTH-WEST OXFORD	N5C 1B4	20	1	SOUTH-WEST OXFORD	1630035	J2247376	Fig.8	R1 TOU_RPP
2		25	COMMISSIONER ST	WEST ZORRA	N0J 1J0	11	4	WEST ZORRA	2160231	J2481472	Fig.7	R2 TOU_RPP
1		26	HOLCROFT ST E	SOUTH-WEST OXFORD	N5C 1B4	20	1	SOUTH-WEST OXFORD	1630036	J2247474	Fig.7	R1 TOU_RPP
2		27	COMMISSIONER ST	WEST ZORRA	N0J 1J0	11	4	WEST ZORRA	2160232	J2481474	Fig.7	R2 DCB
1		28	HOLCROFT ST E	SOUTH-WEST OXFORD	N5C 1B4	20	1	SOUTH-WEST OXFORD	1630037	J3600437	Fig.8	R1 2TR_RPP
2		29	COMMISSIONER ST	WEST ZORRA	N0J 1J0	0	0	WEST ZORRA	2160236	J3500939	Fig.7	R2 DCB
2		31	COMMISSIONER ST	WEST ZORRA	N0J 1J0	11	4	WEST ZORRA	2160234	J2481475	Fig.7	R2 TOU_RPP
8		36	PARK AVE	SOUTH-WEST OXFORD	N5C 1B5	19	1	SOUTH-WEST OXFORD	1650071	J2247473	Fig.2	GSE TOURPP
8		46	PARK AVE	SOUTH-WEST OXFORD	N5C 1B5	19	1	SOUTH-WEST OXFORD	1650416	J2247537	Fig.2	R1 TOU_RPP
4		75	NORTH TOWN LINE E	OXFORD NORTH	N5C 3J5	11	3	OXFORD NORTH	1800089	J3058549	Fig.4	R2 DCB
7		81	FRANCIS ST	LOGAN	N0E 1W0	PT16	2	LOGAN	531880010	J3450544	Fig.16	GSD_2TRRPP
7		81	FRANCIS ST	LOGAN	N0E 1W0	PT17	2	LOGAN	531880010	J3577501	Fig.16	GSE DCB
4		83	NORTH TOWN LINE E	OXFORD NORTH	N5C 3J5	12	3	OXFORD NORTH	1800104	J3058550	Fig.4	R2 2TR_RPP
4		87	NORTH TOWN LINE E	OXFORD NORTH	N5C 3J5	12	3	OXFORD NORTH	1800100	J3058552	Fig.4	R2 2TR_RPP
4		91	NORTH TOWN LINE E	OXFORD NORTH	N5C 3J5	12	3	OXFORD NORTH	1800101	J2103586	Fig.3	R2 2TR_RPP
4		103	NORTH TOWN LINE E	OXFORD NORTH	N5C 3J5	12	3	OXFORD NORTH	1800099	J3596695	Fig.7	R2 2TR_RPP
4		109	NORTH TOWN LINE E	OXFORD NORTH	N5C 3J5	12	3	OXFORD NORTH	1800103	J3058534	Fig.4	R2 2TR_RPP
4		117	NORTH TOWN LINE E	OXFORD NORTH	N5C 3J5	11	3	OXFORD NORTH	1800098	J3058535	Fig.7	R2 DCB
4		125	NORTH TOWN LINE E	OXFORD NORTH	N5C 3J5	11	3	OXFORD NORTH	1800131	J3025091	Fig.3	R2 TOU_RPP
3		#N/A	#N/A	#N/A	#N/A	#N/A	#N/A	#N/A	N/A	J3210561	Fig.14	R2 2TR_RPP
3		141	BRAYSIDE ST	YARMOUTH	N5L 1A2	3	1	YARMOUTH	352560239	J3350041	Fig.14	R1 2TR_RPP
4		145	NORTH TOWN LINE E	OXFORD NORTH	N5C 3J5	12	3	OXFORD NORTH	1800095	J3058533	Fig.3	R2 DCB
4		147	NORTH TOWN LINE E	OXFORD NORTH	N5C 3J5	12	3	OXFORD NORTH	1800130	J3058536	Fig.3	R2 TOU_RPP
3		181	BRAYSIDE ST	YARMOUTH	N5L 1A2	1	1	YARMOUTH	352560216	J3235470	Fig.16	S_2TR_RPP
3		191	BRAYSIDE ST	YARMOUTH	N5L 1A2	2	1	YARMOUTH	N/A	J3208679	Fig.16	R1 2TR_RPP
3		191	BRAYSIDE ST	#N/A	#N/A	#N/A	#N/A	#N/A	N/A	#	Fig.16	SNL_2TRRPP
9		341	BORDEN AVE	YARMOUTH	N0L 1B0	15	15	YARMOUTH	352700105	J3194189	Fig.1	R2 TOU_RPP
1		343	THAMES ST S	SOUTH-WEST OXFORD	N5C 2V4	20	1	SOUTH-WEST OXFORD	1630117	J2247202	Fig.8	R1 TOU_RPP
5		452	HAINES ST	OXFORD NORTH	N5C 2S5	8	4	OXFORD NORTH	1760036	J3272601	Fig.1	R2 DCB
5		454	HAINES ST	OXFORD NORTH	N5C 2S5	8	4	OXFORD NORTH	1760035	J3249452	Fig.5	R2 TOU_RPP
5		456	HAINES ST	OXFORD NORTH	N5C 2S5	8	4	OXFORD NORTH	1760034	J3182650	Fig.6	R2 TOU_RPP
5		458	HAINES ST	OXFORD NORTH	N5C 2S5	8	4	OXFORD NORTH	1760099	J3243191	Fig.2	R2 TOU_RPP
5		467	HAINES ST	OXFORD NORTH	N5C 2S5	8	4	OXFORD NORTH	1760032	J3182722	Fig.5	R2 TOU_RPP
9		591	WILLSIE BOURNE RD	YARMOUTH	N0L 1B0	14	15	YARMOUTH	N/A	J3212468	Fig.2	R2 2TR_RPP
9		45003	TAYLOR LINE	YARMOUTH	L0K 1E0	0	0	YARMOUTH	N/A	J3443260	Fig.15	GSD_WSP
6		334490	PEMBERTON ST	OXFORD NORTH	N5C 4G4	13	4	OXFORD NORTH	1820107	J3058553	Fig.10	R2 TOU_RPP
10		434696	WEST HILL LINE	SOUTH-WEST OXFORD	N0J 1A0	9 BF		SOUTH-WEST OXFORD	1410066	J3674556	Fig.15	GSE_2TRRPP
6		603779	CEMETERY LANE	OXFORD NORTH	P0P 1N0	13	4	OXFORD NORTH	1820107	J3058554	Fig.6	R2 TOU_RPP
6		623788	ROAD 62	OXFORD NORTH	P0P 1N0	13	4	OXFORD NORTH	1820105	J3375988	Fig.14	MICROFIT
6		623788	ROAD 62	OXFORD NORTH	P0P 1N0	13	4	OXFORD NORTH	1820077	J3319540	Fig.14	GSE TOURPP
12		784074	78TH RD	WEST ZORRA	N0J 1J0	10	5	WEST ZORRA		J2481180	Fig.13	R2 2TR_RPP
6				INGERSOLL	N3A 4A6	PT 13	4	INGERSOLL	1820105	J3500907	Fig.14	MICROFIT
2				WEST ZORRA	P0M 1M0	11	4	WEST ZORRA		J2169174	Fig.7	GSE TOURPP

	Figure #1	Figure #2	Figure #3	Figure #4	Figure #5	Figure #6	Figure #7	Figure #8	Figure #9	Figure #10	Figure #11	Figure #12	Figure #13	Figure #14	Figure #15	Primary Wire Line
Main Page	2	4	5	4	2	2	19	9	0	1	0	0	1	5	2	
Special Case #1																
Special Case #2																
Special Case #3																
Special Case #4																
Special Case #5																
Special Case #6																
O/H	20	70	20	70		50		50		63		63				
U/G	63		63		63		63		63		63					
Primary								20	20				20		20	
Neutral								20	20				20		20	
Subtotal	2	4	5	4	2	2	19	9	0	1	0	0	1	5	2	0
Total O/H	40	280	100	280	0	100	0	450	0	63	0	0	0	0	0	Total Secondary O/H (m)
Total U/G	126	0	315	0	126	0	1197	0	0	0	0	0	0	0	0	Total Secondary U/G (m)
Total Primary	0	0	0	0	0	0	0	0	0	40	0	0	40	0	80	Total Primary (m)
Toal Buss (m)	4080															160

POLES	30	35	40	45	50	55	Total
Main Page	1	9	3	0	0	0	13
Special Case #1							0
Special Case #2							0
Special Case #3							0
Special Case #4							0
Special Case #5							0
Special Case #6							0
TOTAL	1	9	3	0	0	0	13

Transformers	5	10	15	25	50	75	100	167	Total
Main Page	0	4	1	8	7	2	0	0	22
Special Case #1									0
Special Case #2									0
Special Case #3									0
Special Case #4									0
Special Case #5									0
Special Case #6									0
TOTAL	0	4	1	8	7	2	0	0	22
Sentinel Lights (Total)	0								

ASSET SUMMARY

Poles	30	35	40	45	50	55	Total		
	1	9	3	0	0	0	13		
Transformers	5	10	15	25	50	75	100	167	Total
	0	4	1	8	7	2	0	0	22
Primary Wire (metres)	160								
Secondary O/H Wire (Metres)	5393								
Secondary U/G Wire (Metres)	1764								
Current Transformers	0								
Sentinel Lights	0								
Easements	0								

Geographical Distributor LTLT Customer and Asset Transfer Information

Map #	Primary Customer Name	Number	Street	City	Postal Code	Lot	Concession	Township	Property Identification No. (PIN) Optional if available	Meter ID No.	Classification Figure #	Geographical Distributor Rate Class, include Tariff (Res, Scomm + RPP, DCB, etc.)
		Premise Address								Meter Information		Customer care Billing Information
1	Gary Brenneman	415639	41ST LINE	EMBRO	N0J 1J0			ZORRA		ET0019807	Fig.5	
1	Carey Condru	415649	41ST LINE	EMBRO	N0J 1J0			ZORRA		ET0019901	Fig.5	
2	UNION GAS	415683	41ST LINE	EMBRO	N0J 1J0			ZORRA		ET0009356	Fig.6	
3	Brian Usher	415729	41ST LINE	EMBRO	N0J 1J0			ZORRA		ET0019805	Fig.2	
3	Robert Usher	415749	41ST LINE	EMBRO	N0J 1J0			ZORRA		ET0018465	Fig.2	
4	Marc Langlois	415773	41ST LINE	EMBRO	N0J 1J0			ZORRA		ET0019803	Fig.5	
5	ISI Custom Woodworking	6959	Perth Line 34	DUBLIN	NOK 1E0			WEST PERTH		WPP0022179	Fig.14	

	Figure #1	Figure #2	Figure #3	Figure #4	Figure #5	Figure #6	Figure #7	Figure #8	Figure #9	Figure #10	Figure #11	Figure #12	Figure #13	Figure #14	Figure #15	Primary Wire Line
Main Page	0	2	0	0	3	1	0	0	0	0	0	0	0	1	0	
Special Case #1																
Special Case #2																
Special Case #3																
Special Case #4																
Special Case #5																
Special Case #6																
O/H	20	70	20	70		50		50		63		63				
U/G	63		63		63		63		63		63					
Primary									20	20			20		20	
Neutral									20	20			20		20	
Subtotal	0	2	0	0	3	1	0	0	0	0	0	0	0	1	0	0
Total O/H	0	140	0	0	0	50	0	0	0	0	0	0	0	0	0	Total Secondary O/H (m)
Total U/G	0	0	0	0	189	0	0	0	0	0	0	0	0	0	0	Total Secondary U/G (m)
Total Primary	0	0	0	0	0	0	0	0	0	0	0	0	0	0	0	Total Primary (m)
Toal Buss (m)	0															0

POLES	30	35	40	45	50	55	Total
Main Page	2	0	0	0	0	0	2
Special Case #1							0
Special Case #2							0
Special Case #3							0
Special Case #4							0
Special Case #5							0
Special Case #6							0
TOTAL	2	0	0	0	0	0	2

Transformers	5	10	15	25	50	75	100	167	Total
Main Page	1	0	1	5	0	0	0	0	7
Special Case #1									0
Special Case #2									0
Special Case #3									0
Special Case #4									0
Special Case #5									0
Special Case #6									0
TOTAL	1	0	1	5	0	0	0	0	7
Sentinel Lights (Total)	0								

ASSET SUMMARY

Poles	30	35	40	45	50	55	Total		
	2	0	0	0	0	0	2		
Transformers	5	10	15	25	50	75	100	167	Total
	1	0	1	5	0	0	0	0	7
Primary Wire (metres)	0								
Secondary O/H Wire (Metres)	190								
Secondary U/G Wire (Metres)	189								

Hydro One Geographical LDC Maps for LTLT Elimination with Erie Thames Powerlines

Filed: 2017-04-18

Attachment 3

Page 1 of 7

as Physical LDC

Maps Legend

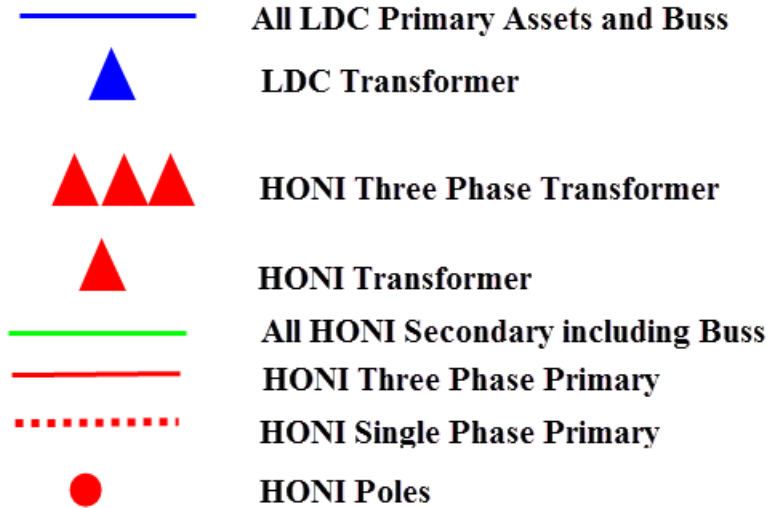

Map #1 -



Map #2 –

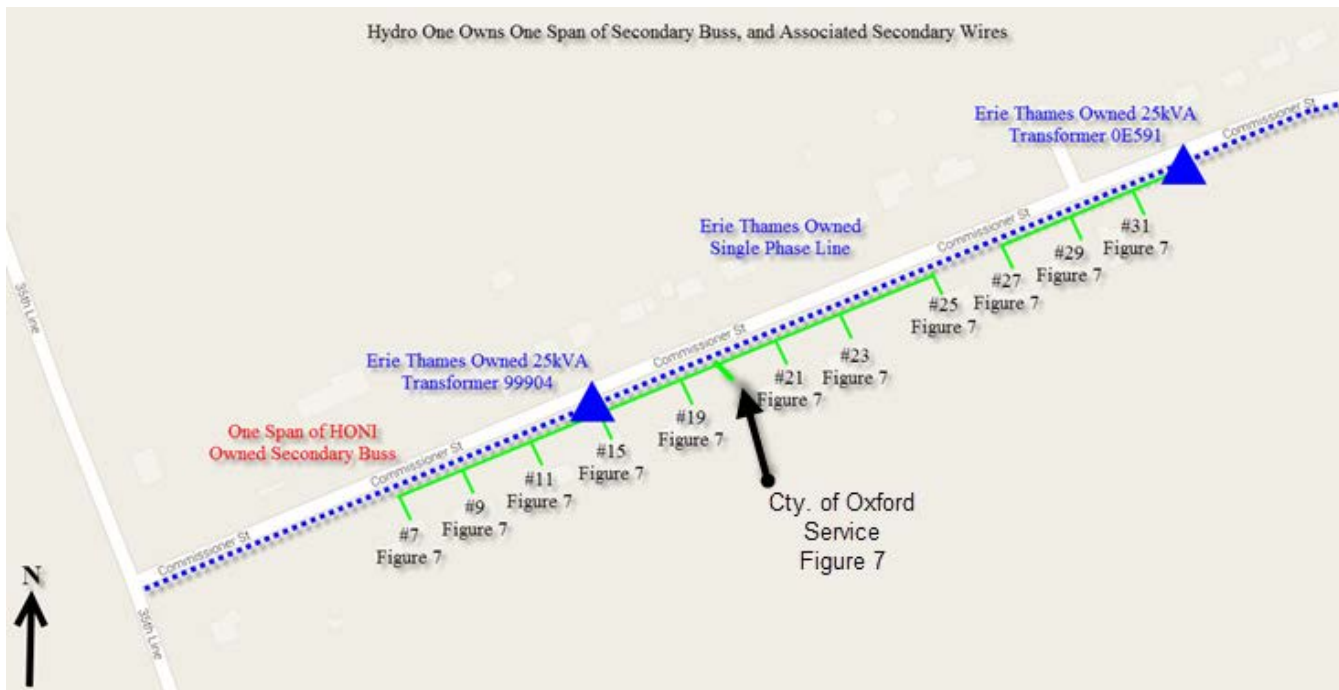

Map #3 –

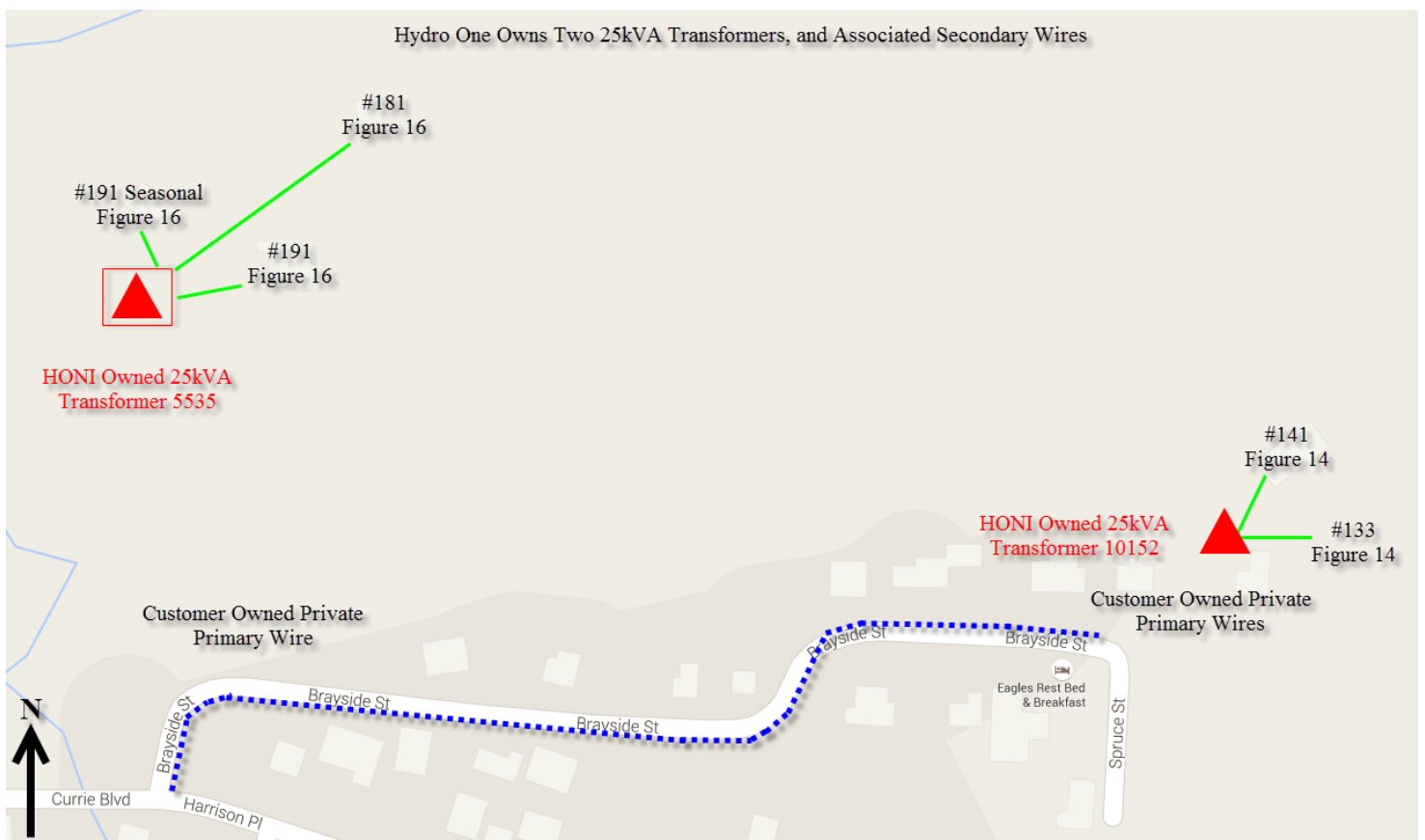

Map #4 –

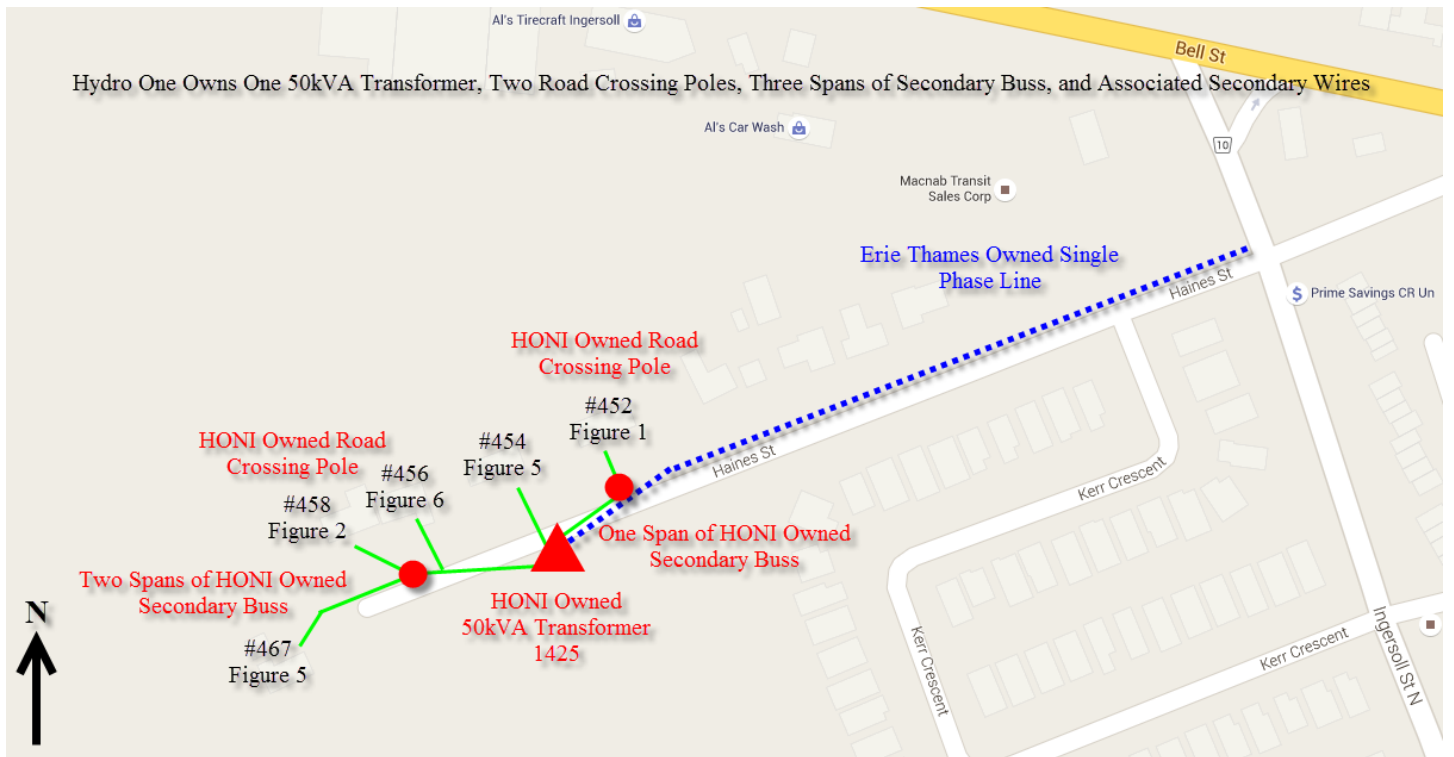

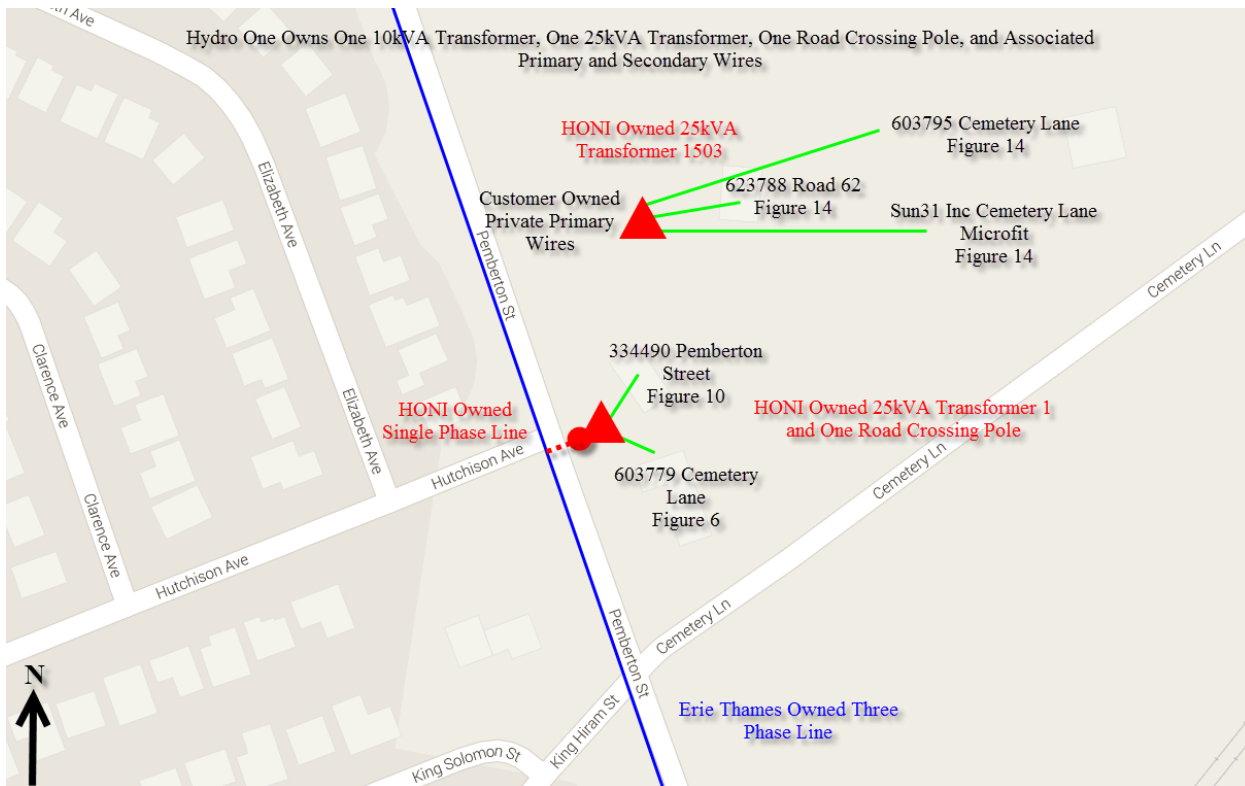

Map #7 –



Map #8 –

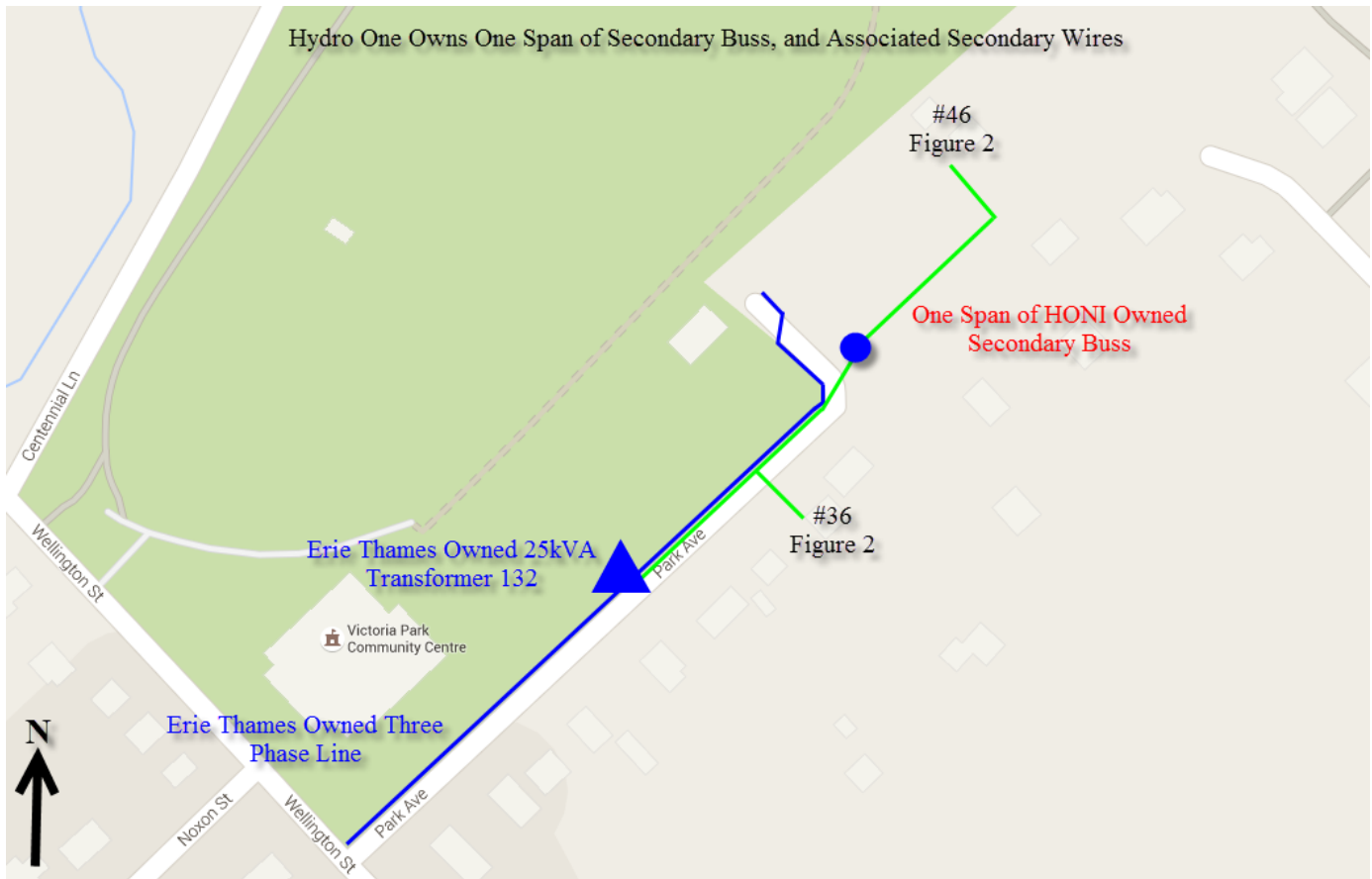

Map #9 –

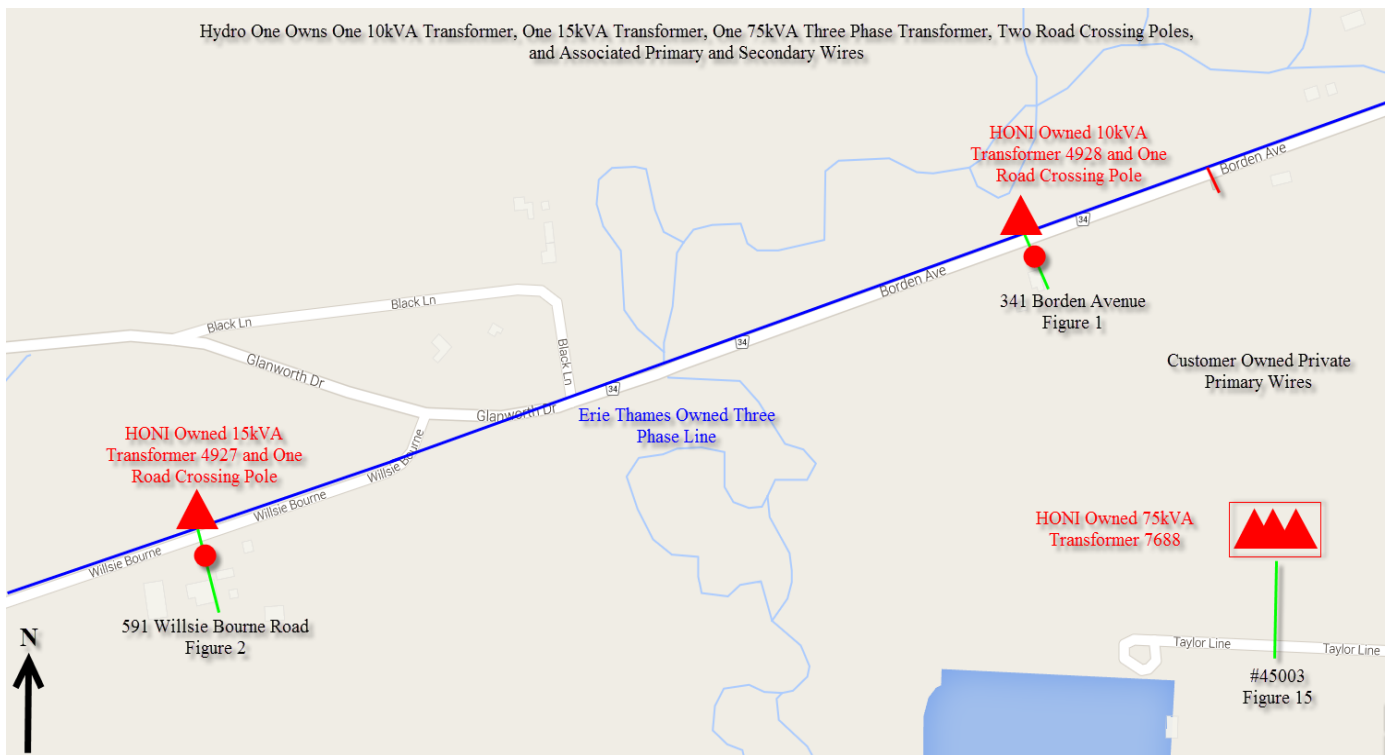

Map #10 –

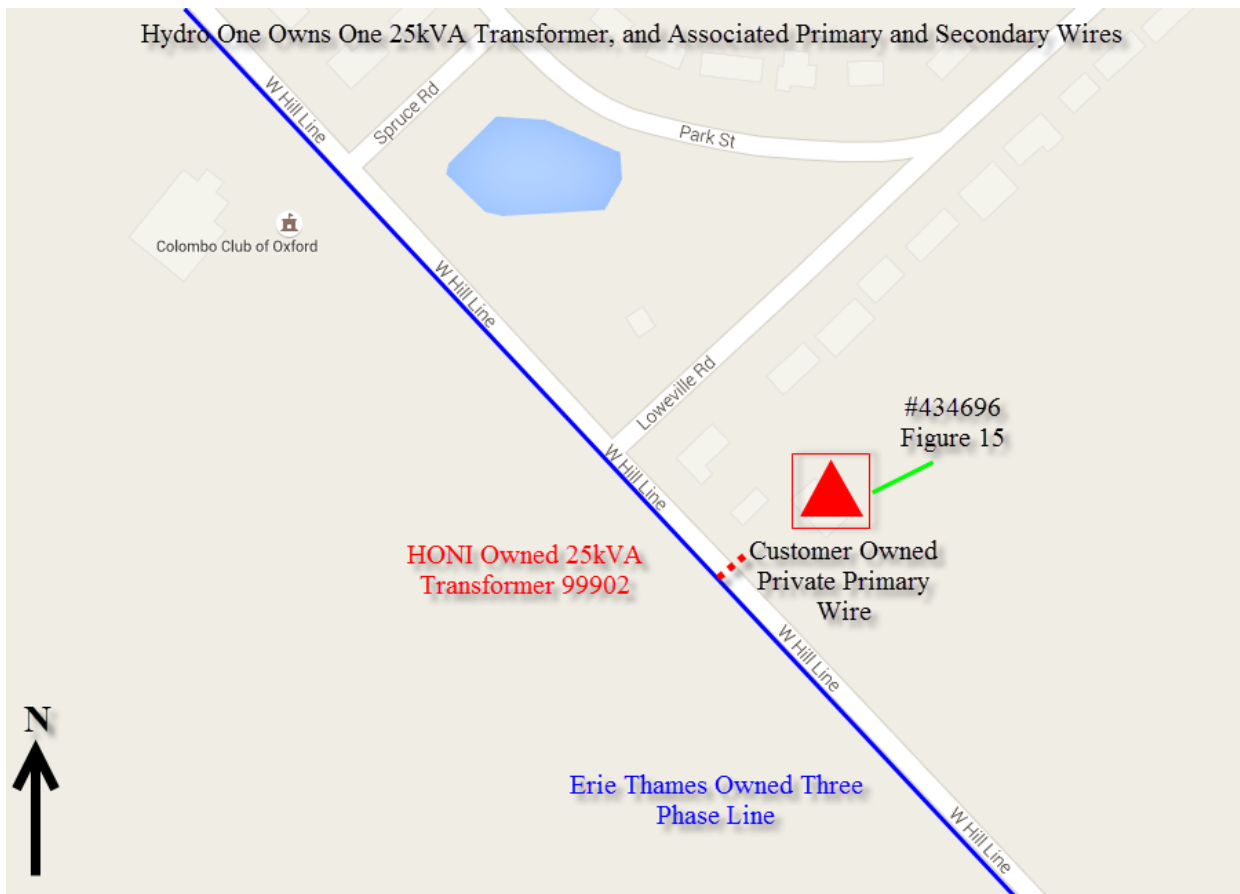

Map #11 –

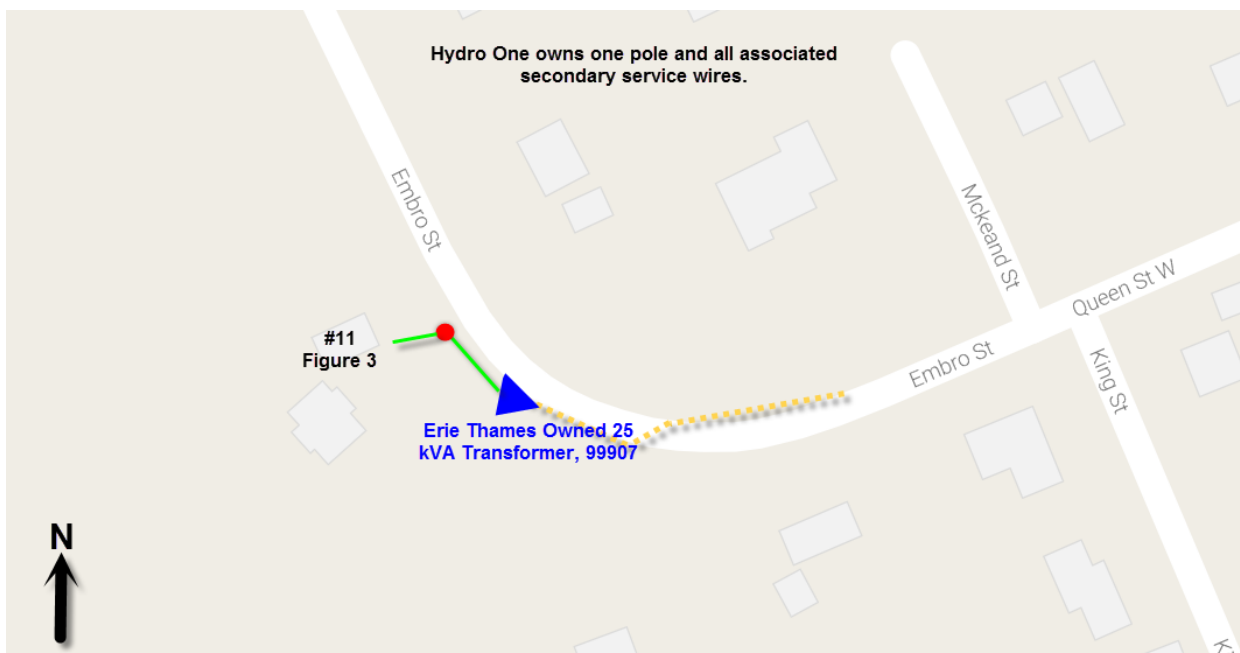

Map #12 –

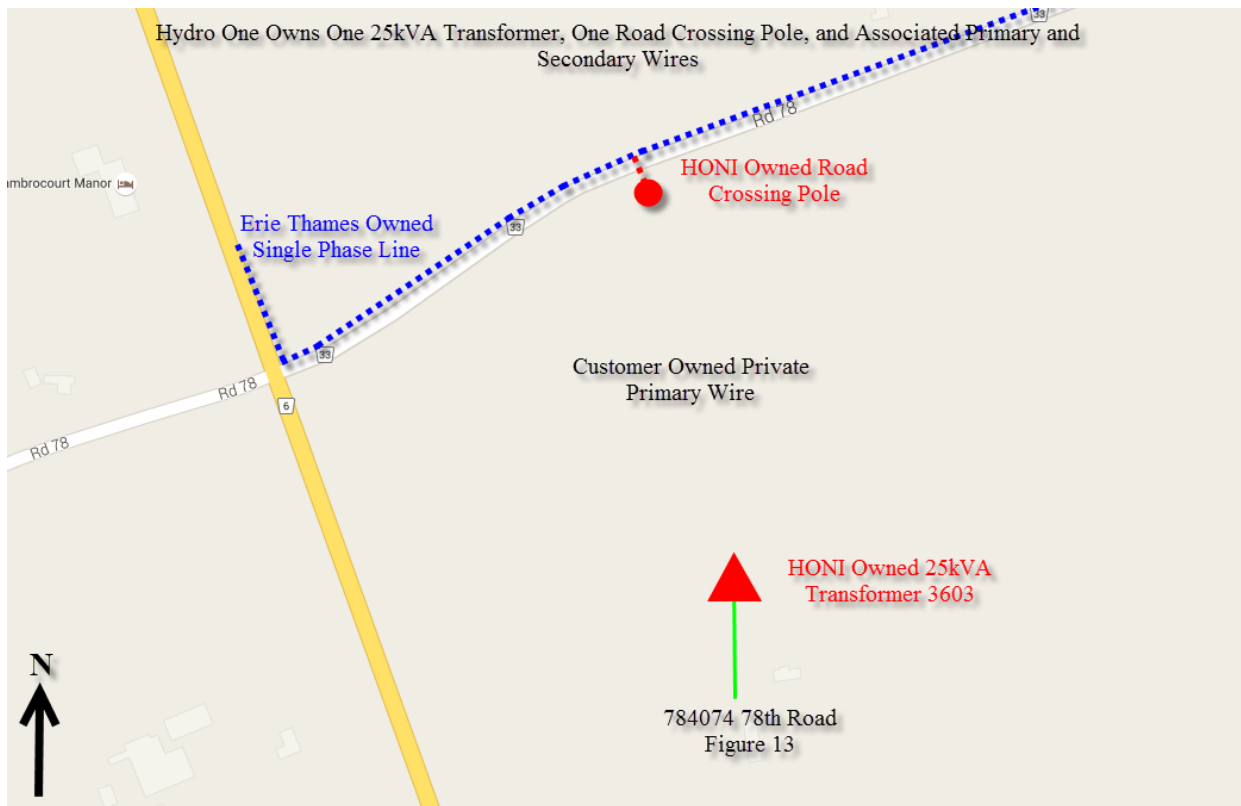

LEGEND

- Map #1



Map #2

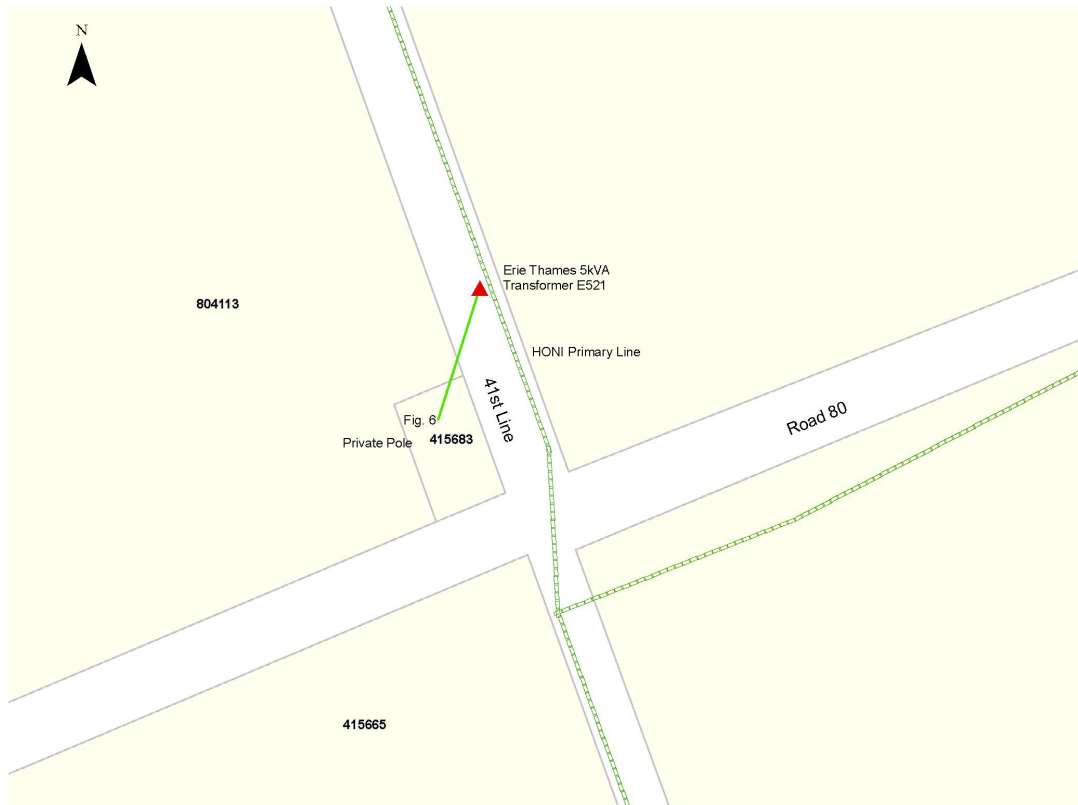

Map #3



Map #4

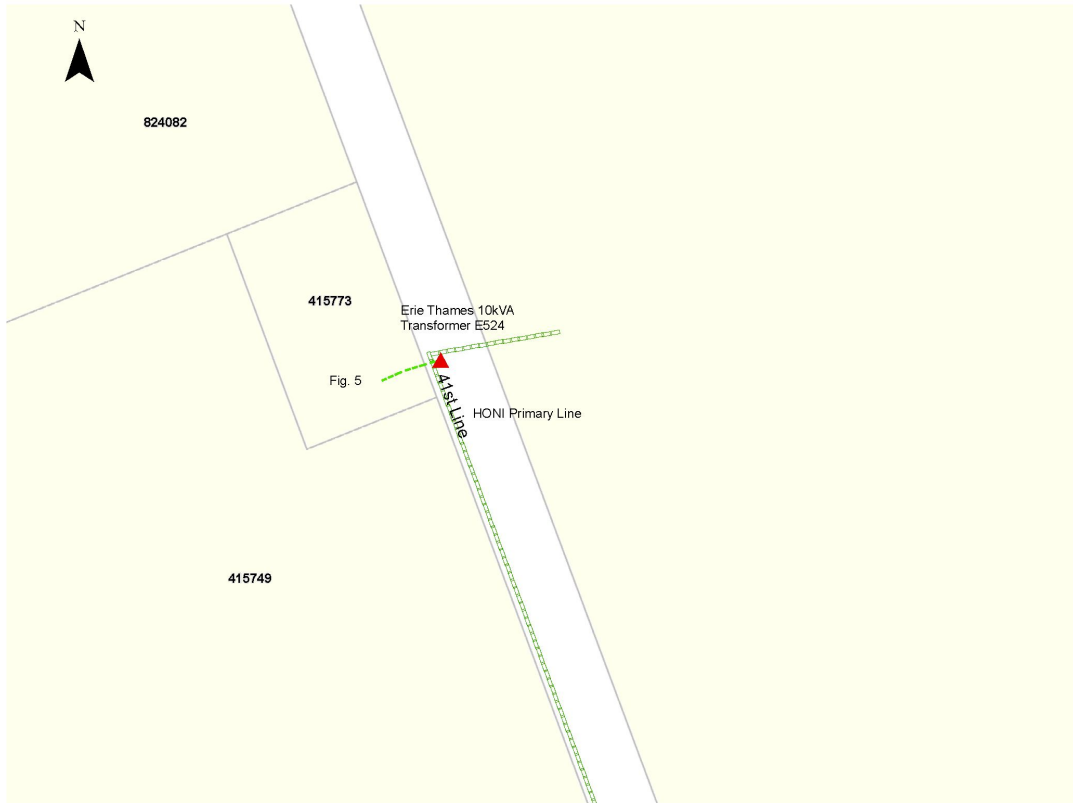

Map #5

