

Elimination of Long Term Load Transfers

Between

Milton Hydro Distribution Inc.

And

Oakville Hydro Electricity Distribution Inc.

Combined Service Area Amendment and Asset Transfer Application

Date: June 13, 2017

Part I: Service Area Amendment

1.1 Basic Facts

This joint application between Milton Hydro Distribution Inc. (“Milton Hydro”) and Oakville Hydro Electricity Distribution Inc., (“Oakville Hydro”) addresses the elimination of long term load transfers (“LTLT”) between Milton Hydro and Oakville Hydro.

This application proposes to transfer Milton Hydro’s assets which are fed from Oakville Hydro’s distribution system to Oakville Hydro and to transfer Oakville Hydro’s assets which are fed from Milton Hydro’s distribution system in order to complete the elimination of these LTLT customers.

This is an application amalgamating and streamlining the elements of a Service Area Amendment (“SAA”) and a Section 86(1)(b) application for LTLT and associated exemption purposes only.

1.2 Identification of the Parties

1.2.1 Applicant

Milton Hydro Distribution Inc. (ED-2003-0014)	
200 Chisholm Drive Milton, Ontario L9T 3G9	Contact Person – Cameron McKenzie
	Telephone Number – 289-429-5212
	Fax Number – 905-876-2044
	E-mail – cameronmckenzie@miltonhydro.com

1.2.2 Co-Applicant

Oakville Hydro Electricity Distribution Inc. (ED-2003-0135)	
861 Redwood Square P.O. Box 1900 Oakville, Ontario L6K 0C7	Contact Person – Maryanne Wilson
	Telephone Number – 905-825-4422
	E-mail – mwilson@oakvillehydro.com

1.3 Description of Proposed Service Area

1.3.1	<p>Provide a detailed service area description of the area(s) that is subject to the SAA and how the amendments should be reflected in Schedule 1 of the licence(s) of the distributor(s).</p> <p><u>Milton Hydro Distribution Inc. (ED-2003-0014)</u></p> <p>Currently, Schedule 1 of Milton Hydro's distribution license defines the boundaries of its service area as follows:</p> <ol style="list-style-type: none"> 1. The Town of Milton as of December 31, 1990, excluding the following municipal addresses: <ul style="list-style-type: none"> • 5073 Bell School Line • 5073 Bell School Line • 5741 Bell School Line 2. Customers in the City of Burlington at the following municipal addresses: <ul style="list-style-type: none"> • 5222 No. 1 Side Road • 5244 No. 1 Side Road • 5300 No. 1 Side Road • 6080 Bell School Line • 6100 Bell School Line • 6144 Bell School Line • 6220 Bell School Line • 6550 Bell School Line • 6500 Bell School Line • 5274 Derry Road • 5192 Derry Road • 5184 Derry Road • 5150 Derry Road • 5150 Derry Road • 5150 Derry Road • 5118 Derry Road • 4316 Derry Road • 4280 Derry Road • 4262 Derry Road • 4240 Derry Road • 4220 Derry Road • 4200 Derry Road • 4140 Derry Road • 4130 Derry Road • 4110 Derry Road • 4082 Derry Road • 4050 Derry Road
-------	--

- 4030 Derry Road
- 4020 Derry Road
- 4006 Derry Road
- 3900 Derry Road
- 3800 Derry Road
- 3700 Derry Road
- 3200 Derry Road
- 3154 Derry Road
- 2192 Derry Road
- 2180 Derry Road
- 2130 Derry Road
- 1200 Derry Road
- 6719 McNiven Road
- 6740 McNiven Road

The proposed amendments are premise-specific and as such this application would require amending the geographic boundary of Schedule 1 of Milton Hydro's distribution licence for the specific municipal addresses. The amendments propose the following changes for section 1 of Schedule 1 and the addition of section 3 to Schedule 1 as follows:

1. The Town of Milton as of December 31, 1990, excluding the following municipal addresses:

- 5073 Bell School Line
- 5073 Bell School Line
- 5741 Bell School Line
- 3003 Burnhamthorpe Road West
- 4034 Regional Road 25
- 4090 Regional Road 25

Add

3. Customers in the Town of Oakville at the following municipal addresses:

- 3114 Burnhamthorpe Road West
- 3164 Burnhamthorpe Road West
- 3326 Burnhamthorpe Road West
- 3328 Burnhamthorpe Road West
- 3364 Burnhamthorpe Road West
- 3388 Burnhamthorpe Road West
- 3406 Burnhamthorpe Road West
- 3414 Burnhamthorpe Road West
- 3466 Burnhamthorpe Road West
- 4269 Bronte Road

- 4289 Bronte Road
- 4343 Bronte Road
- 4449 Bronte Road
- 1470 Lower Base Line Road West
- 1556 Lower Base Line Road West
- 1670 Lower Base Line Road West
- 2026 Lower Base Line Road West
- 2400 Lower Base Line Road West
- 2410 Lower Base Line Road West
- 2156 Lower Base Line Road West
- 2170 Lower Base Line Road West
- 2194 Lower Base Line Road West
- 4268 Fourth Line
- 4278 Fourth Line
- 4414 Fourth Line

Oakville Hydro Electricity Distribution Inc. (ED-2003-0135)

Currently, Schedule 1 of Oakville Hydro's distribution license defines the boundaries of its service area as follows:

1. The Town of Oakville as of December 31, 1990.
2. The following lands located within the City of Mississauga:
 - the triangular piece of lands located between Dundas Street West to Ninth Line to Highway 403, generally between (250 metres north of) Burnhamthorpe Road to the north and Dundas Street West to the south.

The proposed amendments are premise-specific and as such this application would require amending the geographic boundary of Schedule 1 of Oakville Hydro's distribution licence for the specific municipal addresses. The amendments propose the following changes for section 1 of Schedule 1 and the addition of section 3 to Schedule 1 as follows:

1. The Town of Oakville as of December 31, 1990, excluding the following municipal addresses:
 - 3114 Burnhamthorpe Road West
 - 3164 Burnhamthorpe Road West
 - 3326 Burnhamthorpe Road West
 - 3328 Burnhamthorpe Road West
 - 3364 Burnhamthorpe Road West

	<ul style="list-style-type: none"> • 3388 Burnhamthorpe Road West • 3406 Burnhamthorpe Road West • 3414 Burnhamthorpe Road West • 3466 Burnhamthorpe Road West • 4269 Bronte Road • 4289 Bronte Road • 4343 Bronte Road • 4449 Bronte Road • 1470 Lower Base Line Road West • 1556 Lower Base Line Road West • 1670 Lower Base Line Road West • 2026 Lower Base Line Road West • 2400 Lower Base Line Road West • 2410 Lower Base Line Road West • 2156 Lower Base Line Road West • 2170 Lower Base Line Road West • 2194 Lower Base Line Road West • 4268 Fourth Line • 4278 Fourth Line • 4414 Fourth Line <p>Add:</p> <p>3. Customers in the Town of Milton at the following municipal addresses:</p> <ul style="list-style-type: none"> • 3003 Burnhamthorpe Road West • 4034 Regional Road 25 • 4090 Regional Road 25
1.3.2	<p>Provide maps or diagrams of the area(s) that is the subject of the SAA application.</p> <p>Detailed information of the area affected by the LTLT is found in Attachment 1 – Milton Hydro transfers to Oakville Hydro LTLT Maps and Attachment 2 – Oakville Hydro transfers to Milton Hydro LTLT Maps.</p>
1.3.3	<p>Provide a description of the type of physical connection(s); i.e., individual customer, residential subdivision, commercial or industrial customer.</p> <p>8 Milton Hydro customers are proposed to be transferred to Oakville Hydro:</p> <ul style="list-style-type: none"> • 2 Residential • 4 General Service < 50 kW • 2 Sentinel Lights

	<p>34 Oakville Hydro customers are proposed to be transferred to Milton Hydro:</p> <ul style="list-style-type: none"> • 21 Residential • 11 General Service < 50 kW • 1 General Service > 50 kW • 1 microFIT <p>Individual customer names (filed in confidence), addresses, and rate classes are found in the Excel spreadsheet filed separately with this Application and also at Attachment 4 for Milton Hydro. Oakville Hydro's individual customer names (filed in confidence), addresses, and rate classes are found Attachment 6.</p> <p>Detailed information of the area affected by the LTLT is found in Attachment 1 and Attachment 2.</p>
--	---

3.2 Information on Affected Load Transfer Customers

1.4.1	<p>Provide the total number of Load Transfer Arrangements between distributors.</p> <p>This application addresses the elimination of the two existing LTLT agreements between Milton Hydro and Oakville Hydro.</p>
1.4.2	<p>Provide the number of Load Transfer Arrangements eliminated in this application.</p> <p>This application proposes the elimination of the two existing LTLT agreements between Milton Hydro and Oakville Hydro.</p>
1.4.3	<p>Provide the number of customers to be transferred from Milton Hydro to Oakville Hydro.</p> <p>Please see 1.3.3 above.</p>
1.4.4	<p>Provide the number of customers to be transferred from Oakville Hydro to Milton Hydro.</p> <p>Please see 1.3.3 above.</p>
1.4.5	<p>Provide the list of affected load transfer customers. (Customer listing must include customer address, name, billing address, rate class and meter number).</p> <p>Please see Milton Hydro's Attachment 4 and Oakville Hydro's Attachment 6. Customer</p>

	names have been removed from the Attachments for confidentiality. Individual customer names may be found on Milton Hydro's Excel, spreadsheet Attachment 4, filed in confidence and Oakville Hydro's Attachment 6 also filed in confidence.
1.4.6	<p>Provide written confirmation that all affected persons have been provided with specific and factual information about the service area amendment(s).</p> <p>The applicants confirm that the affected customers have been notified of the changes affected by the service area amendment. Please see Attachment 7 for the letters that were used as templates to notify all affected customers.</p>

3.3 Impacts Arising from the Amendment(s)

1.5.1	<p>Use the table below to describe the impact on the average residential customers' total bill that arises as a result of the service area amendment(s) before and after rate mitigation is applied. Use delivery charge on consumer's bill (including cost of losses and excluding all rate riders). Use 800 kWh / month for the average residential consumer. Provide any additional information as required.</p> <p>The average Residential customer being transferred to Oakville Hydro and using 800 kWh per month, will have an increase in the total monthly delivery charge of \$1.15.</p> <p>The average Residential customer being transferred to Milton Hydro and using 800 kWh per month, will have a decrease in the total monthly delivery charge of \$1.15.</p>
1.5.2	<p>Provide a description of any assets which may be stranded or become redundant after completion of the service area amendment(s). Please explain why these assets could not be transferred to the physical distributor.</p> <p>No assets will be stranded as a result of this amendment.</p>
1.5.3	<p>Identify costs for stranded equipment that would need to be de-energized or removed.</p> <p>Not applicable.</p>
1.5.4	<p>Identify any assets that will be transferred to and/or from the applicant(s). If an asset transfer is required, please complete Part II of the application form.</p> <p>Please see the Excel spreadsheet filed separately for Milton Hydro's Asset Valuation and also at Attachment 4. Oakville Hydro's Asset Summary is included at Attachment 5.</p>

1.5.5

Include an estimate of the credit required for each customer to ensure there is not a negative impact on the total bill.

Please see the Table below – Milton Hydro / Oakville Hydro LTLT Rate Impacts for the customers being transferred to Oakville Hydro.

			Milton Hydro					Oakville Hydro					
Name	Class	Monthly kWh	Fixed Dist Charge	Var Dist Charge	TX Charge	Losses \$\$\$	Total Delivery Charge \$\$\$	Fixed Dist Charge	Var Dist Charge	TX Charge	Losses \$\$\$	Total Delivery Charge \$\$\$	Avge Bill Impact - If Increase Credit Required
Cust 1	GS < 50	623.58	16.77	0.0177	0.0123	2.28	38.03	36.26	0.0161	0.0127	2.29	56.80	18.76
Cust 2	Res	1156.32	21.70	0.0074	0.0136	4.23	50.78	21.95	0.0082	0.0139	4.24	52.33	1.56
Cust 3	GS < 50	179.27	16.77	0.0177	0.0123	0.66	22.88	36.26	0.0161	0.0127	0.66	42.16	19.28
Cust 4	GS < 50	63.28	16.77	0.0177	0.0123	0.23	18.93	36.26	0.0161	0.0127	0.23	38.34	19.42
Cust 5	GS < 50	8574.05	16.77	0.0177	0.0123	31.36	309.11	36.26	0.0161	0.0127	31.44	318.63	9.52
Cust 6	Res	1710.93	21.70	0.0074	0.0136	6.26	64.72	21.95	0.0082	0.0139	6.27	66.90	2.18

Please see Attachment 3 for Oakville Hydro to Milton Hydro LTLT Rate Impacts.

A mitigation credit will not be applied to the Microfit, Sentinel Light and Unmetered/Scattered Load accounts being transferred between Milton Hydro and Oakville Hydro.

Part II: TRANSFER OF ASSETS (S. 86(1)(b))

2.1 Description of the Assets to Be Transferred

2.1.1	<p>Provide a description of the assets that are the subject of the transaction. (Attach a detailed list of assets to be sold including value of assets).</p> <p>Please see Milton Hydro's Excel spreadsheets filed separately and also at Attachment 4 for the Asset Transfer Information. Attachment 5 identifies Oakville Hydro LTLT Asset Transfer Information.</p>
2.1.2	<p>Indicate where the assets are located – whether in the applicant's service territory or in the recipient's service territory (if applicable). Please include a map of the location.</p> <p>The assets are located within the territory that is proposed to be transferred from the geographical distributor to the physical distributor. Please see Attachment 1 – Milton Hydro to Oakville Hydro and Attachment 2 – Oakville Hydro to Milton Hydro.</p>
2.1.3	<p>Indicate which distributor's customers are currently served by the assets.</p> <p>Currently the assets are being used to service the geographic distributor's customers. Once the application is approved, the assets will continue to service the same customers they currently service. The customers will be transferred from the geographic distributor to the physical distributor.</p>

2.2 Description of the Sale Transaction

2.2.1	<p>The value of the assets to be transferred shall be determined based on net book value ("NBV"). Attach the details of the associated cash consideration to be given and received by each of the parties to the transaction.</p> <p>Milton Hydro will sell the assets servicing current Milton Hydro Geographic Customers to Oakville Hydro for \$9,054.00 plus applicable taxes. A detailed breakdown of the assets is included in Attachment 4.</p> <p>Oakville Hydro will sell the assets servicing current Oakville Hydro Geographic Customers to Milton Hydro for \$104,219 plus applicable taxes. A detailed breakdown of the assets is included in Attachment 5.</p>
--------------	---

2.2.2	<p>Will the transfer impact any other parties (e.g., joint users of poles) including any agreements with third parties? If yes, please specify below.</p> <p>No.</p>
--------------	---

PART III: CERTIFICATION AND ACKNOWLEDGEMENT

Applicant:

I certify that the information contained in this application and in the documents provided are true and accurate.

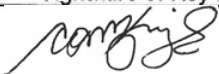
Signature of Key Individual	Name and Title of Key Individual	Date
	Cameron McKenzie Director, Regulatory Affairs	June 15, 2017

Co-Applicant:

I certify that the information contained in this application and in the documents provided are true and accurate.

Signature of Key Individual	Name and Title of Key Individual	Date
	Maryanne Wilson Director, Regulatory and Compliance	June 15, 2017

Attachment 1

Milton Hydro / Oakville Hydro LTLT Maps

- Legend
- Map 1 - Boundary Map
- Map 2 – Customer Account Locations
- Map 3 – Service Layouts

Attachment 2

Oakville Hydro to Milton Hydro LTLT Maps

- Map 1 - Boundary Map
- Map 2 – Customer Account Locations
- Map 3 – Service Layouts

Attachment 3

Oakville Hydro to Milton Hydro LTLT Rate Impacts

Attachment 4

Milton Hydro / Oakville Hydro LTLT Asset Transfer Spreadsheet (also filed in an Excel Version)

Attachment 5

Oakville Hydro / Milton Hydro LTLT Asset Transfer Summary

Attachment 6

Oakville Hydro Affected Customers (Section 1.4.5)

Attachment 7

Milton Hydro / Oakville Hydro LTLT Elimination – Sample Customer Letter

Attachment 1 – Milton Hydro to Oakville Hydro LTLT Maps

Legend

 Primary Wire (Milton Hydro, various colours)

 Primary Wire (not Milton Hydro)

 Milton Hydro Pole

 Privately Owned Pole

 Anchor (same ownership as pole)

 Pad mounted Transformer

 Pole mounted Transformer

 Overhead 120/240V secondary

 Overhead 120/240V service wire

 Underground 120/240V service wire

 service meter

 generation meter

Map 1 – Boundary Map

Milton Hydro / Oakville Hydro LTLT Maps Boundary Map

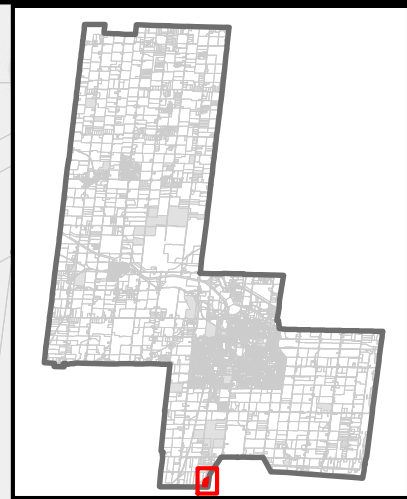
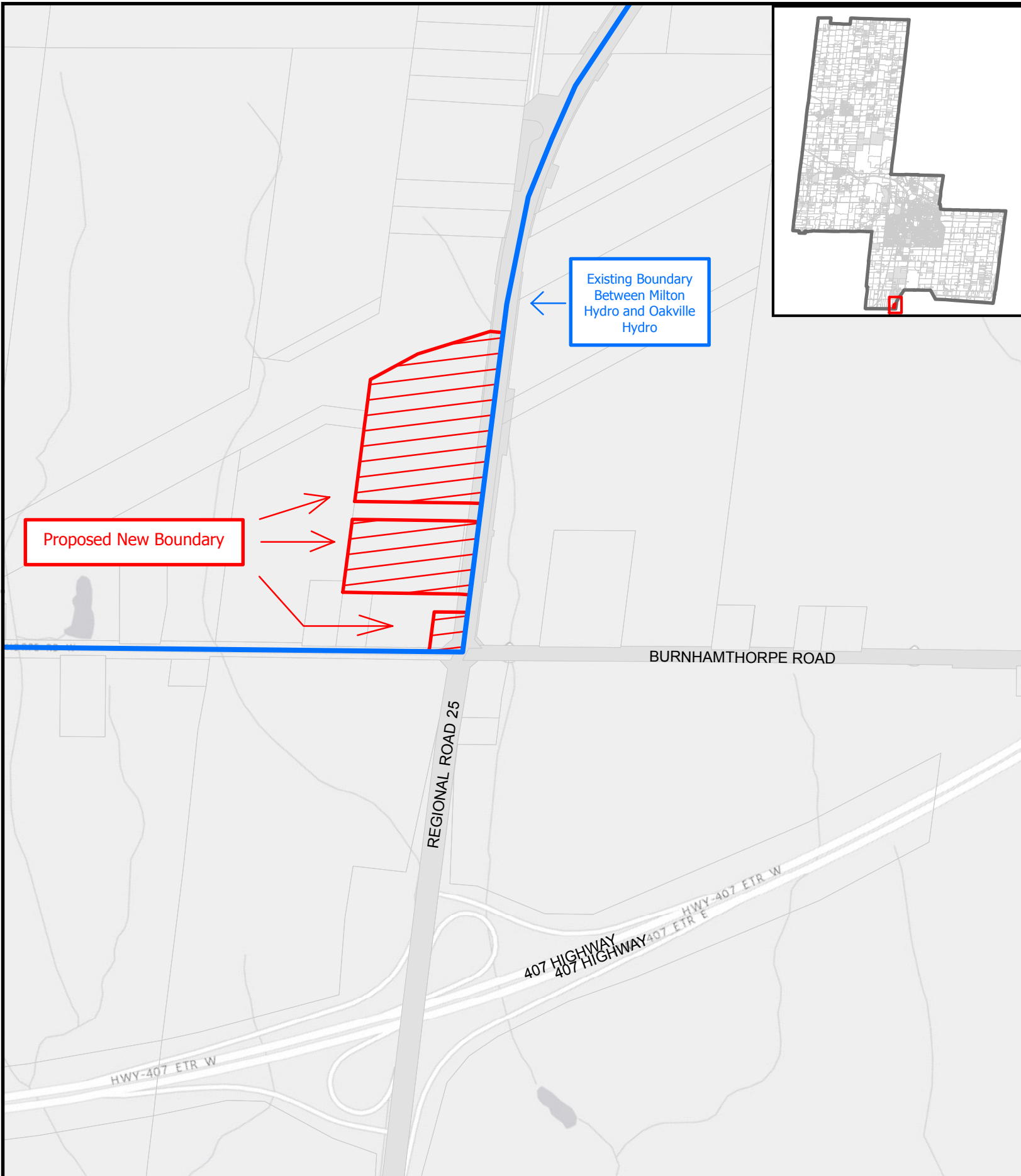

0 125 250 metres



Map 2 – Customer Account Locations

Milton Hydro / Oakville Hydro LTLT Maps Accounts Affected

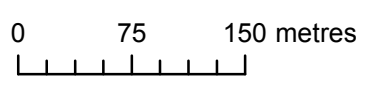
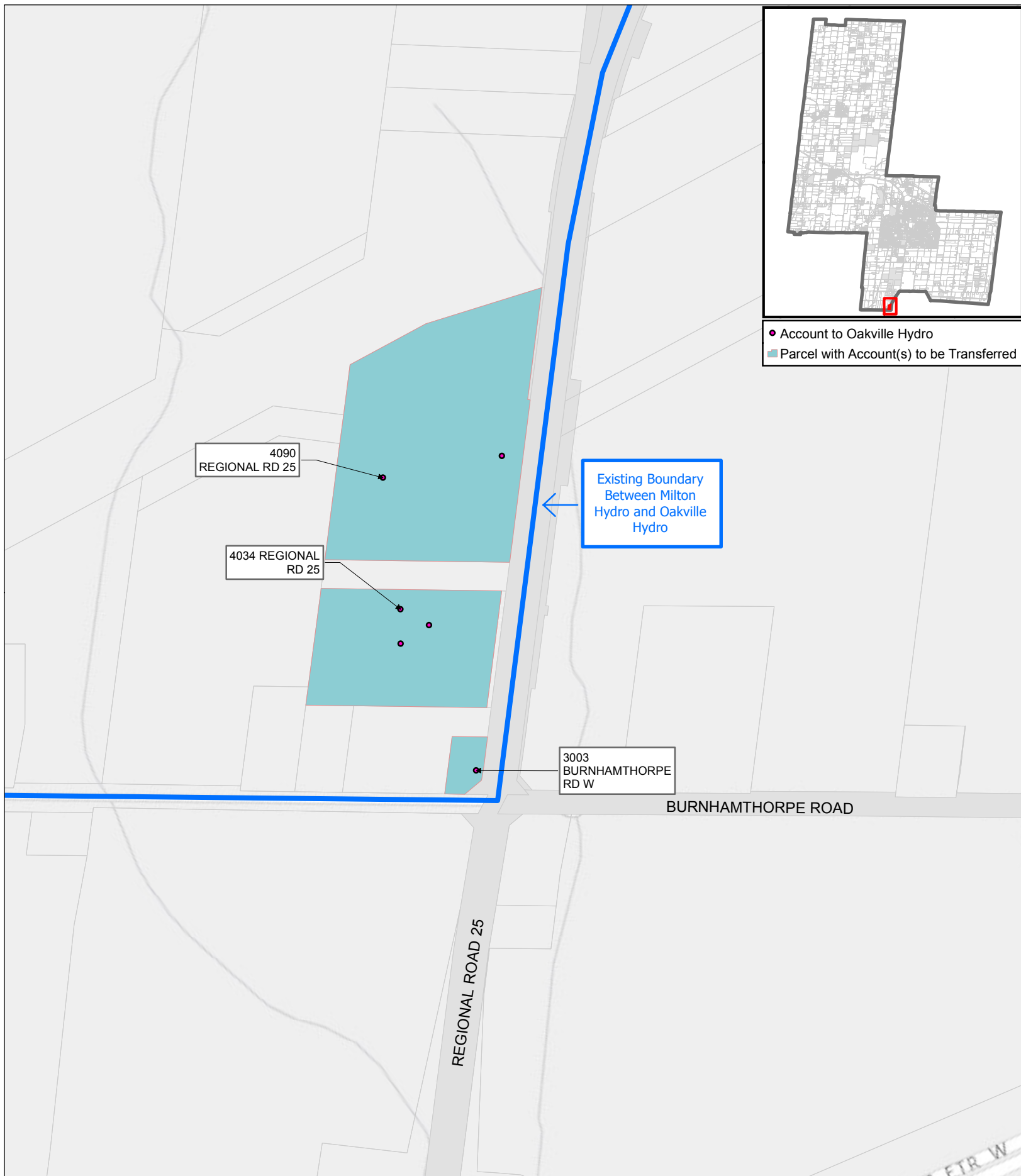
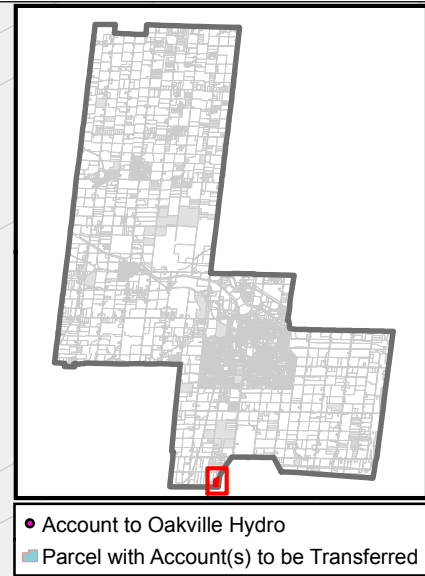

Map 3 – Service Layouts



4090

4090 REGIONAL RD 25
Account: 83180

4090

4090 REGIONAL RD 25
Account: 83190



TX 1314
25kVA

TX 1293
25kVA

REGIONAL ROAD 25

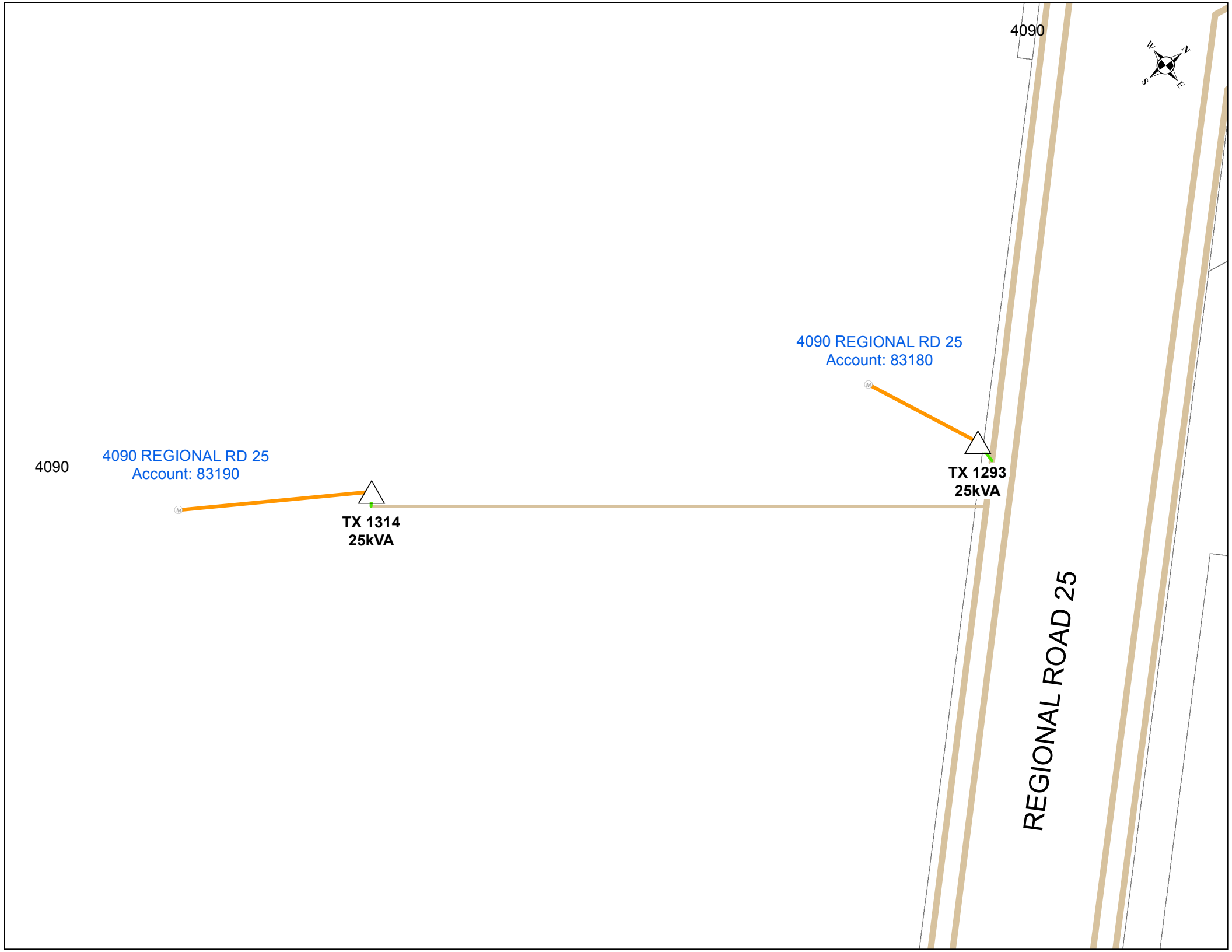



4090

4034



TX 3579
50kVA



4034 REGIONAL RD 25
Account: 83200
Account: 83210
Account: 83220

REGIONAL ROAD 25



REGIONAL ROAD 25

BURNHAMTHORPE ROAD W

TX 480
25kVA

3003 BURNHAMTHORPE RD W
Account: 83240

3029

3003

3069

3547

Attachment 2 – Oakville Hydro to Milton Hydro LTLT Maps

Map 1 – Boundary Map

1C

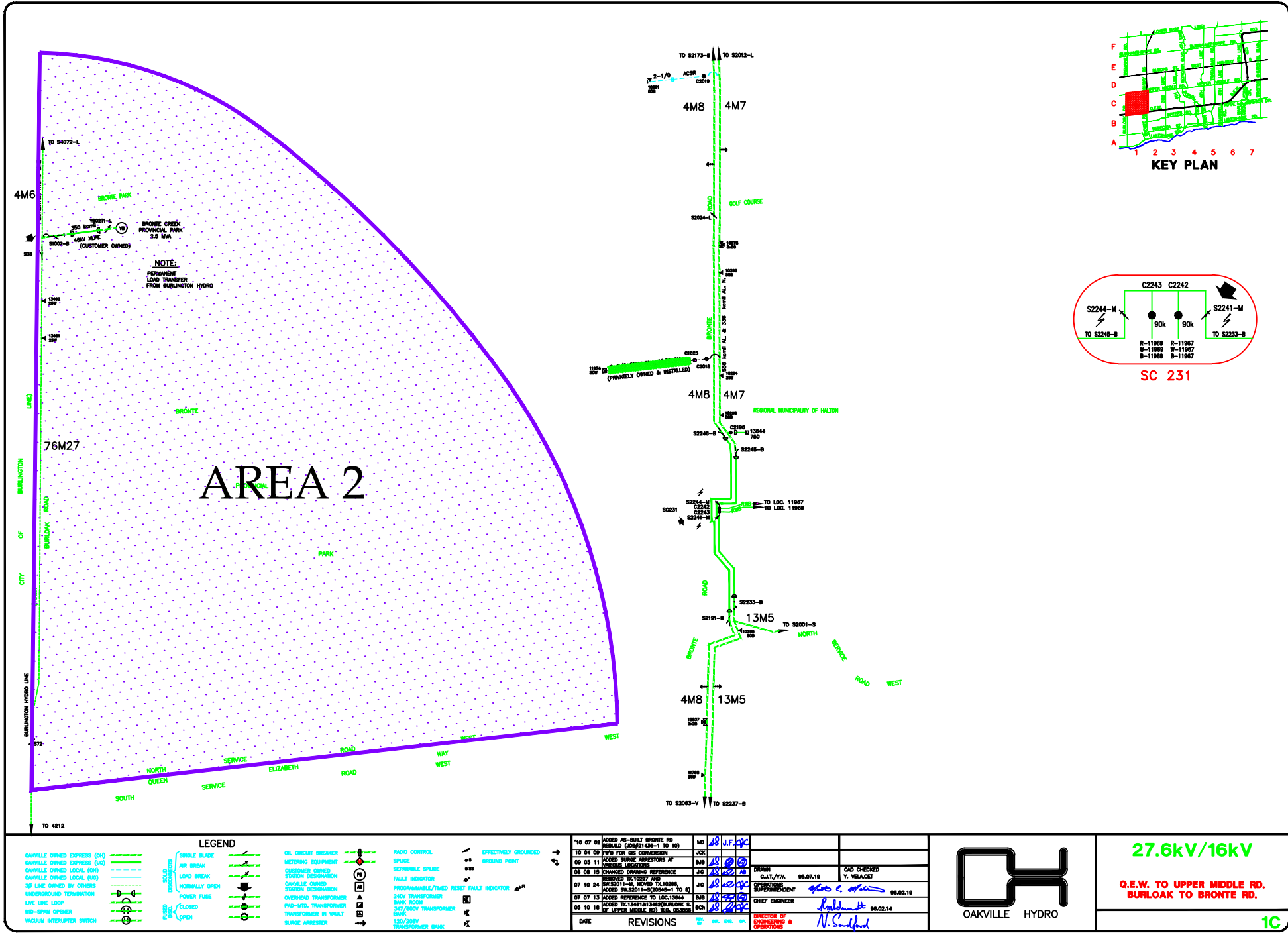

1C

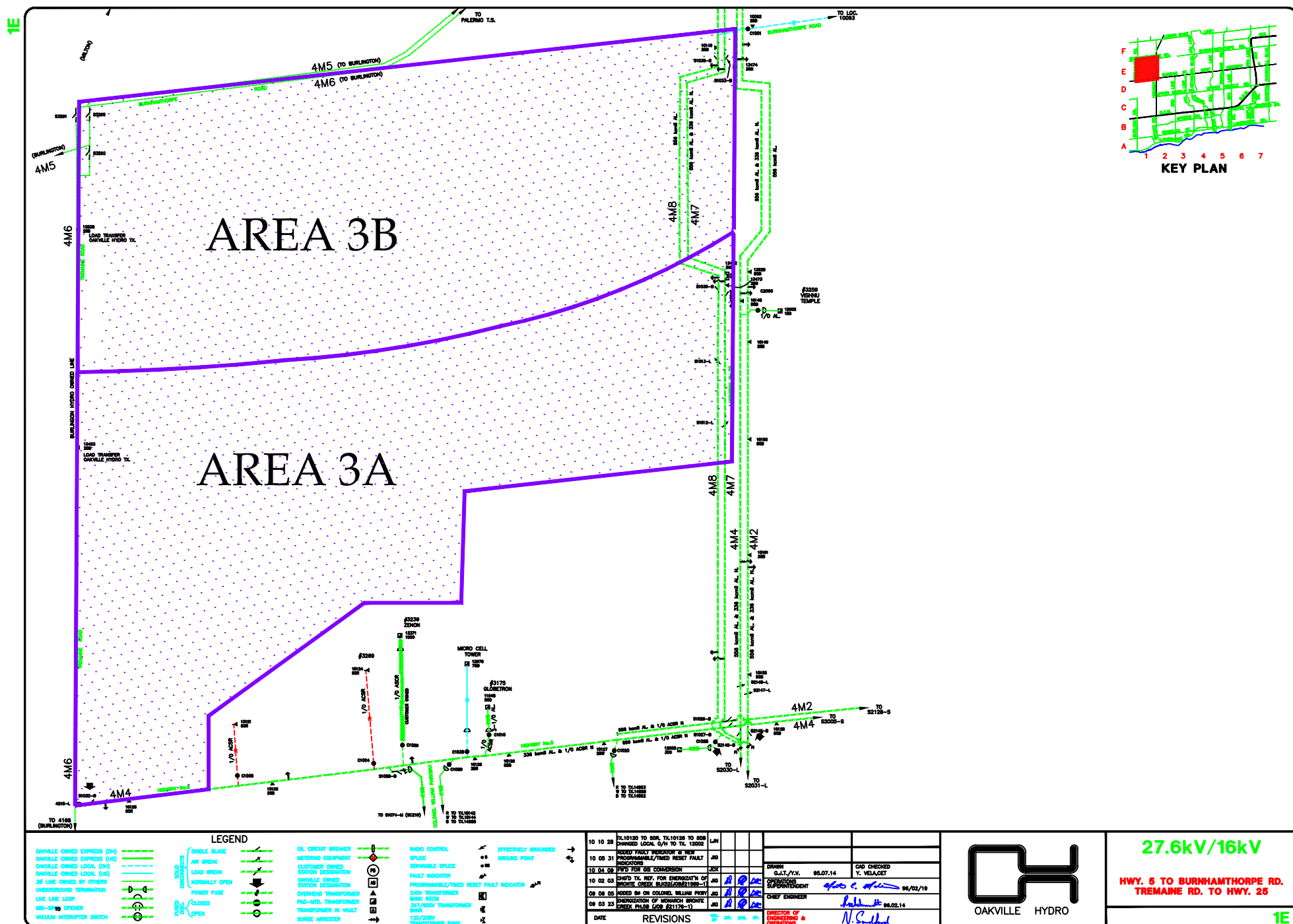





Map 2 – Customer Account Locations

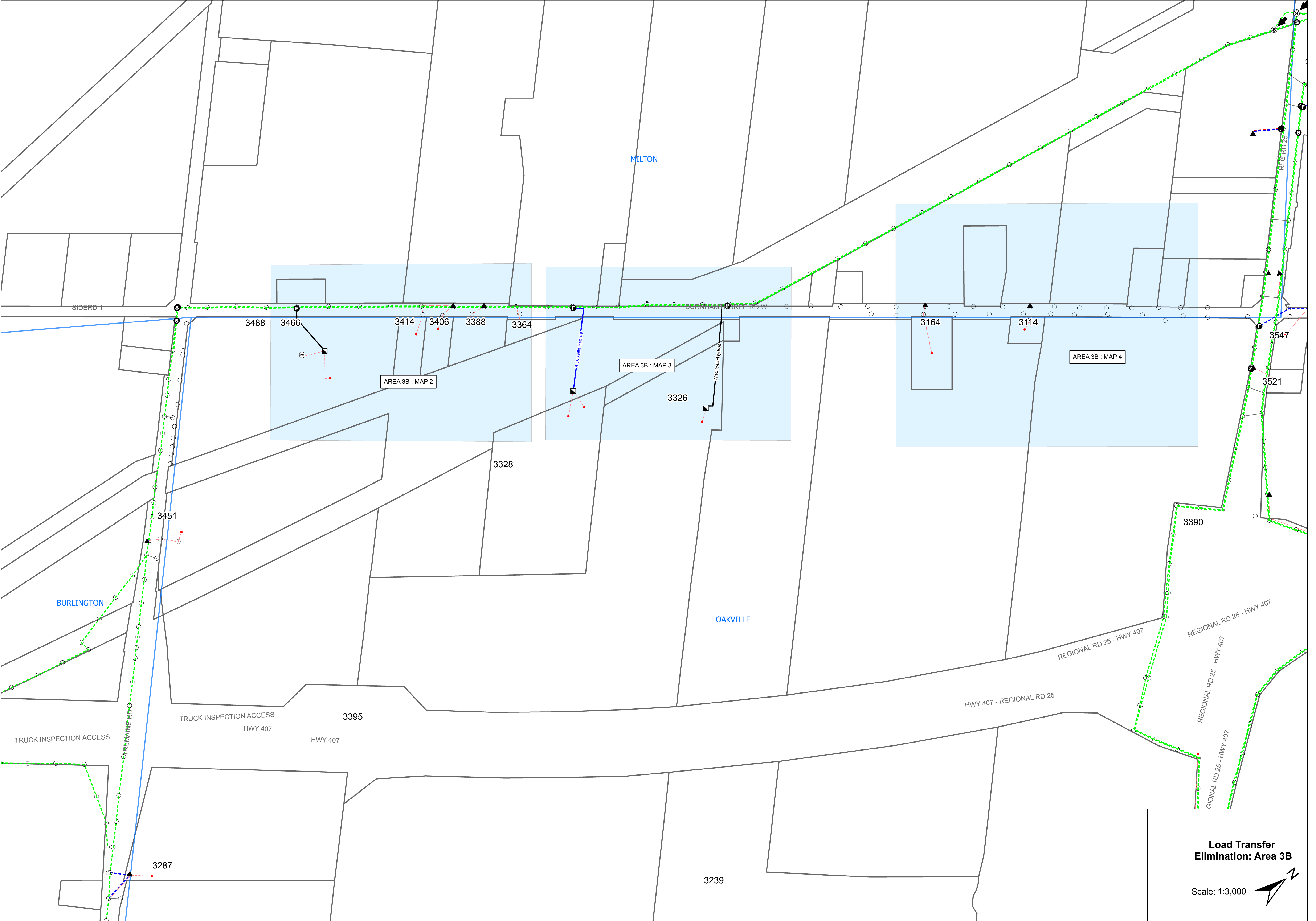

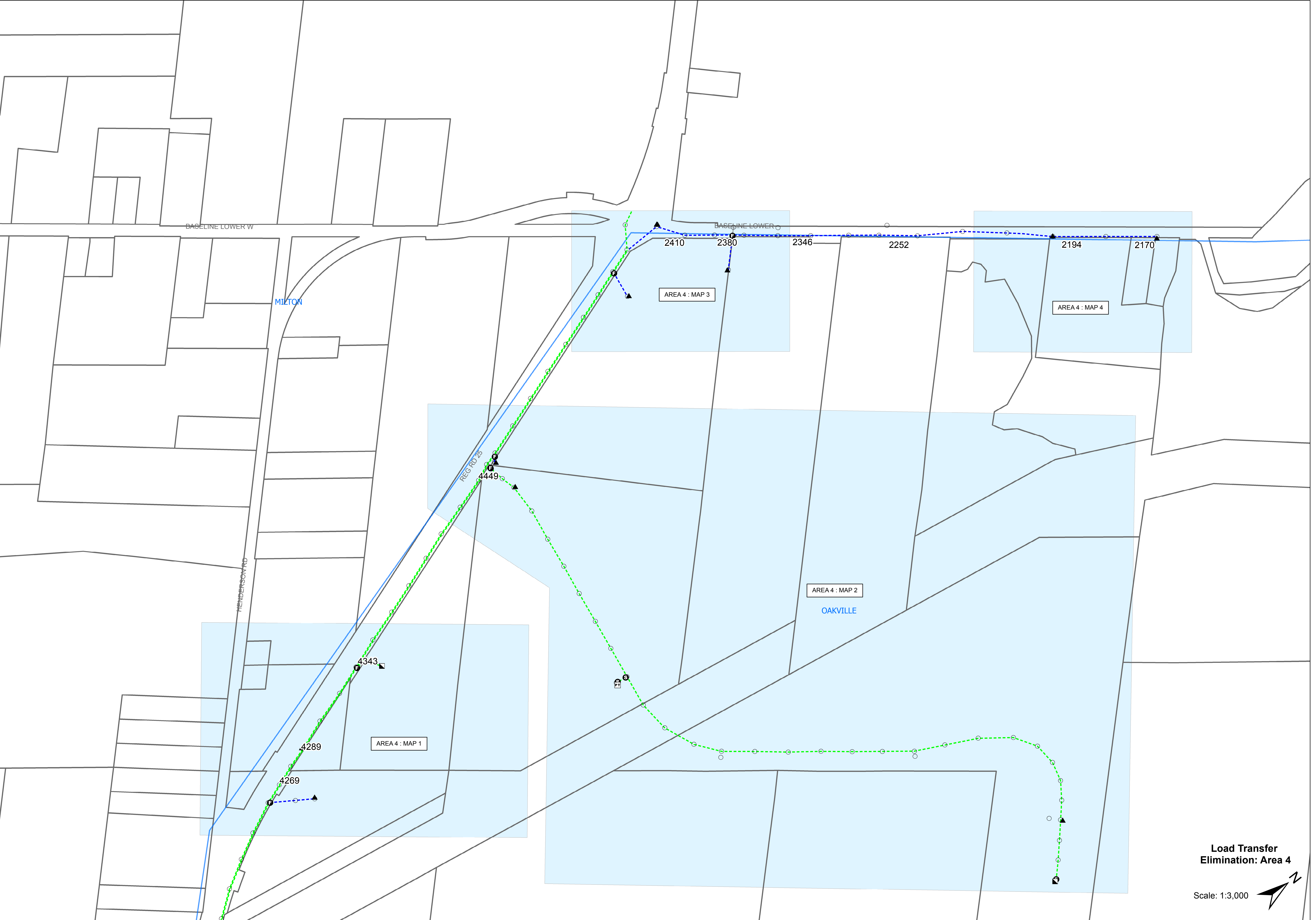

Load Transfer
Elimination: Area 4

Scale: 1:3,000

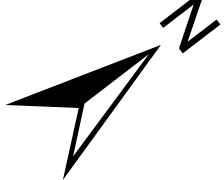

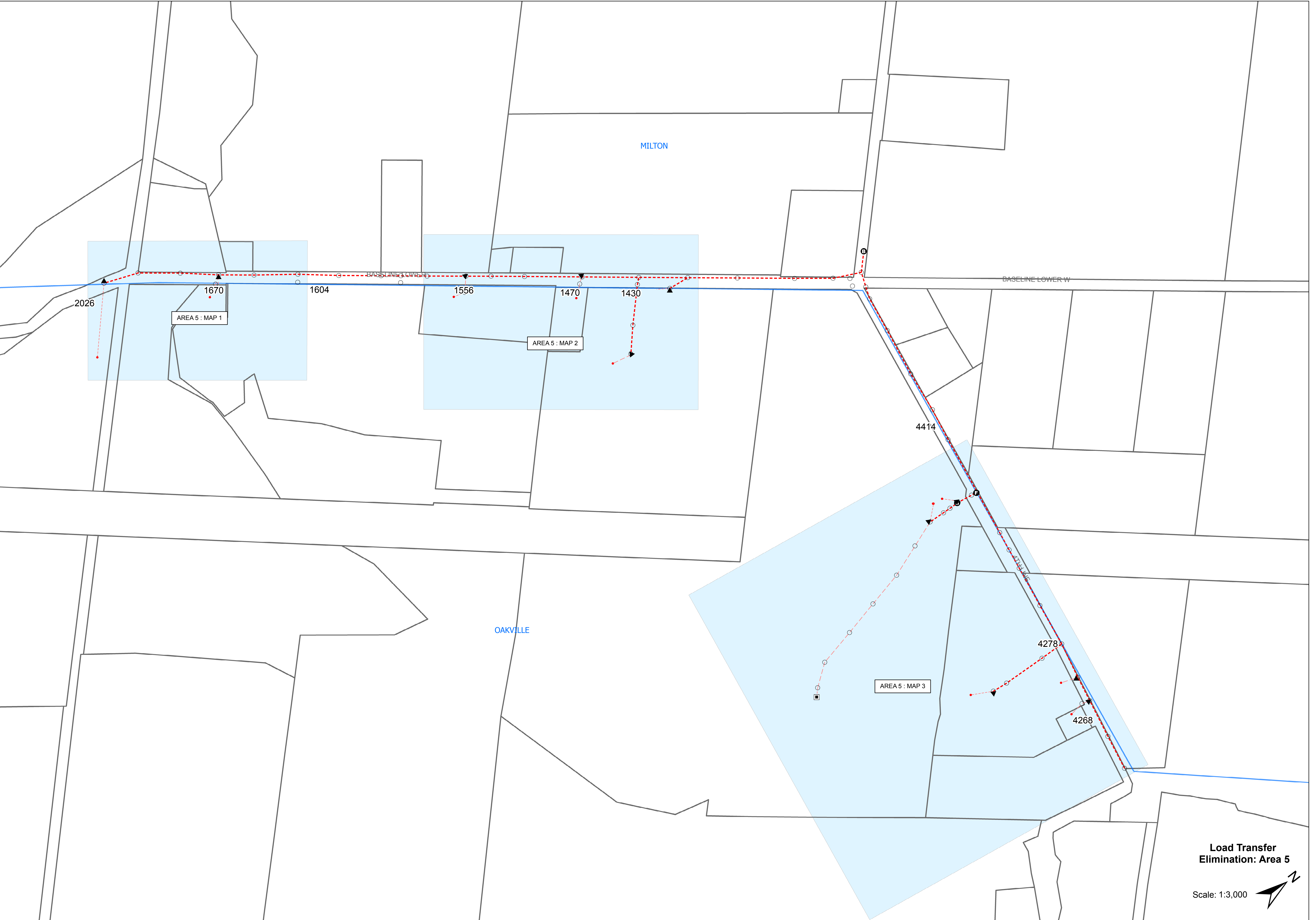

Map 3 – Service Layouts

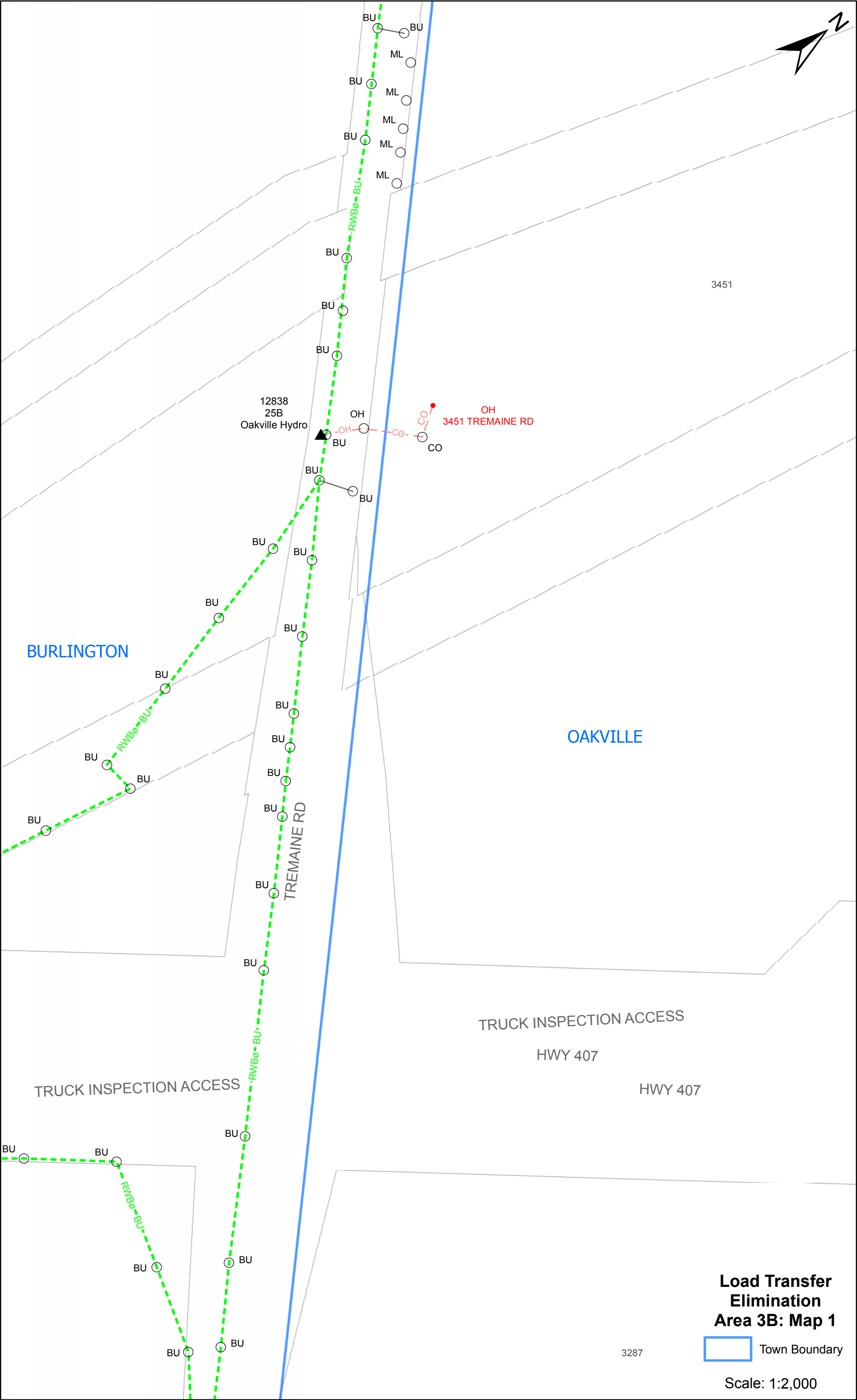

**Load Transfer
Elimination
Area 3B: Map 1**

 Town Boundary

Scale: 1:2,000

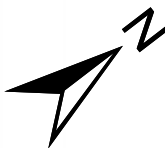
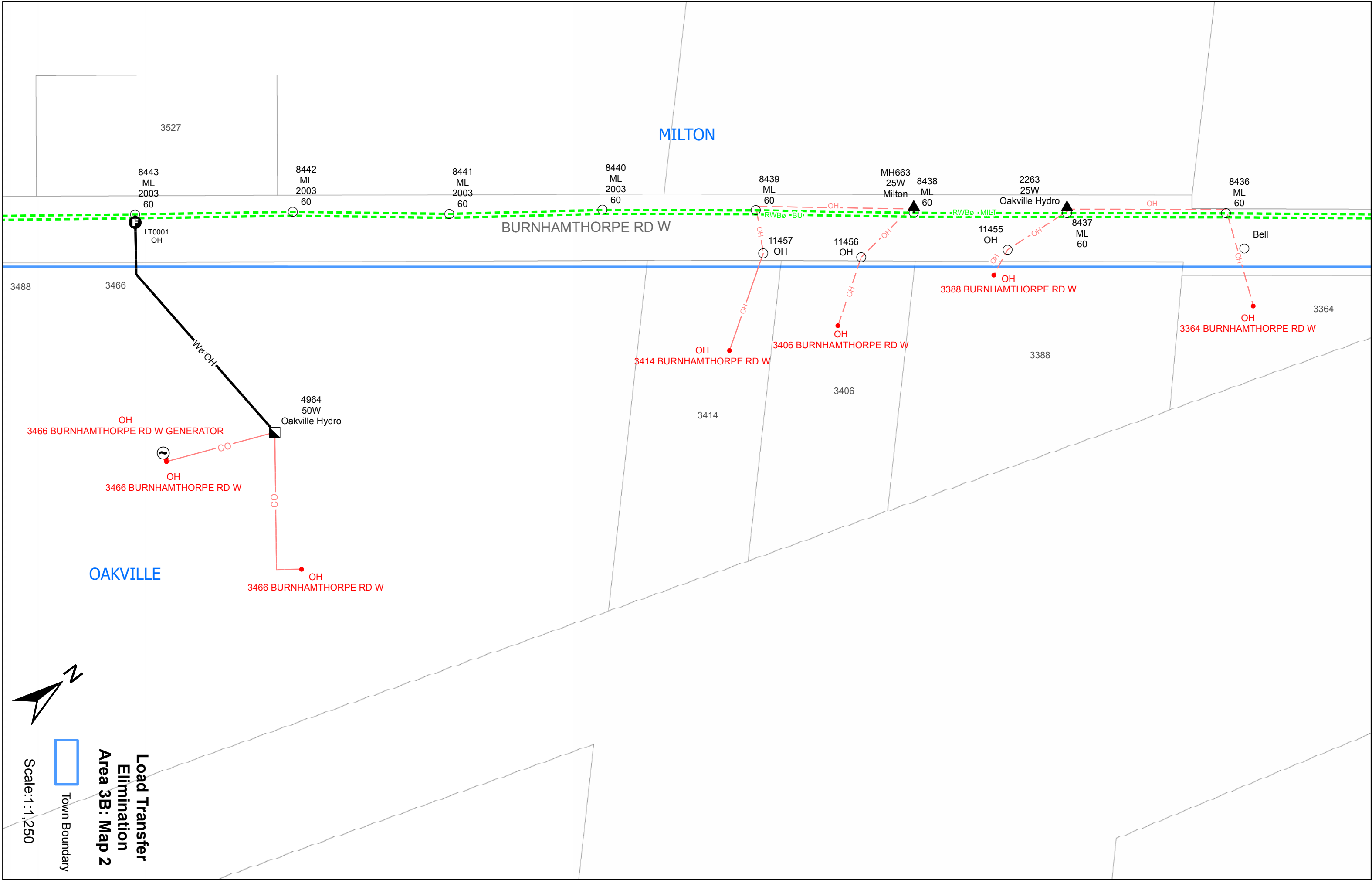

Town Boundary

Scale: 1:1,250

Load Transfer
Elimination
Area 3B: Map 2

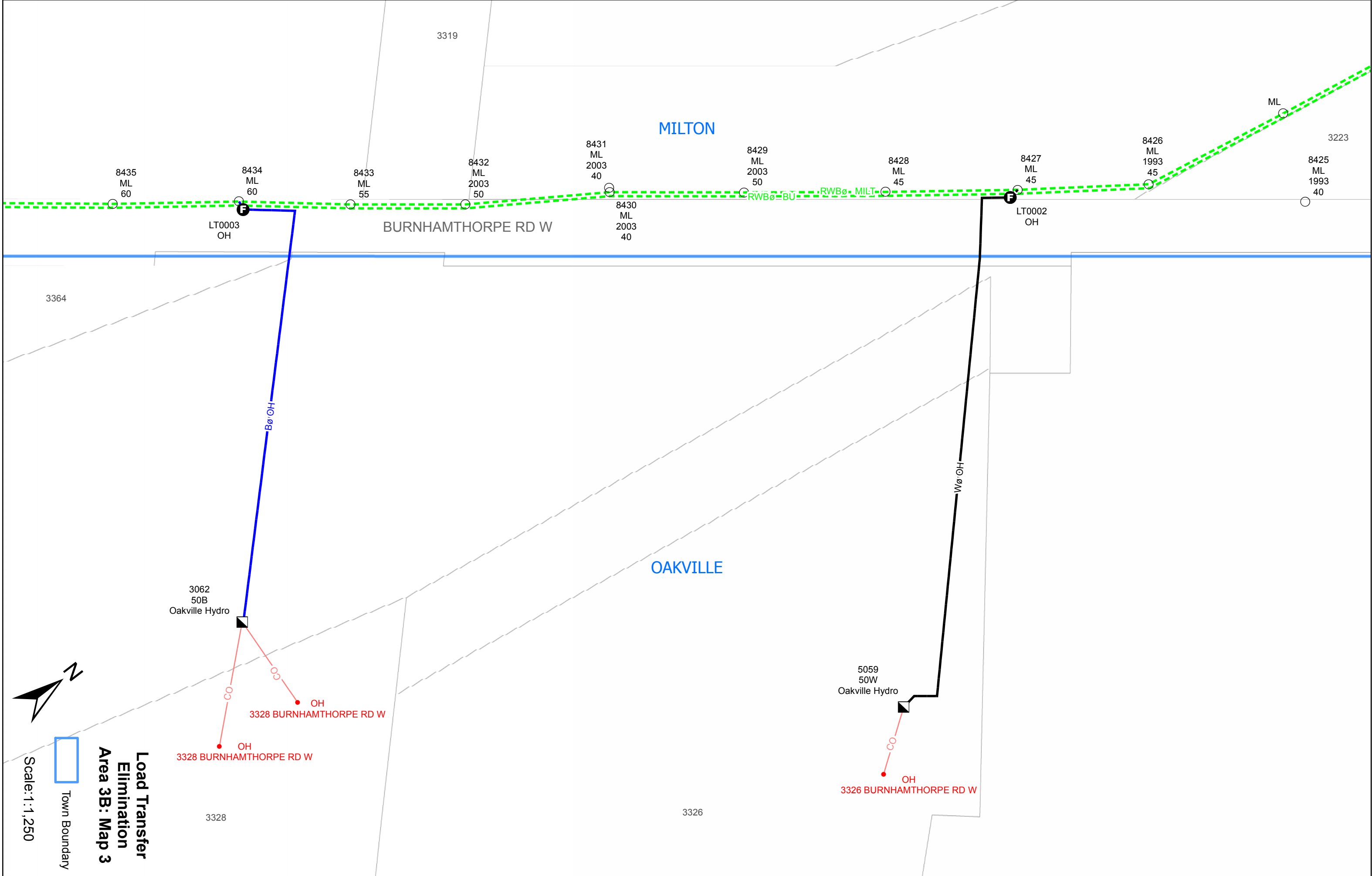

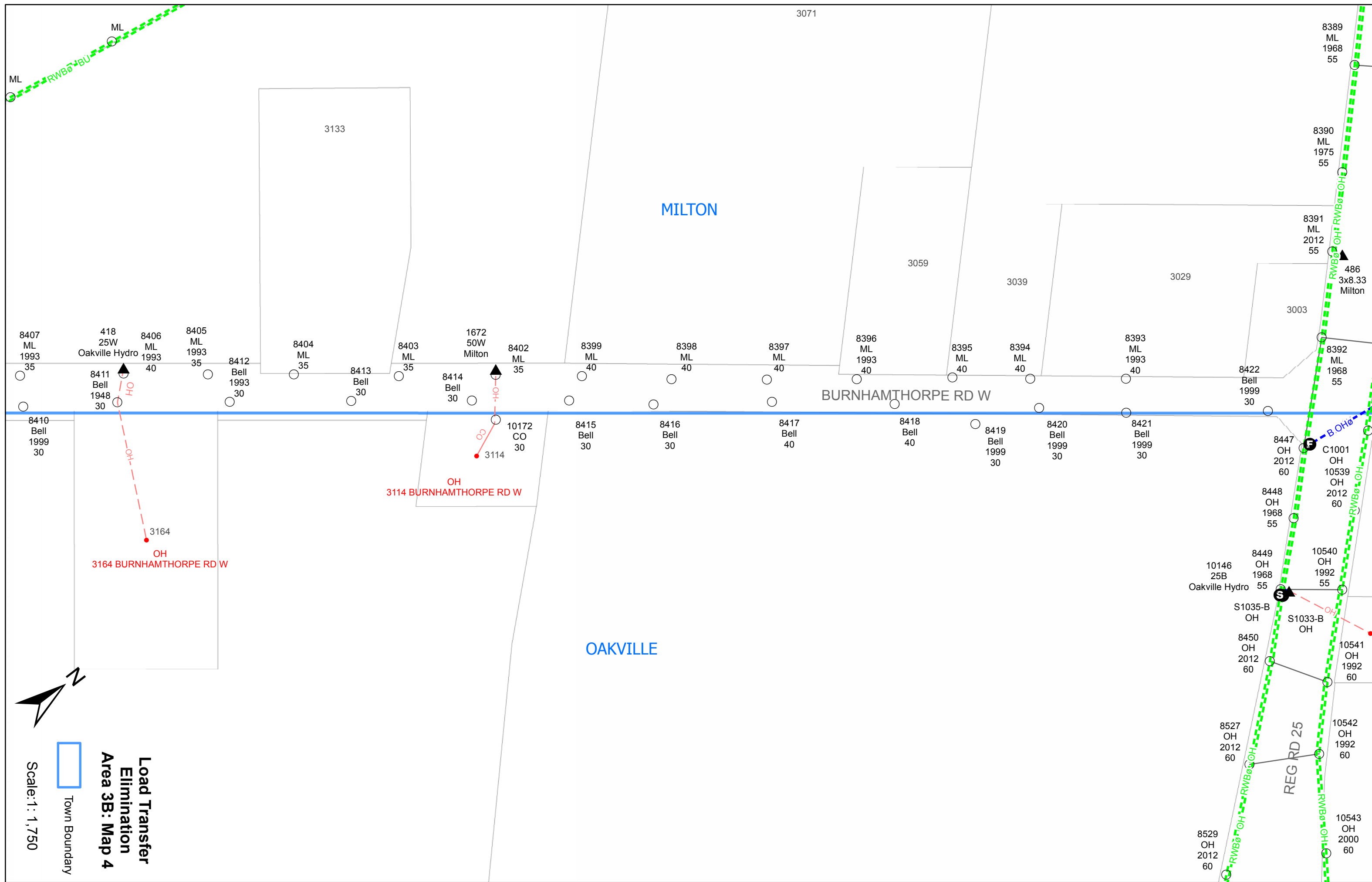

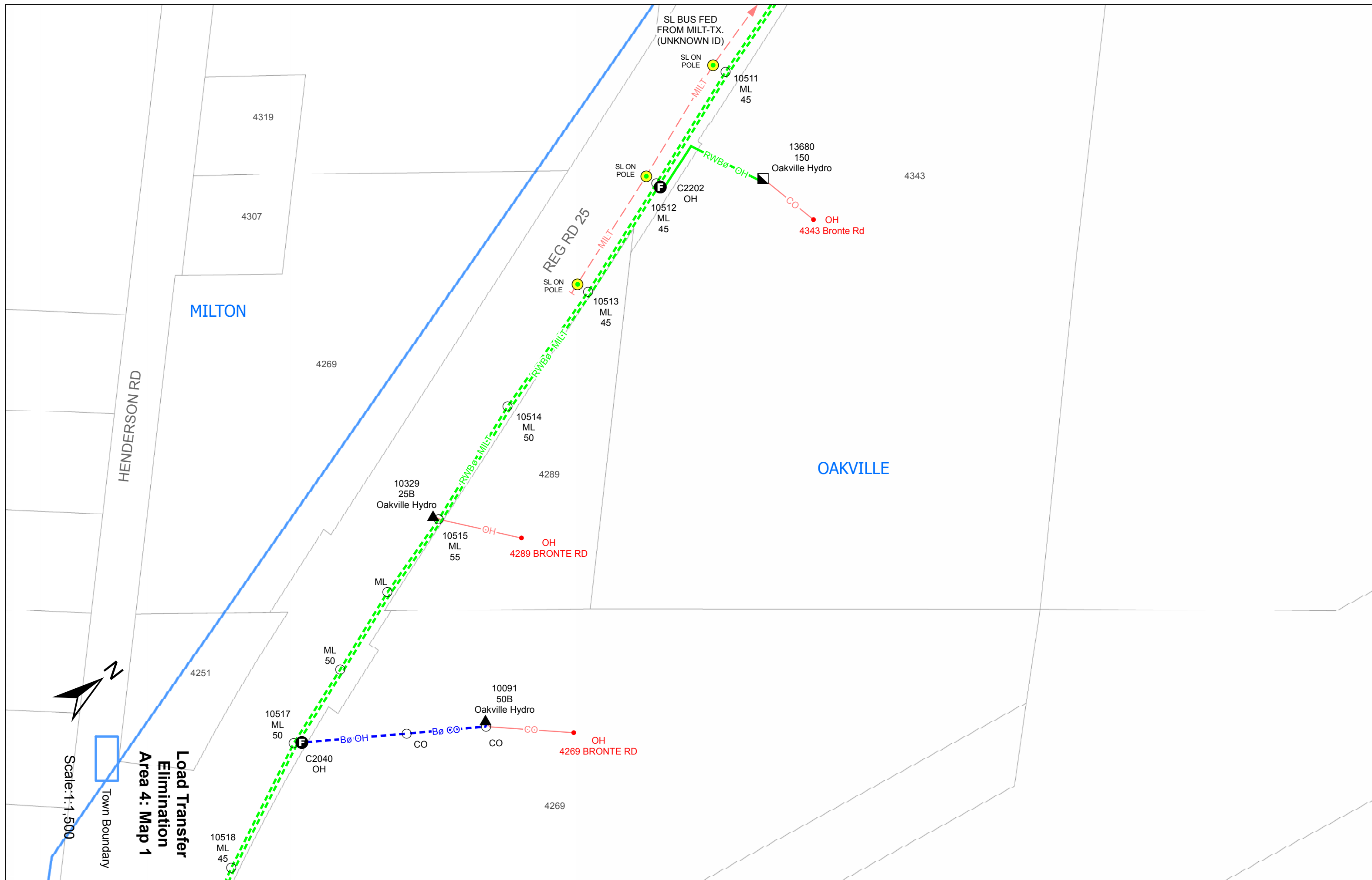

MILTON

MILTON

ML

12036
100B
Oakville Hydro

474
75B
Oakville Hydro

BASELINE LOWER

11944
OH
2012
50

Bø OH

11945
OH
2012
45

12189
OH
1985

12190
OH
1998

93X4
OH

12191
OH
1998

12192
OH
1998

Bø OH

12193
OH
1952

12194
OH
1952

2410

2380

2346

REG RD 25

ML
C2176
OH

Bø OH

CO

13165
50B
Oakville Hydro

ML

OAKVILLE

ML



Scale: 1:1,000



Town Boundary

Load Transfer
Elimination
Area 4: Map 3

OH
2410 LOWER BASE LINE RD W

OH
2410 LOWER BASELINE RD W

1145
25B
Oakville Hydro

OH
2400 LOWER BASE LINE RD W

CO

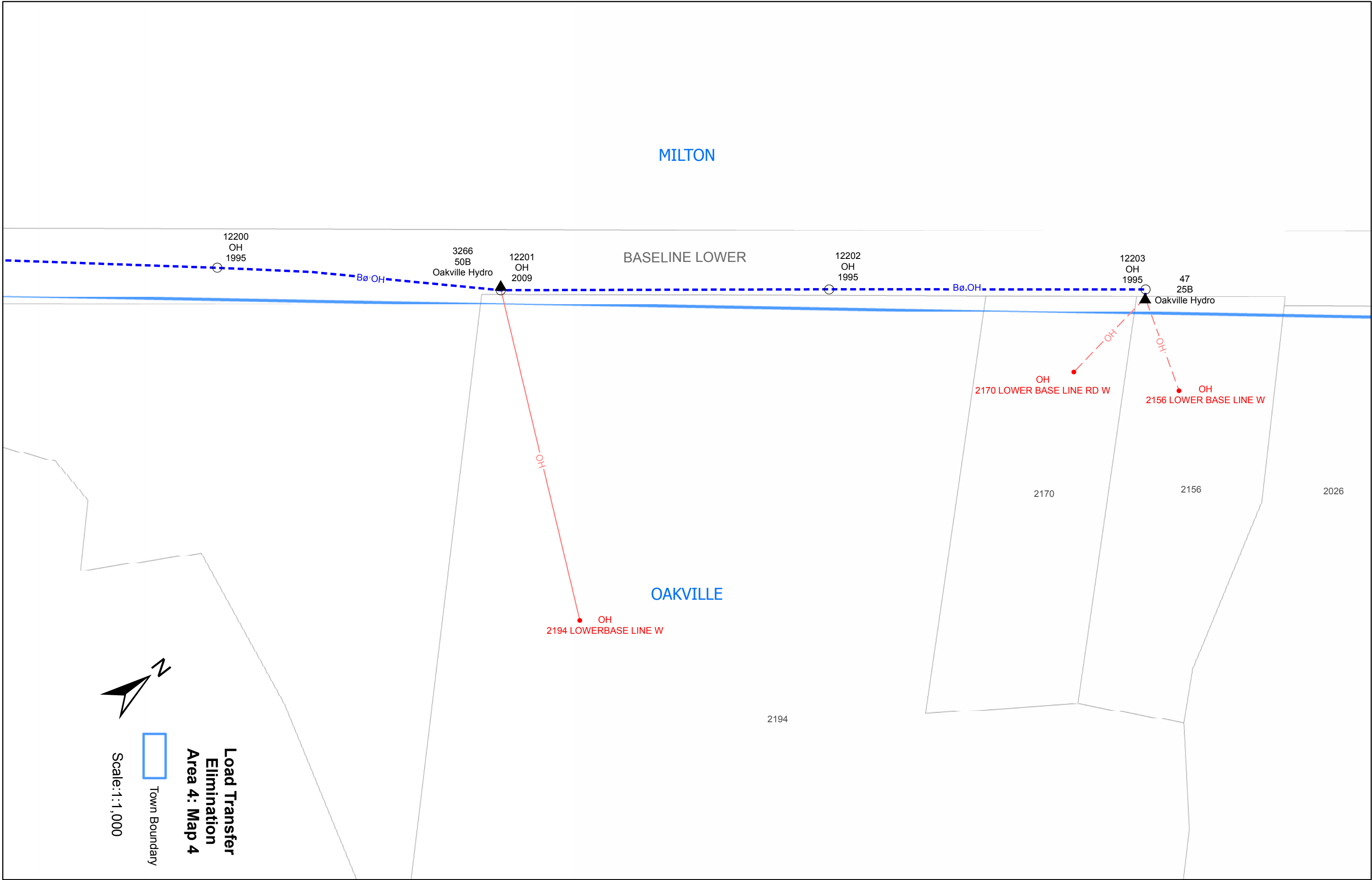

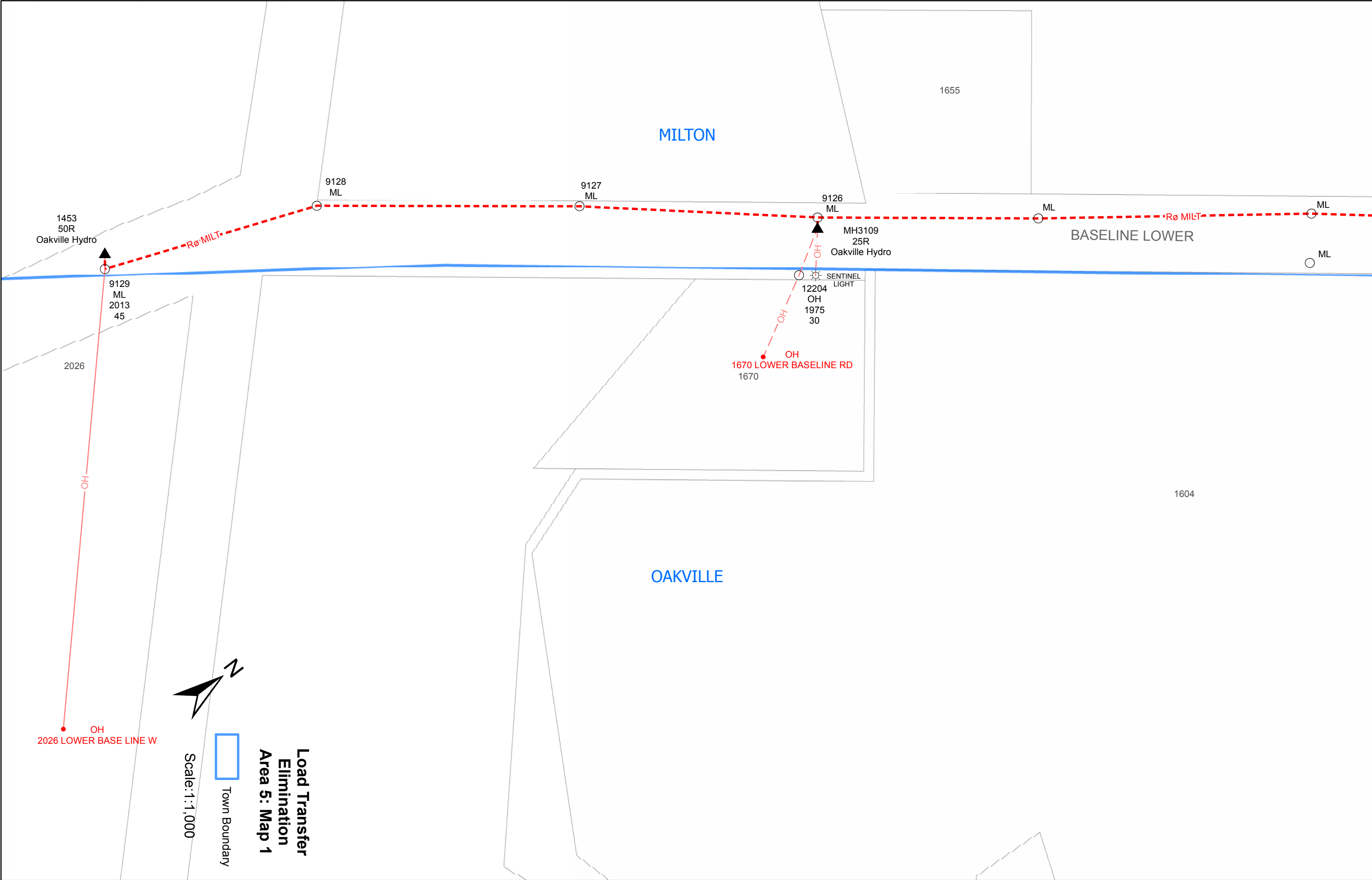

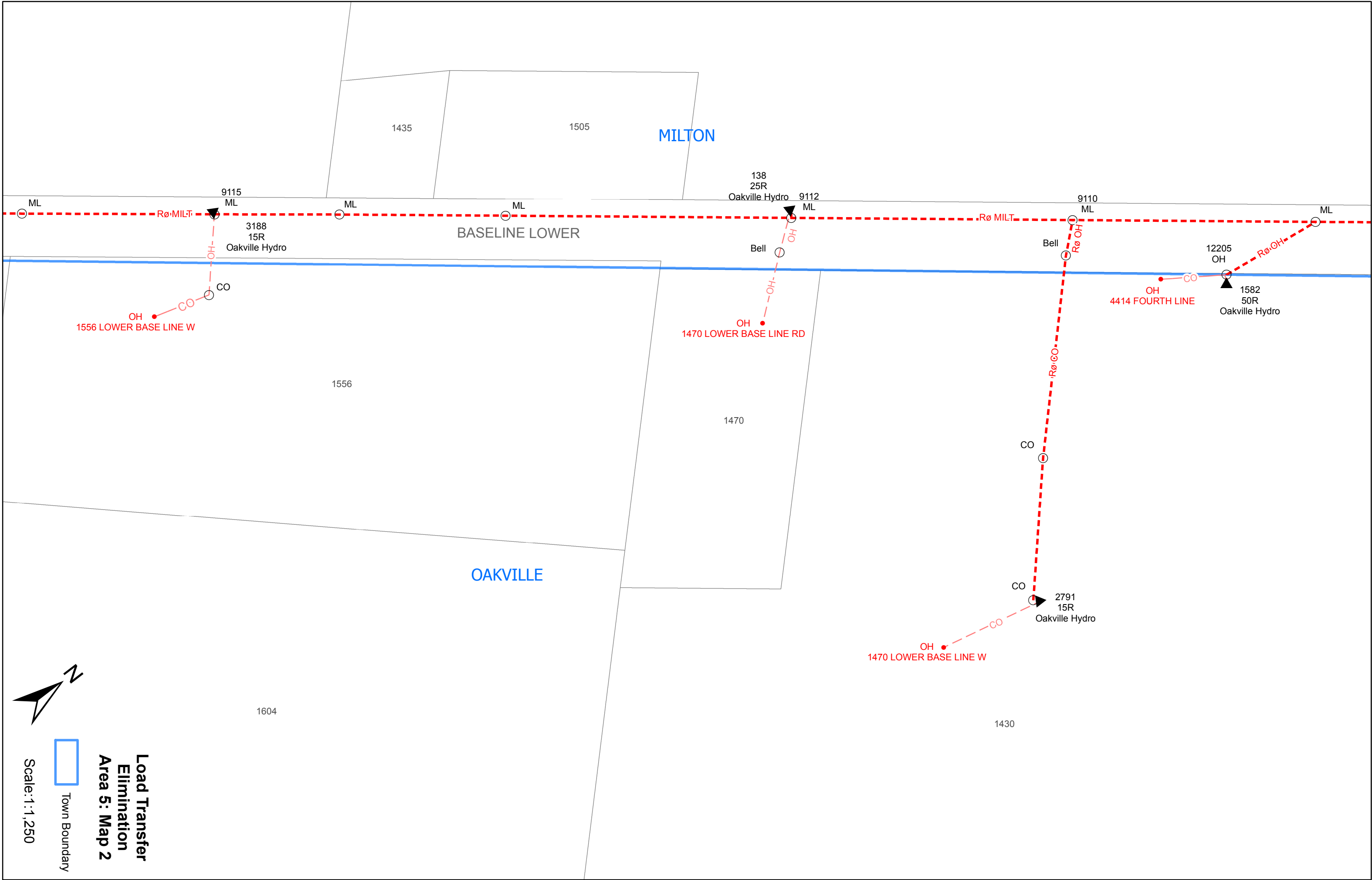

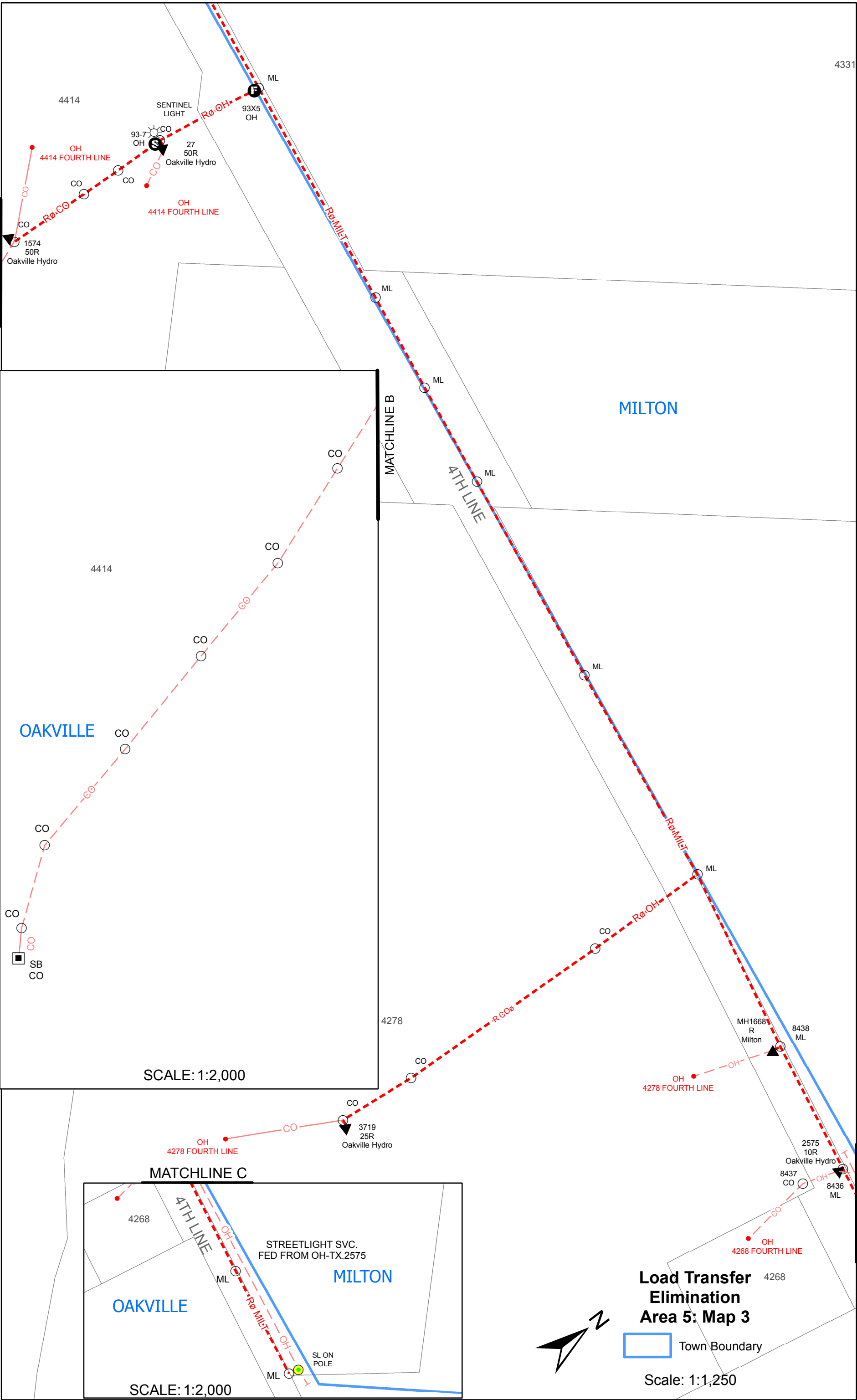

Attachment 3 – Oakville Hydro to Milton Hydro LTLT Rate Impacts

Oakville Hydro to Milton Hydro LTLT Rate Impacts

Customer	Address	Rate Class	Pricing	Monthly Consumption (Metered kWh)	Oakville Hydro			Milton Hydro			Average Monthly Delivery Impact on Total Bill (\$)
					Fixed Charge (\$)	Variable Charge (\$/kWh or \$/kW)	Delivery Charge (\$)	Fixed Charge (\$)	Variable Charge (\$/kWh or \$/kW)	Delivery Charge (\$)	
1	3364 Burnhamthorpe Road West	Residential	TOU	1,203	\$21.95	\$0.0082	\$54.20	\$21.70	\$0.0074	\$52.59	(\$1.61)
2	3388 Burnhamthorpe Road West	Residential	TOU	2,174	\$21.95	\$0.0082	\$80.21	\$21.70	\$0.0074	\$77.51	(\$2.71)
3	3406 Burnhamthorpe Road West	Residential	TOU	1,371	\$21.95	\$0.0082	\$58.68	\$21.70	\$0.0074	\$56.88	(\$1.80)
4	3414 Burnhamthorpe Road West	Residential	TOU	2,409	\$21.95	\$0.0082	\$86.50	\$21.70	\$0.0074	\$83.52	(\$2.98)
5	3466 Burnhamthorpe Road West	Residential	TOU	970	\$21.95	\$0.0082	\$47.95	\$21.70	\$0.0074	\$46.61	(\$1.34)
6	3466 Burnhamthorpe Road West	GS<50	TOU	1,153	\$36.26	\$0.0161	\$74.84	\$16.77	\$0.0177	\$56.70	(\$18.15)
7	3466 Burnhamthorpe Road West	microFIT			\$5.40			\$5.40			\$0.00
8	3326 Burnhamthorpe Road West	GS<50	TOU	4,781	\$36.26	\$0.0161	\$196.21	\$16.77	\$0.0177	\$182.27	(\$13.94)
9	3328 Burnhamthorpe Road West	Residential	TOU	2,043	\$21.95	\$0.0082	\$76.69	\$21.70	\$0.0074	\$74.12	(\$2.57)
10	3328 Burnhamthorpe Road West	GS<50	TOU	1,843	\$36.26	\$0.0161	\$97.92	\$16.77	\$0.0177	\$80.57	(\$17.35)
11	3114 Burnhamthorpe Road West	Residential	TOU	2,157	\$21.95	\$0.0082	\$71.33	\$21.70	\$0.0074	\$69.00	(\$2.34)
12	3164 Burnhamthorpe Road West	Residential	TOU	1,134	\$21.95	\$0.0082	\$52.34	\$21.70	\$0.0074	\$50.81	(\$1.53)
13	4269 Bronte Road	Residential	TOU	2,149	\$21.95	\$0.0082	\$79.54	\$21.70	\$0.0074	\$76.86	(\$2.68)
14	4289 Bronte Road	Residential	TOU	1,764	\$21.95	\$0.0082	\$69.22	\$21.70	\$0.0074	\$66.97	(\$2.25)
15	4343 Bronte Road	GS<50	TOU	4,164	\$36.26	\$0.0161	\$157.78	\$16.77	\$0.0177	\$142.51	(\$15.27)
16	2410 Lower Base Line West	GS<50	TOU	2,218	\$36.26	\$0.0161	\$110.46	\$16.77	\$0.0177	\$93.55	(\$16.92)
17	4449 Bronte Road	GS>50		80,381	\$123.74	\$4.8388	\$2,857.48	\$79.23	\$3.0569	\$2,748.08	(\$109.40)
18	2400 Lower Base Line Road West	Residential	TOU	1,460	\$21.95	\$0.0082	\$61.06	\$21.70	\$0.0074	\$59.16	(\$1.91)
19	2410 Lower Base Line West	GS<50	TOU	12,780	\$36.26	\$0.0161	\$56.57	\$16.77	\$0.0177	\$37.79	(\$18.78)
20	2410 Lower Base Line Road West	Residential	TOU	210	\$21.95	\$0.0082	\$27.57	\$21.70	\$0.0074	\$27.09	(\$0.48)
21	2156 Lower Base Line West	Residential	TOU	1,043	\$21.95	\$0.0082	\$49.91	\$21.70	\$0.0074	\$48.47	(\$1.44)
22	2170 Lower Base Line Road West	Residential	TOU	1,197	\$21.95	\$0.0082	\$54.02	\$21.70	\$0.0074	\$52.42	(\$1.60)
23	2194 Lower Base Line West	Residential	TOU	1,070	\$21.95	\$0.0082	\$50.63	\$21.70	\$0.0074	\$49.16	(\$1.46)
24	1670 Lower Base Line Road	Residential	TOU	1,614	\$21.95	\$0.0082	\$65.20	\$21.70	\$0.0074	\$63.13	(\$2.07)
25	2026 Lower Base Line West	GS<50	TOU	607	\$36.26	\$0.0161	\$175.56	\$16.77	\$0.0177	\$160.91	(\$14.65)
26	1470 Lower Base Line Road	Residential	TOU	2,022	\$21.95	\$0.0082	\$76.14	\$21.70	\$0.0074	\$73.60	(\$2.54)
27	1470 Lower Base Line West	Residential	TOU	2,582	\$21.95	\$0.0082	\$91.13	\$21.70	\$0.0074	\$87.95	(\$3.17)
28	1556 Lower Base Line West	Residential	TOU	1,930	\$21.95	\$0.0082	\$73.68	\$21.70	\$0.0074	\$71.25	(\$2.43)
29	4268 Fourth Line	Residential	TOU	923	\$21.95	\$0.0082	\$46.68	\$21.70	\$0.0074	\$45.39	(\$1.29)
30	4278 Fourth Line	Residential	TOU	1,628	\$21.95	\$0.0082	\$65.58	\$21.70	\$0.0074	\$63.49	(\$2.10)
31	4278 Fourth Line	GS<50	TOU	161	\$36.26	\$0.0161	\$41.64	\$16.77	\$0.0177	\$22.34	(\$19.30)
32	4414 Fourth Line	GS<50	TOU	2,767	\$36.26	\$0.0161	\$96.26	\$16.77	\$0.0177	\$78.86	(\$17.40)
33	4414 Fourth Line	GS<50	TOU	3,632	\$36.26	\$0.0161	\$463.80	\$16.77	\$0.0177	\$459.15	(\$4.65)
34	4414 Fourth Line	GS<50	TOU	1,794	\$36.26	\$0.0161	\$128.83	\$16.77	\$0.0177	\$112.55	(\$16.27)

Attachment 4 – Milton Hydro / Oakville Hydro Asset Transfer Spreadsheet

Geographical Distributor LTLT Customer and Asset Transfer Information

[illegible]

[illegible]

(years)	Value from Residual Value Table	Road Crossing Wire Owner (Physical/Geo)	Private Property Wire Owner (Physical/Geo/Customer)	Wire Dollar Value from "Figure Number"	Transformer Owner (Physical/Geo/Customer)	Transformer Ownership Credit (Y/N)	Transformer ID	Transformer Age (years)	If Transformer contains PCBs, or Pre 1980 and not known, apply \$250 Credit	Transformer Size (kVA)	Transformer Phases (1/3)	Transformer Secondary Voltage (V)	Transformer Asset Value from table	Number of Secondary Bus Spans	Secondary Bus Value (\$180/Spn)	Sentinel Light Owner (Geo/Customer)	Sentinel Light-Bulb Wattage (W)	Type of Light	Ballast Size	Sentinel Light*
Wire			Transformer Information										Secondary Bus		Sentinel Light					
	Geographic DC	\$150.00	Geographic DC		1293	17		25	1	120/240	\$2,531.00									
	Customer	\$0.00	Geographic DC		1314	9		25	1	120/240	\$3,038.00									
																Geographic	70		30	\$100.00
																Geographic	70		30	\$100.00
	Customer	\$0.00	Geographic DC		3579	25		50	1	120/240	\$1,819.00									
	Customer	\$0.00	Geographic DC		3579															
	Customer	\$0.00	Geographic DC		3579															
	Geographic DC	\$150.00	Geographic DC		480	32		25	1	120/240	\$1,013.00									
		\$300.00										\$8,401.00		\$0.00						\$200.00

[illegible]

[illegible]

[illegible]

Y/N	Language	Qty	Classification Figure	Ownership
Y	E	1	Fig.1	Physical DC
N	F	2	Fig.2	Geographic DC
		3	Fig.3	Customer
			Fig.4	
			Fig.5	
			Fig.6	
			Fig.7	
			Fig.8	
			Fig.9	
			Fig.10	
			Fig.11	
			Fig.12	
			Fig.13	
			Fig.14	
			Fig.15	
			Fig.16	
			Special #1	
			Special #2	
			Special #3	
			Special #4	
			Special #5	
			Special #6	
			Special #7	
			Special #8	
			Special #9	
			Special #10	
			Special #11	
			Special #12	
			Special #13	
			Special #14	
			Special #15	
			Special #16	

Orientation	Class	Txf	No. of Phases	Txf Secondary V	Secondary Service Gauge
OH	Primary	Shared	1	120	#4
UG	Secondary	Unique	3	240	1/0
				120/208	2/0
				120/240	3/0
				347	4/0
				600	
				347/600	

Rate Class	Trans PCB	Consumption
General Svc Energy 2TIER RPP	N/A (\$250)	Estimated
Medium Density Residential - TOU RPP		Actual
Low Density Residential- TOU RPP		
Low Density Residential - 2TIER RPP		
Sentinel Light 2TIER RPP		
General Svc Energy TOU RPP		
Low Density Residential - DCB		
General Svc Energy DCB		
Microfit Charge		
MICROFIT for generation payments		
Urban Residential - TOU RPP		
Urban Residential - DCB		
Urban Gen Svc Energy TOU RPP		
SCOMM		
RES		

NAME OF STREET/SUBDIVISION

If many streets involved, provide names of all the streets.

Summary of Assets to be Sold

Poles					
Quantity	Height	Age	Set	Residual Value	Total Asset Value
			Earth Plus		\$0.00
			Earth Plus		\$0.00
			Earth Plus		\$0.00
			Earth Plus		\$0.00
			Earth Plus		\$0.00
			Earth Plus		\$0.00
			Earth Plus		\$0.00
0					\$0.00

Primary and Neutral - Wire					
Location	Line Length (m)	# of Phases	Total Length (m)	Price/metre	Total Asset Value
				\$3.00	\$0.00
				\$3.00	\$0.00
Totals	0		0		\$0.00

Buss - Wire			
Location	# of Spans	Price/span	Total Asset Value
		\$180.00	\$0.00
		\$180.00	\$0.00
		\$180.00	\$0.00
Totals	0		\$0.00

Secondary Services to Premise			
Location	Figure #	Price/Premise	Total Asset Value
			\$0.00
			\$0.00
			\$0.00
			\$0.00
			\$0.00
Totals			\$0.00

Transformers				
Quantity	Age	Size (KVA)	Residual Value	Total Asset Value
				\$0.00
				\$0.00
				\$0.00
0				\$0.00

	Figure #1	Figure #2	Figure #3	Figure #4	Figure #5	Figure #6	Figure #7	Figure #8	Figure #9	Figure #10	Figure #11	Figure #12	Figure #13	Figure #14	Figure #15	Primary Wire Line
Main Page	0	0	0	0	0	2	0	0	0	0	0	0	0	4	0	
Special Case #1																
Special Case #2																
Special Case #3																
Special Case #4																
Special Case #5																
Special Case #6																
O/H	20	70	20	70		50		50		63		63				
U/G	63		63		63		63		63		63					
Primary										20				20		
Neutral										20				20		
Subtotal	0	0	0	0	0	2	0	0	0	0	0	0	0	4	0	0
Total O/H	0	0	0	0	0	100	0	0	0	0	0	0	0	0	0	Total Secondary O/H (m)
Total U/G	0	0	0	0	0	0	0	0	0	0	0	0	0	0	0	Total Secondary U/G (m)
Total Primary	0	0	0	0	0	0	0	0	0	0	0	0	0	0	0	Total Primary (m)
Total Buss (m)	0															

POLES	30	35	40	45	50	55	Total
Main Page	0	0	0	0	0	0	0
Special Case #1							0
Special Case #2							0
Special Case #3							0
Special Case #4							0
Special Case #5							0
Special Case #6							0
TOTAL	0	0	0	0	0	0	0

Transformers	5	10	15	25	50	75	100	167	Total
Main Page	0	0	0	3	1	0	0	0	4
Special Case #1									0
Special Case #2									0
Special Case #3									0
Special Case #4									0
Special Case #5									0
Special Case #6									0
TOTAL	0	0	0	3	1	0	0	0	4
Sentinel Lights (Total)	2								

ASSET SUMMARY

Poles	30	35	40	45	50	55	Total	
	0	0	0	0	0	0	0	
Transformers	5	10	15	25	50	75	100	167
	0	0	0	3	1	0	0	0
Primary Wire (metres)	0							
Secondary O/H Wire (Metres)	100							
Secondary U/G Wire (Metres)	0							
Current Transformers	0							
Sentinel Lights	2							
Easements	0							

Attachment 5 – Oakville Hydro / Milton Hydro Asset LTLT Transfer
Summary

Summary of Assets To Be Sold

Wires					
Category				Total Asset Value	
Primary and Secondary Wires				\$	10,852
Secondary Bus				\$	360
Poles					
Quantity	Map Number	Height (Feet)	Age (Years)	Residual Value	Total Asset Value
3	A3B-Map2	30	25	\$ 526	\$ 1,578
1	A4-Map3	40	19	\$ 813	813
1	A5-Map1	30	42	\$ 168	168
2	A4-Map3&4	30	19	\$ 651	1,302
3	A4-Map3&4	30	65	\$ -	-
1	A4-Map3&4	40	32	\$ 470	470
1	A4-Map3&4	40	37	\$ 340	340
2	A4-Map3&4	40	27	\$ 603	1,206
3	A4-Map3&4	40	22	\$ 733	2,199
1	A4-Map3&4	40	8	\$ 1,097	1,097
1	A4-Map3&4	45	5	\$ 1,360	1,360
1	A4-Map3&4	50	5	\$ 1,505	1,505
Sub-total					\$ 12,038
Transformers					
Quantity	Map Number	Size (kVA)	Age (Years)	Residual Value	Total Asset Value
1	A3B-Map2	25	26	\$ 1,698	\$ 1,698
1	A3B-Map3	50	10	\$ 3,638	3,638
1	A4-Map1	25	34	\$ 608	608
1	A4-Map1	50	22	\$ 2,183	2,183
1	A4-Map1	150	15	\$ 8,629	8,629
1	A4-Map2	25	2	\$ 4,590	4,590
1	A4-Map2	25	35	\$ 506	506
1	A4-Map2	50	6	\$ 4,267	4,267
1	A4-Map2	2000	11	\$ 20,000	20,000
1	A4-Map3	25	38	\$ 203	203
1	A4-Map3	50	34	\$ 728	728
1	A4-Map4	50	8	\$ 3,952	3,952
1	A5-Map3	10	38	\$ 203	203
1	A5-Map3	50	37	\$ 364	364
1	A4-Map3&4	75	20	\$ 2,625	2,625
1	A4-Map3&4	100	10	\$ 3,075	3,075
Sub-total					\$ 57,269
Sentinel Lights					
1	A5-Map1			\$	100
1	A5-Map3				100
Sub-total				\$	200
Primary Metering					
1	A4-Map2			\$	23,500
Total Assets to be Sold				\$	104,219

Attachment 6 – Oakville Hydro Affected Customers (Section 1.4.5)

Oakville Hydro Affected Customers

Customer Number	Address	City	Postal Code	Rate Class
1	3364 Burnhamthorpe Road West	Oakville	L6M 4H3	Res
2	3388 Burnhamthorpe Road West	Oakville	L6M 4H3	Res
3	3406 Burnhamthorpe Road West	Oakville	L6M 4H3	Res
4	3414 Burnhamthorpe Road West	Oakville	L6M 4H3	Res
5	3466 BURNHAMPTHORPE RD W	Oakville	L6M 4H3	Res
6	3466 BURNHAMPTHORPE RD W	Oakville	L6M 4H3	GS < 50
7	3466 BURNHAMPTHORPE RD W	Oakville	L6M 4H3	microFIT
8	3326 BURNHAMPTHORPE RD W	Oakville	L6M 4H3	GS < 50
9	3328 Burnhamthorpe Road West	Oakville	L6M 4H3	Res
10	3328 Burnhamthorpe Road West	Oakville	L6M 4H3	GS < 50
11	3114 Burnhamthorpe Road West	Oakville	L6M 4H2	Res
12	3164 Burnhamthorpe Road West	Oakville	L6M 4H2	Res
13	4269 Bronte Road	Oakville	L6M 4E9	Res
14	4289 Bronte Road	Oakville	L6M 4E9	Res
15	4343 Bronte Road	Oakville	L6M 4E9	GS < 50
16	2410 Lower Baseline Road West	Oakville	L6M 4G1	GS < 50
17	4449 Bronte Road	Oakville	L6M 4E9	GS > 50
18	2400 Lower Base Line Road West	Oakville	L6M 4G1	Res
19	2410 Lower Base Line Road West	Oakville	L6M 4G1	GS < 50
20	2410 Lower Baseline Road West	Oakville	L6M 4G1	Res
21	2156 Lower Baseline Road West	Oakville	L6M 4G1	Res
22	2170 Lower Base Line Road West	Oakville	L6M 4G1	Res
23	2194 Lower Baseline Road West	Oakville	L6M 4G1	Res
24	1670 Lower Baseline Road West	Oakville	L6M 4E7	Res
25	2026 Lower Baseline Road West	Oakville	L6M 3H5	GS < 50
26	1470 Lower Baseline Road West	Oakville	L6M 4E7	Res
27	1470 Lower Baseline Road West	Oakville	L6M 4E8	Res
28	1556 Lower Baseline Road West	Oakville	L6M 4E7	Res
29	4268 Fourth Line	Oakville	L6M 4E8	Res
30	4278 Fourth Line	Oakville	L6M 4E8	Res
31	4278 Fourth Line	Oakville	L6M 4E8	GS < 50
32	4414 Fourth Line	Oakville	L6M 4E8	GS < 50
33	4414 Fourth Line	Oakville	L6M 4E8	GS < 50
34	4414 Fourth Line	Oakville	L6M 4E8	GS < 50

Attachment 7 – Milton Hydro / Oakville Hydro LTLT Elimination – Sample
Customer Letter

Milton Hydro / Oakville Hydro LTLT Elimination

You Will Soon Become a Customer of Oakville Hydro

Dear Valued Customer:

We are writing to let you know that you will soon be served by a new electricity distributor. While you are currently a customer of Milton Hydro and charged Milton Hydro distribution rates, your electricity is supplied by Oakville Hydro. In compliance with the Ontario Energy Board's ("OEB") Distribution System Code, Milton Hydro has requested approval from the OEB to transfer your account to Oakville Hydro. Pending approval, Oakville Hydro will become your electricity distributor. This change will take place in the next few months.

What Does This Means To You

We are making this change to serve you better. It is more cost-effective and efficient for you to have the same distributor deliver electricity to your home or business and provide you with customer service. For example, once approved by the OEB, if your power goes out, you would contact Oakville Hydro – the distributor that has control over when the power will be restored. Once this transfer is complete, Oakville Hydro will be responsible for delivering your electricity, reading your smart meter, issuing your monthly bills, and providing you with quality customer service.

Oakville Hydro will ensure the delivery of electricity to your home or business is not affected in any way, due to this transfer. As this transfer may result in a higher electricity delivery charge, the increase will be offset by a credit applied by Oakville Hydro on your bill, as long as you remain the account holder.

Oakville Hydro will contact you to let you know when the transfer is completed and should additional account information be required.

For more information, please visit the OEB's website at www.oeb.ca and select Industry (top of the page), choose Policy Initiatives & Consultations, Archived and complete policy initiatives and consultations, then select case number EB-2015-0006.

If you have any questions or concerns please do not hesitate to contact Debbie Ceelen at Milton Hydro at 905-876-4611 ext. 230 or Maryanne Wilson at Oakville Hydro at 905-825-4422.

Yours truly,

Milton Hydro Distribution Inc.

Oakville Hydro
Sample Customer Letter

NOTICE OF CHANGES TO YOUR ELECTRICITY DISTRIBUTOR

Dear Valued Customer:

We are writing to advise that, in approximately eight weeks, you will be billed by a new electricity distributor. Your residence (place of business) is on the border of Oakville and Milton. You are currently an Oakville Hydro customer paying Oakville Hydro rates and are serviced and billed by Oakville Hydro. However, your electricity is physically supplied by Milton Hydro.

To simplify the process and comply with the Ontario Energy Board's (OEB's) Distribution System Code for electricity distributors, we have requested approval from the OEB to transfer your account to Milton Hydro. Upon approval, Milton Hydro will be responsible for servicing and billing, in addition to supplying your electricity.

We are making this change to serve you better. In addition to offering one-stop servicing of your electricity needs, it is more cost-effective for you to have the same distributor deliver electricity to your home (business) and provide you with customer service. Once this transfer is complete, Oakville Hydro will be responsible for delivering your electricity, reading your meters, issuing your monthly bills, restoring power during outages and providing you with quality customer service.

This transfer will result in an estimated reduction in your electricity bill of approximately \$X.XX per month. Or (This change will not impact your electricity bill. As Oakville Hydro has a slightly higher delivery charge, the increase will be offset by a credit of \$XX.XX applied on your bill, as long as you remain the account holder).

If you have any questions or concerns please do not hesitate to contact Maryanne Wilson at Oakville Hydro at (905) 825-4422 or Debbie Ceelen at Milton Hydro at 905-876-4611 ext. 230.