

CATEGORY 1 MODIFICATIONS

To provide a sense of the magnitude of the access road changes in Category 1 of the letter, the following are side by side comparisons of several of the relatively more significant changes (which in our view are not material). Generally, the Category 1 changes had the effect of reducing the total length of access roads. The access roads as contemplated in the LTC are shown on the left and as now contemplated on the right. Knowing the transmission corridor is generally 40 m in width will give you a sense of scale.

Example 1

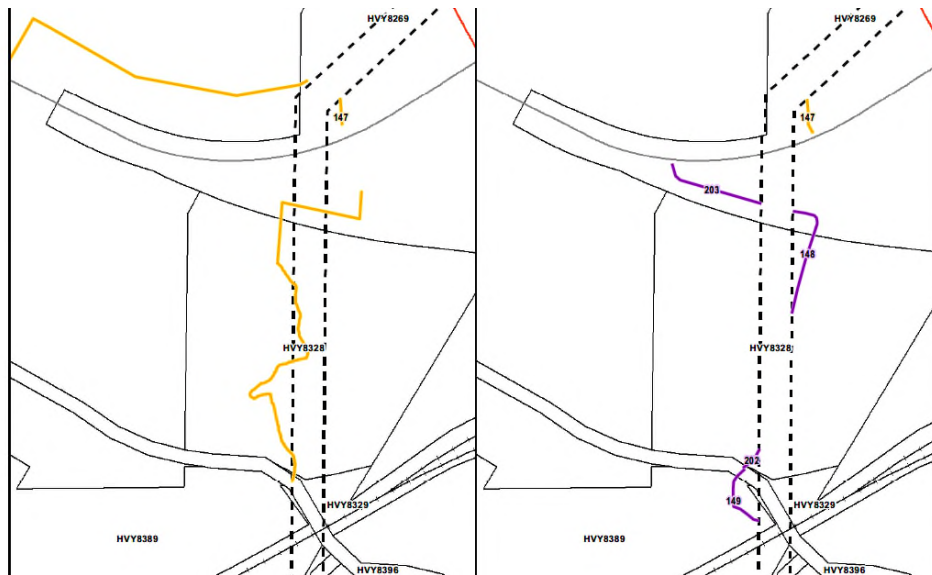

Example 2

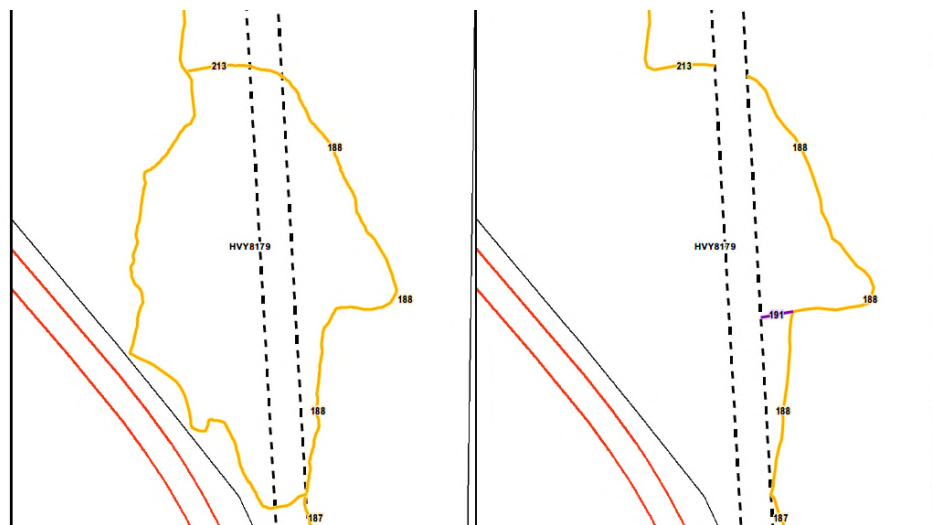

Example 3

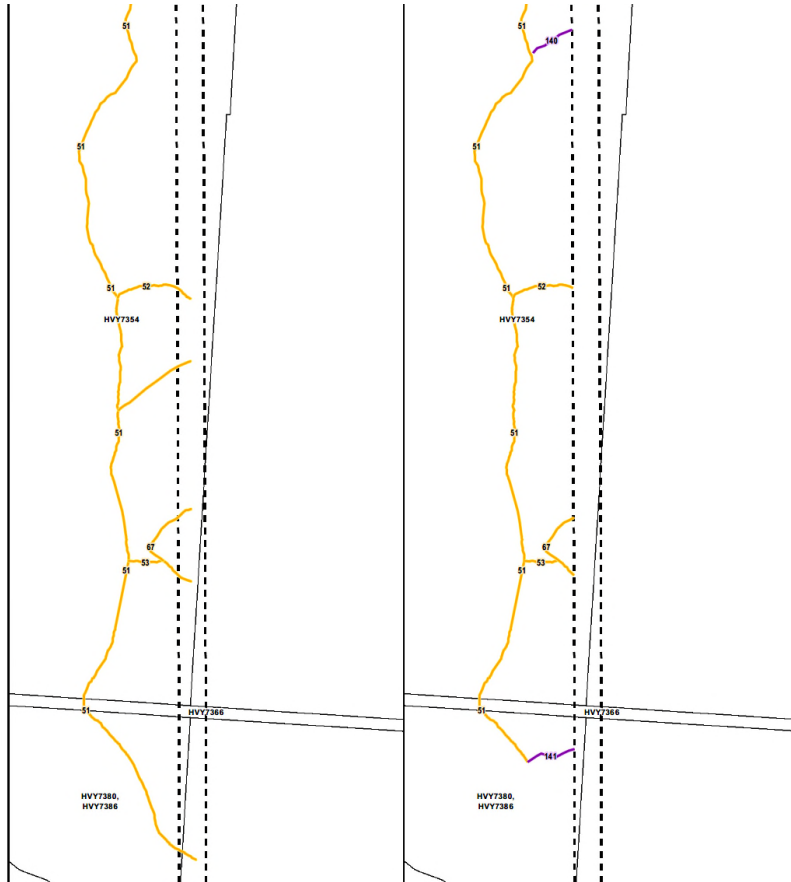

Example 4

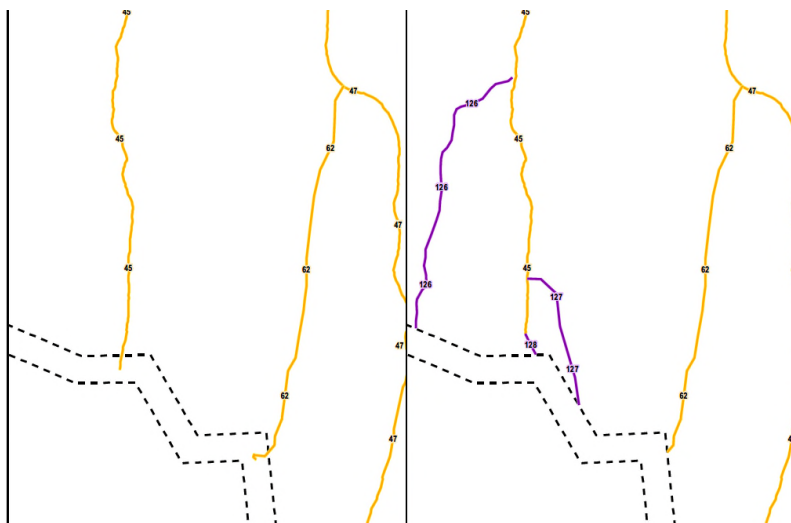

Example 5



CATEGORY 2 MODIFICATIONS

To provide a sense of the magnitude of the transmission line routing changes in Category 2 of the letter, the five most significant changes (other than relating to the Hull property, for which greater detail has already been provided), which in our view are not material, involve routing shifts of approx. 175m, 100m, 75m, 40m and 40m. All other changes appear to be less than 40m. The following are side by side comparisons of these five changes with the LTC version on the left and the modified version on the right. The modified portions of the transmission corridor are marked by a red outline (not to be confused with the other red lines showing highways).

175m

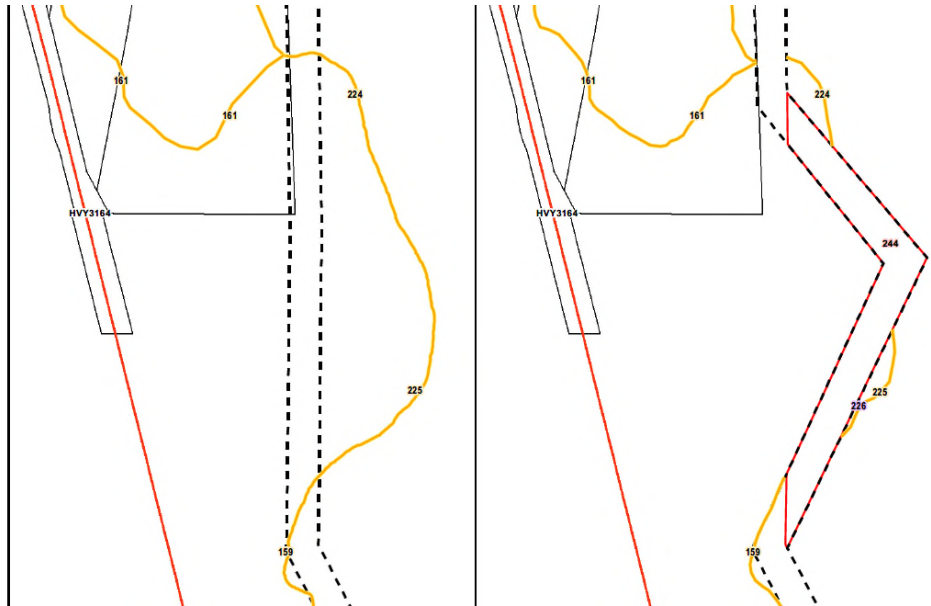

100m



75m

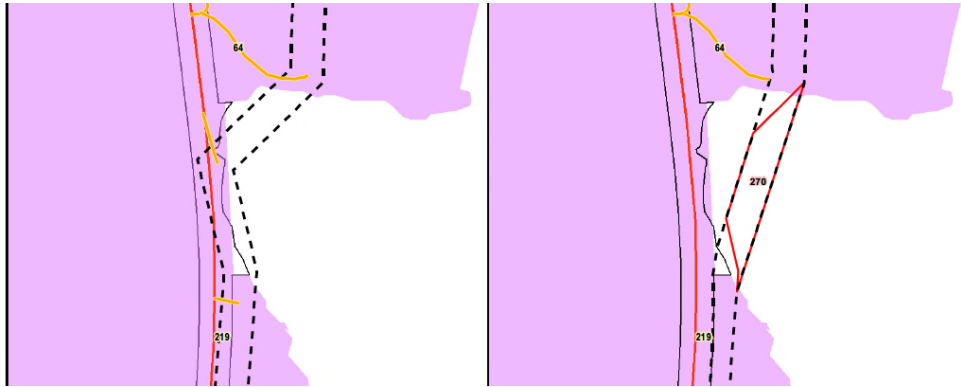

40m



40m

