

**Hydro One Networks Inc.**

7<sup>th</sup> Floor, South Tower  
483 Bay Street  
Toronto, Ontario M5G 2P5  
www.HydroOne.com

Tel: (416) 345-5393  
Fax: (416) 345-6833  
Joanne.Richardson@HydroOne.com



**Joanne Richardson**

Director – Major Projects and Partnerships  
Regulatory Affairs

BY COURIER

January 15, 2018

Ms. Kirsten Walli  
Board Secretary  
Ontario Energy Board  
Suite 2700, 2300 Yonge Street  
P.O. Box 2319  
Toronto, ON M4P 1E4

Dear Ms. Walli:

**Load Transfer Elimination Application – A Service Area Amendment & Asset Sale  
Application Between Hydro One Networks Inc. and Lakeland Power Distribution Ltd.**

In accordance with the Distribution System Code amendments of December 21, 2015, Hydro One Networks Inc. and Lakeland Power Distribution Ltd. are jointly applying to the Ontario Energy Board (“Board”) for approval to amend the service areas of both distributors such that existing load transfer arrangements between the two LDC’s are eliminated.

Should you have any question on this application, please contact Pasquale Catalano at (416) 345-5045 or via email at [Pasquale.Catalano@HydroOne.com](mailto:Pasquale.Catalano@HydroOne.com).

Sincerely,

ORIGINAL SIGNED BY JOANNE RICHARDSON

Joanne Richardson



# **Ontario Energy Board**

**Elimination of Load Transfer Arrangements  
Between  
Hydro One Networks Inc. and Lakeland  
Power Distribution Ltd.**

**Combined Service Area Amendment and Asset  
Transfer Application**

**January 15, 2019**

## **PART I: SERVICE AREA AMENDMENT**

### **1.1 Basic Facts**

As a result of the Distribution System Code amendments of December 21, 2015, EB-2015-0006, Hydro One Networks Inc. ("Hydro One") and Lakeland Hydro Inc. ("Lakeland") are jointly applying to the Ontario Energy Board ("OEB") for approval to amend the service areas of both distributors such that existing load transfer arrangements between the two LDCs are eliminated.

This application is being filed as a follow up to a previous application that was filed and approved by the OEB (EB-2017-0177). Since then, Hydro One and Lakeland have identified that there were additional customers that were not identified in the original application, and are jointly submitting this application to make the correction.

### **1.2 Identification of the Parties**

#### **1.2.1 Applicant**

(Identify whether the applicant is a geographic and/or physical distributor)

Name of Applicant Hydro One Networks Inc.	Licence Number ED-2003-0043
Address 483 Bay Street, 7 <sup>th</sup> Floor, South Tower Toronto, ON M5G 2P5	Telephone Number 416-345-5405
	Facsimile Number 416-345-5866
	E-mail Address Regulatory@Hydroone.com
Contact Person Pasquale Catalano Regulatory Advisor	Telephone Number As listed above.
	Facsimile Number As listed above.
	E-mail Address Pasquale.Catalano@HydroOne.com

#### **1.2.2 Co-Applicant or Other Distributor to the Service Area Amendment Application**

Name of Co-Applicant or Other Distributor Lakeland Hydro Inc.	Licence Number ED-2002-0540
Address: 200-395 Centre St. North Huntsville, ON P1H 2M2	Telephone Number 705-789-5442
	Facsimile Number 705-789-3110
	E-mail Address: belliott@lakelandpower.on.ca
Contact Person: Chris Litschko	Telephone Number 705-789-5442 ext224
	Facsimile Number 705-789-3110
	E-mail Address chris@lakelandholding.com

### 1.3 Description of Proposed Service Area

1.3.1

**Provide a detailed service area description of the area(s) that is subject to the SAA and how the amendments should be reflected in Schedule 1 of the licence(s) of the distributor(s).**

The proposed amendment is premise specific. The subjective premise (italicized below) will be removed from Hydro One's licensed area, and added to Lakeland's licensed service area.

Lakeland Hydro Distribution Licence (ED-2002-0540) should be amended as follows:

#### **SCHEDULE 1                      DEFINITION OF DISTRIBUTION SERVICE AREA**

1. In the former Town of Bracebridge as at April 1, 1999, the service area:
  - South West corner of Muskoka Concession 10 Lot 14 and goes East along Concession 10 to the South East corner of Muskoka Concession 10 Lot 1.
  - It then goes south along the border of Muskoka Lot 2, Concession 9 and Muskoka Lot 1, Concession 9 to the southwest corner of Muskoka Lot 1, Concession 8. It then turns easterly along the border of Muskoka Lot 1, Concession 7 and Muskoka Lot 1, Concession 8. It then follows an irregular line along the west and south edges of the registered properties known as 1181 and 1188 Campbell's Road, Gravenhurst to the border of Muskoka Lot 1, Concession 7 and Draper Lot A Concession 7 approximately 125m south of the Draper Lot 1, Concession 8 and Draper Lot A, Concession 7 border.
  - It then goes south along the Muskoka and Draper Concession Border to the South West Corner of Muskoka Concession 7 Lot 1. It continues East North East until it reaches the west corner of Draper Concession 7 Lot A. It continues South East to the South West Corner of Draper Concession 7 Lot A. It then continues East North East along Draper Concession 6 and Draper Concession 7 border to the corner of Draper Concession 7 Lot 4.
  - It then goes North North West to the North West corner of Draper Concession 12 Lot 5. It then follows the West side of Hwy 11 until 100m West of the corner of Macaulay Concession 2 Lot 7.
  - It then goes North North West to the North West corner of Draper Concession 12 Lot 5. It then follows the West side of Hwy 11 until 100m West of the corner of Macaulay Concession 2 Lot 7.
  - It then Continues East North East between Macaulay Concession 1 and Macaulay Concession 2 to the South West corner of Macaulay Concession 2 Lot 21.
  - Then it goes North North West to the North East corner of Macaulay Concession 5 Lot 21. It then goes West South West along the border of Macaulay Concession 6 and Macaulay Concession 5 to the East side of Hwy 11 and heads North North West along Hwy. 11 to 50m East of the corner of Macaulay Concession 7 Lot 8.
  - It then goes West South West along the border of Macaulay Concession 7 and Macaulay Concession 8 to the North West corner of Macaulay Concession 7 Lot 1. Three addresses within Concession 7 Lot 2 are excluded.
  - It then goes North North West to the corner of Monck Concession A Lot 13 and heads West South West to the North West corner of Monck Concession A Lot 13. It then goes South South West to the North East corner of Monck Concession 7 Lot 3.
  - It continues West South West to the North West corner of Monck Concession 7 Lot 4. It continues South South East to the North West corner of Monck Concession 6 Lot 4.
  - It continues West South West along the border of Monck Concession 7 and Monck Concession 6/5 to the North West Corner of Monck Concession 6 Lot 5. It then continues South South East to the North Edge of the property lines at Monck Concession 5 Lot 6. It follows the North Edge of the property lines to the South West.
  - It then heads South South East 800m into Lake Muskoka, then 2350m East South East in Lake Muskoka.
  - It then continues 2130m South East in Lake Muskoka and then goes South South West 1790m in Lake Muskoka, then goes South East 1090m in Lake Muskoka and then heads South 2800m in Lake Muskoka.

	<ul style="list-style-type: none"> <li>• It then heads East to the Shore of Muskoka Concession 9 Lot 14 then heads North North East to the South West Corner of Concession 10 Lot 14.</li> <li>• Includes Islands of Auburn Island, Ennis Island, Caisse Island, Sandspit Island, McVittie Island, Peninsula Island, Summer Island and Frank Island;</li> <li>• excluding customers at the following addresses: <ul style="list-style-type: none"> <li>i. 154 Beaumont Drive.</li> <li>ii. 1987 Manitoba St, Bracebridge, ON, P1L 1W9</li> <li>iii. 1981 Manitoba St, Bracebridge, ON, P1L 1W9</li> </ul> </li> <li>• Including customers at the following addresses: <ul style="list-style-type: none"> <li>i. 1007 Crawford Road, Bracebridge, ON</li> <li>ii. 1010 Crawford Road, Bracebridge, ON</li> <li>iii. 1025 Crawford Road, Bracebridge, ON</li> <li>iv. 1033 Crawford Road, Bracebridge, ON</li> <li>v. 1016 Partridge Lane, Bracebridge, ON</li> <li>vi. 1048 Partridge Lane, Bracebridge, ON</li> <li>vii. 1060 Partridge Lane, Bracebridge, ON</li> <li>viii. 1086 Partridge Lane, Bracebridge, ON</li> <li>ix. 1108 Partridge Lane, Bracebridge, ON</li> <li>x. 1122 Partridge Lane, Bracebridge, ON</li> <li>xi. 1004 Pearcey Lane, Bracebridge, ON</li> <li>xii. 1015 Pearcey Lane, Bracebridge, ON</li> <li>xiii. 1031 Pearcey Lane, Bracebridge, ON</li> <li>xiv. 1030 Boyd Bay Rd Road, Bracebridge, ON</li> <li>xv. 1038 Boyd Bay Rd Road, Bracebridge, ON</li> <li>xvi. 1040 Boyd Bay Rd Road, Bracebridge, ON</li> <li>xvii. 1044 Boyd Bay Rd Road, Bracebridge, ON</li> <li>xviii. 1046 Boyd Bay Rd Road, Bracebridge, ON</li> <li>xix. 1048 Boyd Bay Rd Road, Bracebridge, ON</li> <li>xx.</li> </ul> </li> </ul>
	2. The former Village of Sundridge as at July 3, 1963.
	3. The Village of Burk's Falls as at March 1, 1951 in the district of Parry Sound.
	4. The former town of Huntsville as of December 31, 1970: <ul style="list-style-type: none"> <li>• excluding the consumer located at 61 Domtar Road.</li> <li>• Including the customers (12) located at the following addresses: <ul style="list-style-type: none"> <li>i. 20 Dairy Lane, Huntsville, ON, P1H 1L4</li> </ul> </li> </ul>
	5. The former village of Magnetewan as of December 31, 1997, now in the Township of Magnetewan. <ul style="list-style-type: none"> <li>• Excluding the customers located at the following addresses: <ul style="list-style-type: none"> <li>i. 13 Billschwamm Rd, Magnetawan, ON, P0A 1P0</li> <li>ii. 289 Victoria St, Magnetawan, ON, P0A 1P0</li> <li>iii. 277 Victoria St, Magnetawan, ON, PO1 1Z0</li> </ul> </li> </ul>
	6. The Town of Parry Sound as of January 1, 1982. <ul style="list-style-type: none"> <li>• Excluding the customers located at the following addresses: <ul style="list-style-type: none"> <li>i. 65 Harris Drive, Parry Sound, ON, P2A 0C3</li> <li>ii. 78 Harris Drive, Parry Sound, ON, P2A 0C3</li> <li>iii. 21 Townview Trail, Parry Sound, ON, P2A 2X3</li> <li>iv. 19 Townview Trail, Parry Sound, ON, P2A 2X4</li> <li>v. 15 Townview Trail, Parry Sound, ON, P2A 2X2</li> <li>vi. 0 Oak Island, Parry Sound, ON</li> <li>vii. 25 South Channel Rd, Parry Sound, ON</li> <li>viii. 18 Deep Water Rd, Parry Sound, ON</li> <li>ix. 10 Deep Water Rd, Parry Sound, ON</li> </ul> </li> </ul>

	<ul style="list-style-type: none"> <li>x. 16 Deep Water Rd, Parry Sound, ON</li> <li>xi. 0 South Channel Rd, Parry Sound, ON</li> <li>xii. 27 South Channel Rd, Parry Sound, ON</li> <li>xiii. 13 South Channel Rd, Parry Sound, ON</li> <li>xiv. 5 South Channel Rd, Parry Sound, ON</li> <li>xv. 19 South Channel Rd, Parry Sound, ON</li> <li>xvi. 17 South Channel Rd, Parry Sound, ON</li> <li>xvii. 1180 Geewadin Rd, Parry Sound, ON</li> <li>xviii. 1175 Geewadin Rd, Parry Sound, ON</li> <li>xix. 1171 Geewadin Rd, Parry Sound, ON</li> <li>xx. 1179 Geewadin Rd, Parry Sound, ON</li> <li>xxi. 1183 Geewadin Rd, Parry Sound, ON</li> <li>xxii. 1187 Geewadin Rd, Parry Sound, ON</li> <li>xxiii. 1191 Geewadin Rd, Parry Sound, ON</li> <li>xxiv. 1167 Geewadin Rd, Parry Sound, ON</li> <li>xxv. 1207 Geewadin Rd, Parry Sound, ON</li> <li>xxvi. 1210 Geewadin Rd, Parry Sound, ON</li> <li>xxvii. 1195 Geewadin Rd, Parry Sound, ON</li> <li>xxviii. 1196 Geewadin Rd, Parry Sound, ON</li> <li>xxix. 1208 Geewadin Rd, Parry Sound, ON</li> <li>xxx. 1213 Geewadin Rd, Parry Sound, ON</li> <li>xxxi. 1221 Geewadin Rd, Parry Sound, ON</li> <li>xxxii. 1217 Geewadin Rd, Parry Sound, ON</li> <li>xxxiii. 1220 Geewadin Rd, Parry Sound, ON</li> </ul> <ul style="list-style-type: none"> <li>• Including the customers located at the following addresses <ul style="list-style-type: none"> <li>i. 5 HWY 69, Parry Sound, ON, P0G 1A0</li> <li>ii. Limbert's Island Premise One Parry Sound ON</li> <li>iii. Limbert's Island Premise Two Parry Sound ON</li> </ul> </li> </ul> <p>The following amendments to Hydro One's Distribution Licence, ED-2003-0043, are required:</p> <p><i>Remove from Schedule 1, Appendix B, Tab 1:</i></p> <p><b>Name of Municipality:</b> Township of McDougall  <b>Formerly Known As:</b> Township of McDougall, geographic/unorganized township of Ferguson, as at December 31, 1999.</p> <p><i>Add to Schedule 1, Appendix B, Tab 4:</i></p> <p><b>Name of Municipality:</b> Township of McDougall  <b>Formerly Known As:</b> Township of McDougall, geographic/unorganized township of Ferguson, as at December 31, 1999.  <b>Area Not Served by Networks:</b> The area served by Lakeland Hydro Inc. as set out in Licence ED-2002-0540  <b>Network assets within area not served by Networks:</b> Yes  <b>Customers(s) within area not served by Networks:</b> No</p>
1.3.2	<p><b>Provide maps or diagrams of the area(s) that is the subject of the SAA application.</b></p> <p>Please see Attachment 2.</p>
1.3.3	<p><b>Provide a description of the type of physical connection(s); i.e., individual customer; residential subdivision, commercial or industrial customer.</b></p> <p>There are three customers proposed to move from Hydro One to Lakeland.  1 residential customer  2 seasonal customers</p>

#### **1.4 Information on Affected Load Transfer Customers**

1.4.1	<b>Provide a total number of load transfer arrangements between distributors.</b>  Section 1.3.3 addresses the majority of existing load transfer arrangements between the two distributors. Given that Lakeland is an embedded LDC, there are some load transfer arrangements associated with that relationship that are not being addressed by this Application.
1.4.2	<b>Provide a number of load transfers eliminated in this application.</b>  Please see 1.3.3.
1.4.3	<b>Provide a number of customers to be transferred from Hydro One to Lakeland.</b>  Please see 1.3.3.
1.4.4	<b>Provide a number of customers to be transferred from Lakeland to Hydro One.</b>  There are no customers being transferred from Lakeland to Hydro One.
1.4.5	<b>Provide a list of affected load transfer customers. (Customer listing must include customer address, name, billing address, rate class and meter number)</b>  Please see Attachment 1.
1.4.6	<b>Provide written confirmation that all affected persons have been provided with specific and factual information about the service area amendment(s).</b>  A Letter informing the customer of the proposed amendments was sent to the customer on September 13th, 2018.

## 1.5 Impacts Arising from the Amendment(s)

1.5.1	<p><b>Use the table below to describe the impact on the average residential customers' total bill that arises as a result of the service area amendment(s) before and after rate mitigation is applied.</b>  <b>Use delivery charge on consumer's bill (including cost of losses and excluding all rate riders).</b>  <b>Use 750 kWh / month for the average residential consumer. Provide any additional information as required.</b></p> <p>Based on the approved distribution rates effective May 1, 2017, adjusted to reflect the Fair Hydro Plan, the delivery charge will decrease for typical year-round and seasonal residential customers moving from Hydro One to Lakeland. However, the delivery charge will increase for one particular residential customer moving from Hydro One Networks to Lakeland Power Distribution Ltd. Table 1 shows the delivery charge impacts for year-round and seasonal residential customers at typical consumption levels and Table 2 (in Section 1.5.5) provides the credit amount for the particular residential customer whose delivery charge will increase.</p> <p><b>Table 1: Bill Impacts at the Typical Consumption Level for Residential Customers Moving from Hydro One Networks (Rates effective January 1, 2017) to Lakeland Power Distribution Ltd. (Rate effective May 1, 2017)</b></p> <table border="1"> <thead> <tr> <th rowspan="2">Monthly Consumption (kWh)</th><th colspan="4">Hydro One Networks</th><th colspan="4">Lakeland Power Distribution Ltd.</th><th rowspan="2">Average Monthly Delivery Impact on Total Bill (\$)</th></tr> <tr> <th>Rate Class</th><th>Fixed Charge (\$)</th><th>Variable Charge (\$/kWh or \$/kW)</th><th>Delivery Charge (\$) **</th><th>Rate Class</th><th>Fixed Charge (\$)</th><th>Variable Charge (\$/kWh or \$/kW) *</th><th>Delivery Charge (\$) **</th></tr> </thead> <tbody> <tr> <td>750</td><td>R2</td><td>19.83</td><td>0.0374</td><td>52.47</td><td>RES</td><td>27.15</td><td>0.011</td><td>49.07</td><td>(3.40)</td></tr> <tr> <td>350</td><td>Seasonal</td><td>36.28</td><td>0.0635</td><td>65.88</td><td>RES</td><td>27.15</td><td>0.011</td><td>37.80</td><td>(28.08)</td></tr> </tbody> </table> <p>* Includes low voltage charge  **Includes RTSR charges, cost of losses and Fair Hydro Plan Distribution Rate Protection where applicable</p>	Monthly Consumption (kWh)	Hydro One Networks				Lakeland Power Distribution Ltd.				Average Monthly Delivery Impact on Total Bill (\$)	Rate Class	Fixed Charge (\$)	Variable Charge (\$/kWh or \$/kW)	Delivery Charge (\$) **	Rate Class	Fixed Charge (\$)	Variable Charge (\$/kWh or \$/kW) *	Delivery Charge (\$) **	750	R2	19.83	0.0374	52.47	RES	27.15	0.011	49.07	(3.40)	350	Seasonal	36.28	0.0635	65.88	RES	27.15	0.011	37.80	(28.08)
Monthly Consumption (kWh)	Hydro One Networks				Lakeland Power Distribution Ltd.				Average Monthly Delivery Impact on Total Bill (\$)																														
	Rate Class	Fixed Charge (\$)	Variable Charge (\$/kWh or \$/kW)	Delivery Charge (\$) **	Rate Class	Fixed Charge (\$)	Variable Charge (\$/kWh or \$/kW) *	Delivery Charge (\$) **																															
750	R2	19.83	0.0374	52.47	RES	27.15	0.011	49.07	(3.40)																														
350	Seasonal	36.28	0.0635	65.88	RES	27.15	0.011	37.80	(28.08)																														
1.5.2	<p><b>Provide a description of any assets which may be stranded or become redundant after completion of the service area amendment(s). Please explain why these assets could not be transferred to the physical distributor.</b></p> <p>No assets will be stranded as a result of this amendment.</p>																																						
1.5.3	<p><b>Identify costs for stranded equipment that would need to be de-energized or removed.</b></p> <p>This would not be applicable as there will not be any stranded assets in this case. See 1.5.2.</p>																																						
1.5.4	<p><b>Identify any assets that will be transferred to and/or from the applicant(s). If an asset transfer is required, please complete Part II of the application form.</b></p> <p>Please see Part 2 of this application for more details.</p>																																						



- 1.5.5 Include an estimate of the credit required for each customer to ensure there is not a negative impact on the total bill.

**Table 2: Credit Amounts to Eliminate the Increase in Delivery Charges for Applicable Customer Moving from Hydro One Networks (Rates effective January 1, 2017) to Lakeland Power Distribution Ltd. (Rates effective May 1, 2017)**

Index	Average Monthly Consumption (kWh)	Hydro One Networks		Lakeland Power Distribution Ltd.		Monthly Credit (\$)
		Rate Class	Delivery Charges (\$)	Rate Class	Delivery Charges (\$)	
Cust1	1,610.58	R2	69.98	RES	73.31	3.33

One customer moving from Hydro One to Lakeland will receive a monthly bill credit to offset the increase in delivery charge<sup>1</sup>. In accordance with the Ontario Energy Board's (OEB) direction provided in "Amendments to the Distribution System Code", the credit is calculated using the customer's average monthly consumption over the most recent 12 months at the time the application is filed for the OEB's approval. The credit will be fixed at this calculated level and remain in place as long as the customer remains the account holder.

The OEB has confirmed that a deferral account will be provided for the purpose of tracking the rate mitigation costs for future recovery.

<sup>1</sup> For the purpose of credit calculations, the delivery charge includes distribution charges, transmission charges and cost of losses, but excludes any rate riders as specified by the OEB in "[Amendments to the Distribution System Code](#),"

## **PART II:        TRANSFER OF ASSETS (S. 86(1)(b))**

### **2.1        Description of the Assets to Be Transferred**

2.1.1	<p><b>Provide a description of the assets that are the subject of the transaction. (Attach a detailed list of assets to be sold including value of assets)</b></p> <p>See Attachment 1 and Section 2.2.1 below.</p>
2.1.2	<p><b>Indicate where the assets are located – whether in the applicant’s service territory or in the recipient’s service territory (if applicable). Please include a map of the location.</b></p> <p>The assets are located within the territory that will be transferred from the geographical distributor to the physical distributor, if the application is approved. Please see Attachment 2 for a map indicating the location of the asset.</p>
2.1.3	<p><b>Indicate which distributor’s customers are currently served by the assets.</b></p> <p>Currently the assets are being used to service the geographical distributor’s customer. Once the application is approved, the assets will continue to service the same customer they currently service. The customer will be transferred from the geographical distributor to the physical distributor.</p>

### **2.2        Description of the Sale Transaction**

2.2.1	<p><b>The value of the assets to be transferred shall be determined based on net book value (NBV). Attach the details of the associated cash consideration to be given and received by each of the parties to the transaction.</b></p> <p>Hydro One will sell the assets servicing current Hydro One geographical customers to Lakeland (125 kVA transformer valued at \$5,381.00 and \$512.00 of conductor) for a total of \$5893.00 plus applicable taxes. A further breakdown of the special case assets is provided in Attachment 1.</p>
2.2.2	<p><b>Will the transfer impact any other parties (e.g. joint users of poles) including any agreements with third parties? If yes, please specify how.</b></p> <p>No.</p>

### **PART III: CERTIFICATION AND ACNOWLEDGEMENT**

#### **Applicant**

I certify that the information contained in this application and in the documents provided are true and accurate.

Signature of Key Individual	Name and Title of Key Individual	Date
ORIGINAL SIGNED BY JOANNE RICHARDSON	Joanne Richardson Director - Major Projects and Partnerships, Regulatory Affairs	January 15, 2019

(Must be signed by a key individual. A key individual is one that is responsible for executing the following functions for the applicant: matters related to regulatory requirements and conduct, financial matters and technical matters. These key individuals may include the chief executive officer, the chief financial officer, other officers, directors or proprietors.)

#### **Co-Applicant (if applicable)**

I certify that the information contained in this application and in the documents provided are true and accurate.

Signature of Key Individual	Name and Title of Key Individual	Date
ORIGINAL SIGNED BY VINCE KULCHYCKI	Vince Kulchycki	September 12, 2018

(Must be signed by a key individual. A key individual is one that is responsible for executing the following functions for the applicant: matters related to regulatory requirements and conduct, financial matters and technical matters. These key individuals may include the chief executive officer, the chief financial officer, other officers, directors or proprietors.)

## **Attachment 1**

### **Geographical Distributor (Hydro One) LTLT Customer and Asset Transfer Information**

[illegible]

**LOT 24, CONCESSION 3, McDOUGALL**

If many streets involved, provide names of all the streets.

## Summary of Assets to be Sold

Poles					
Quantity	Height	Age	Set	Residual Value	Total Asset Value
1	35	50	Earth Plus	\$0.00	\$0.00
			Earth Plus		\$0.00
			Earth Plus		\$0.00
			Earth Plus		\$0.00
			Earth Plus		\$0.00
			Earth Plus		\$0.00
			Earth Plus		\$0.00
<b>1</b>					<b>\$0.00</b>

Primary and Neutral - Wire					
Location	Line Length (m)	# of Phases	Total Length (m)	Price/metre	Total Asset Value
1016 Partridge to 1048 Partridge	170	1	170	\$1.25	\$212.50
			0	\$3.00	\$0.00
<b>Totals</b>	<b>170</b>		<b>170</b>		<b>\$212.50</b>

Buss - Wire			
Location	# of Spans	Price/span	Total Asset Value
		\$180.00	\$0.00
		\$180.00	\$0.00
		\$180.00	\$0.00
<b>Totals</b>	<b>0</b>		<b>\$0.00</b>

Secondary Services to Premise			
Figure #	# of Premises	Price/Premise	Total Asset Value
6	2	\$150.00	\$300.00
			\$0.00
			\$0.00
			\$0.00
			\$0.00
<b>Totals</b>			<b>\$300.00</b>

Transformers				
Quantity	Age	Size (KVA)	Residual Value	Total Asset Value
1	50	5	\$0.00	\$0.00
				\$0.00
				\$0.00
<b>1</b>				<b>\$0.00</b>

	Figure #1	Figure #2	Figure #3	Figure #4	Figure #5	Figure #6	Figure #7	Figure #8	Figure #9	Figure #10	Figure #11	Figure #12	Figure #13	Figure #14	Figure #15	Primary Wire Line
Main Page	0	0	0	0	0	0	0	0	0	0	0	0	0	0	0	
Special Case #1						3										847
Special Case #2		1				1							1			378.4
Special Case #3																
Special Case #4																
Special Case #5																
Special Case #6																
O/H	20	70	20	70		50		50		63		63				
U/G	63		63		63		63		63		63					
Primary								20	20				20		20	
Neutral								20	20				20		20	
Subtotal	0	1	0	0	0	4	0	0	0	0	0	0	1	0	0	1225.4
Total O/H	0	70	0	0	0	200	0	0	0	0	0	0	0	0	0	Total Secondary O/H (m) 270
Total U/G	0	0	0	0	0	0	0	0	0	0	0	0	0	0	0	Total Secondary U/G (m) 0
Total Primary	0	0	0	0	0	0	0	0	0	0	0	0	40	0	0	Total Primary (m) 1265.4
Toal Buss (m)	0															

POLES	30	35	40	45	50	55	Total
Main Page	0	2	0	0	0	0	2
Special Case #1			4				4
Special Case #2		1	3				4
Special Case #3							0
Special Case #4							0
Special Case #5							0
Special Case #6							0
TOTAL	0	3	7	0	0	0	10

Transformers	5	10	15	25	50	75	100	167	Total
Main Page	0	0	0	9	1	0	1	0	11
Special Case #1									0
Special Case #2									0
Special Case #3									0
Special Case #4									0
Special Case #5									0
Special Case #6									0
TOTAL	0	0	0	9	1	0	1	0	11
Sentinel Lights (Total)	0								

#### ASSET SUMMARY

Poles	30	35	40	45	50	55	Total		
	0	3	7	0	0	0	10		
Transformers	5	10	15	25	50	75	100	167	Total
	0	0	0	9	1	0	1	0	11
Primary Wire (metres)	1265.4								
Secondary O/H Wire (Metres)	270								
Secondary U/G Wire (Metres)	0								
Current Transformers	3								
Sentinel Lights	0								
Easements	0								

## **Attachment 2**

### **Geographical Distributor (Hydro One) LDC Maps**



**Hydro One Geographical LDC Maps for LTLT Elimination with**

**Lakeland Hydro as Physical LDC**

**Maps Legend**

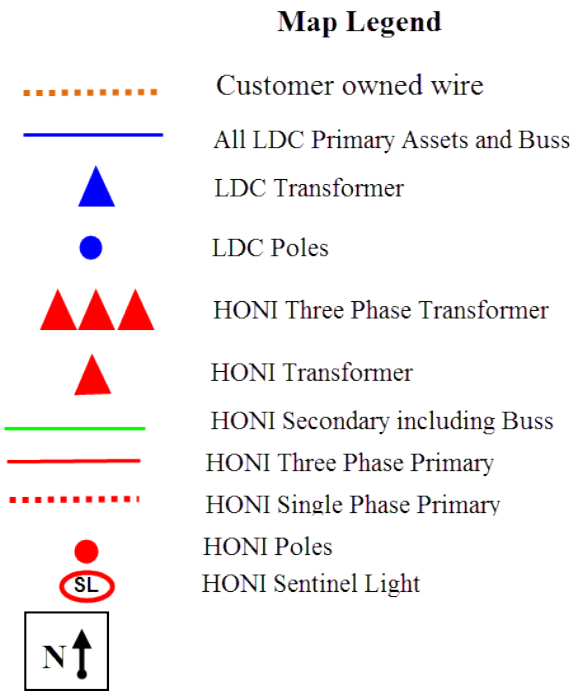

**MAPS**

Map #1 -

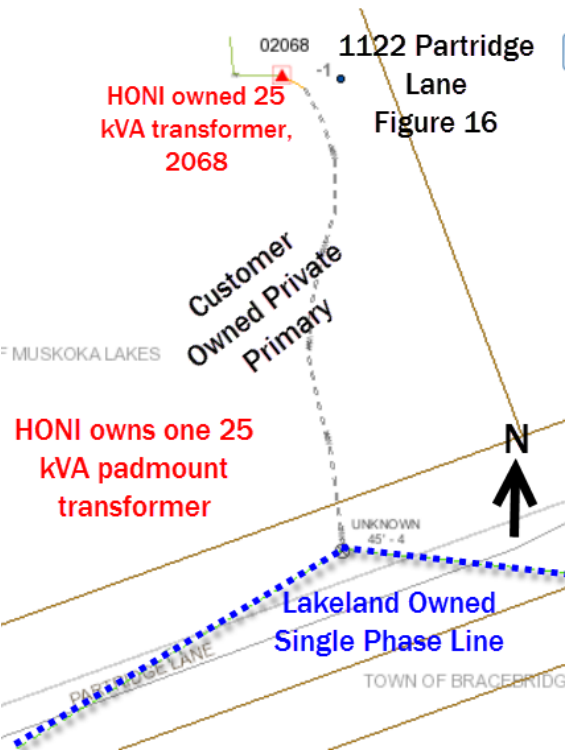

## Map #2

